

State Geological Survey

WICHITA BRANCH
KANSAS DRILLERS LOG

IMPORTANT
Kans. Geo. Survey request
samples on this well.

15-047-20257

API No. 15 — 047 — 20,257
County Number

S. 34 T. 25 R. 19 ^R W
Loc. NE NW
County Edwards

Operator
Sterling Drilling & K-N

Address
P. O. Box 129 Sterling, Kansas 67579

Well No. #1 Lease Name Moletor

Footage Location
660' feet from (N) SS line 660' feet from (E) 20257 line

Principal Contractor Sterling Drilling Company Geologist Wayne Lebsack

Spud Date November 21, 1977 Total Depth 4900' P.B.T.D.

Date Completed November 29, 1977 Oil Purchaser Dry Hole

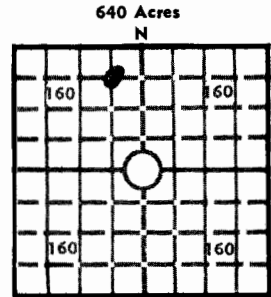

Elev.: Gr. 2217'
DF _____ KB 2226'

CASING RECORD

Report of all strings set — surface, intermediate, production, etc.

Purpose of string	Size hole drilled	Size casing set (in O.D.)	Weight lbs/ft.	Setting depth	Type cement	Sacks	Type and percent additives
Surface	12 1/4"	8 5/8"	23#	292' KB	60/40 Pozmix	250	3% cc

LINER RECORD

PERFORATION RECORD

Top, ft.	Bottom, ft.	Sacks cement	Shots per ft.	Size & type	Depth interval

TUBING RECORD

Size	Setting depth	Packer set at

ACID, FRACTURE, SHOT, CEMENT SQUEEZE RECORD

Amount and kind of material used	Depth interval treated

INITIAL PRODUCTION

Date of first production Dry Hole Producing method (flowing, pumping, gas lift, etc.)

RATE OF PRODUCTION PER 24 HOURS	Oil	Gas	Water	Gas-oil ratio
	bbls.	MCF	bbls.	CFPB

Disposition of gas (vented, used on lease or sold) _____ Producing interval (s) _____

INSTRUCTIONS: As provided in KCC Rule 82-2-125, within 90 days after completion of a well, one completed copy of this Drillers Log shall be transmitted to the State Geological Survey of Kansas, 4150 Monroe Street, Wichita, Kansas 67209. Copies of this form are available from the Conservation Division, State Corporation Commission, 3830 So. Meridian (P.O. Box 17027), Wichita, Kansas 66217. Phone AC 316-522-2206. If confidential custody is desired, please note Rule 82-2-125. Drillers Logs will be on open file in the Oil and Gas Division, State Geological Survey of Kansas, Lawrence, Kansas 66044.

Operator Sterling Drilling Company DESIGNATE TYPE OF COMP.: OIL, GAS, DRY HOLE, SWDW, ETC.: Dry Hole

Well No. #1 Lease Name Moletor

S 34 T 25S R 19W ~~E~~ W

WELL LOG
 Show all important zones of porosity and contents thereof; cored intervals, and all drill-stem tests, including depth interval tested, cushion used, time tool open, flowing and shut-in pressures, and recoveries. SHOW GEOLOGICAL MARKERS, LOGS RUN, OR OTHER DESCRIPTIVE INFORMATION.

FORMATION DESCRIPTION, CONTENTS, ETC.	TOP	BOTTOM	NAME	DEPTH
DST #1: Tools were open 20 min; closed 40 min; open 60 min; closed 90 min. Gas surfaced in nine (9) min. and gauged 65.3 MCF/D throughout both flow periods. Recovery was 134' of slightly oil and gas cut mud, 248' of muddy water and 248' of water. Flow pressures: 59/137# and 118/245#. ICIP 1486#; FCIP - 1467#.	4720'	4750'	Gas detector Schlumberger Dual Induction R/A and Compensated Density	

USE ADDITIONAL SHEETS, IF NECESSARY, TO COMPLETE WELL RECORD.

Date Received	STERLING DRILLING COMPANY
	<i>F. A. Wuelner</i> Signature
	F. A. Wuelner, Secretary Title
	May 9, 1978 Date