

STATE CORPORATION COMMISSION OF KANSAS
OIL & GAS CONSERVATION DIVISION

WELL COMPLETION OR RECOMPLETION FORM
ACO-1 WELL HISTORY

DESCRIPTION OF WELL AND LEASE

Operator: license # 9421
name Boger Brothers Drilling Inc.
address Box 723
City/State/Zip Great Bend, KS 67530

Operator Contact Person Dale Smith
Phone 316-792-8155

Contractor: license # 9421
name Boger Brothers Drilling Inc.

Wellsite Geologist James Musgrove
Phone 316-792-7716

Designate Type of Completion
 New Well Re-Entry Workover
 Oil SWD Temp Abd
 Gas Inj Delayed Comp.
 Dry Other (Core, Water Supply etc.)

If FO: old well info as follows:
Operator
Well Name
Comp. Date Old Total Depth

WELL HISTORY

Drilling Method: Mud Rotary Air Rotary Cable
6-25-88 7-3-88 7-3-88
Spud Date Date Reached TD Completion Date

4800'
Total Depth PBSD

Amount of Surface Pipe Set and Cemented at 476 feet

Multiple Stage Cementing Collar Used? Yes No

If Yes, Show Depth Set feet

If alternate 2 completion, cement circulated from feet depth to SX cmt

JUL 27 1988

API NO. 15-057-204,52

County Ford

SE NE Sec 11 Twp 25S Rge 21W W West

3300 Ft North from Southeast Corner of Section
660 Ft West from Southeast Corner of Section
(Note: locate well in section plat below)

Lease Name Stegman "J" Well# 1

Field Name

Producing Formation D. & A

Elevation: Ground 2295' KB 2300'

AUG 11 1988

KANSAS GEOLOGICAL SURVEY
WICHITA BRANCH

RECEIVED

AUG - 8 1988

CONSERVATION DIVISION
Wichita, Kansas

Section Plat

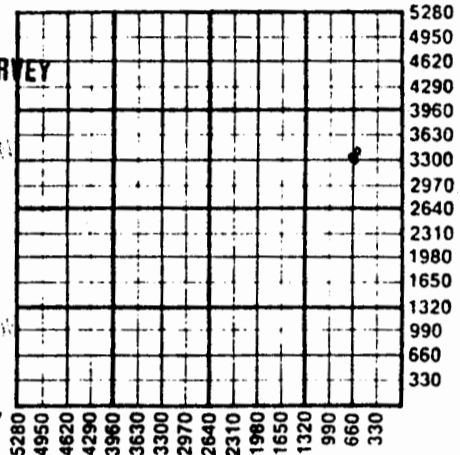

WATER SUPPLY INFORMATION

Source of Water:
Division of Water Resources Permit # T88-351

Groundwater... 3300... Ft North From Southeast Corner and
(Well) 660... Ft. West From Southeast Corner of
Sec 11 Twp 25S Rge 21W East West

Surface Water... Ft North From Southeast Corner and
(Stream, Pond etc.)... Ft West From Southeast Corner
Sec Twp Rge East West

Other (explain) (purchased from city, R.W.D.#)

Disposition of Produced Water: None Disposal Repressuring

Docket #

INSTRUCTIONS: This form shall be completed in duplicate and filed with the Kansas Corporation Commission, 200 Colorado Derby Building, Wichita, Kansas 67202, within 90 days after completion of any well. Rules 82-3-130 and 82-3-107 apply.

Information on side two of this form will be held confidential for a period of 12 months if requested in writing and submitted with the form. See rule 82-3-107 for confidentiality in excess of 12 months.

One copy of all wireline logs and drillers time log shall be attached with this form. Submit CP-4 form with all plugged wells. Submit CP-111 form with all temporarily abandoned wells.

All requirements of the statutes, rules, and regulations promulgated to regulate the oil and gas industry have been fully complied with and the statements herein are complete and correct to the best of my knowledge.

Signature Dale L. Smith
Title Drilling Superintendent Date 7-25-88

Subscribed and sworn to before me this 25th day of July 1988

Notary Public Wendy L. Brackeen
Notary Commission Expires 7-23-89

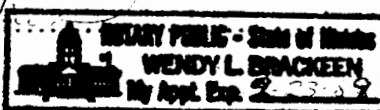

K.C.C. OFFICE USE ONLY
F Letter of Confidentiality Attached
C Wireline Log Received
C Drillers Timelog Received
Distribution
 KCC SWD/Rep NGPA
 KGS Plug Other (Specify)

Form ACO-1
(This form supercedes previous forms ACO-1 & C-10)

Sec. 11 Twp. 25S Rge. 21W

WELL LOG

INSTRUCTIONS: Show important tops and base of formations penetrated. Detail all cores. Report all drill stem tests giving interval tested, time tool open and closed, flowing and shut-in pressures, whether shut-in pressure reached static level, hydrostatic pressures, bottom hole temperature, fluid recovery, and flow rates if gas to surface during test. Attach extra sheet if more space is needed. Attach copy of log.

Drill Stem Tests Taken Yes No
 Samples Sent to Geological Survey Yes No
 Cores Taken Yes No

Formation Description
 Log Sample

DST #1 - Tested 4136-4166'. 45-45-45-45"
 Blow weak to fair. Recovered 255' water.
 Pressures: ISIP 1077, FSIP 1052, IFP 58-101,
 FFP 134-151, HSH 2052-2036.

DST #2 - Tested 4648-4701'. Open 15 minutes.
 Blow very weak for 15 minutes. Recovered 10'
 mud. Pressures: ISIP 42, FSIP none, IFP
 42-42, FFP none, HSH 2320-2304 psi.

Name	Top	Bottom
Arhydrite	1424	+876
Heebner	4005	-1705
Toronto	4021	-1721
Brown Lime	4108	-1808
Lansing	4121	-1821
Base Kansas City	4457	---
Cherokee Shale	4636	-2336
Mississippian	4732	-2432
RTD	4800	-2500

CASING RECORD <input checked="" type="checkbox"/> new <input type="checkbox"/> used							
Report all strings set - conductor, surface, intermediate, production, etc.							
Purpose of string	size hole drilled	size casing set (In O.D.)	weight lbs/ft.	setting depth	type of cement	# sacks used	type and percent additives
Surface		8 5/8"	20#	476'	60-40poz	200	2% gel, 3% c.c.

PERFORATION RECORD		Acid, Fracture, Shot, Cement Squeeze Record	
shots per foot	specify footage of each interval perforated	(amount and kind of material used)	Depth

TUBING RECORD	size	set at	packer at	Liner Run <input type="checkbox"/> Yes <input type="checkbox"/> No
----------------------	------	--------	-----------	--

Date of First Production	Producing method <input type="checkbox"/> flowing <input type="checkbox"/> pumping <input type="checkbox"/> gas lift <input type="checkbox"/> Other (explain)
--------------------------	---

Estimated Production Per 24 Hours	Oil	Gas	Water	Gas-Oil Ratio	Gravity
	D & A Bbls	MCF	Bbls	CFPB	

Disposition of gas: vented sold used on lease

METHOD OF COMPLETION open hole perforation other (specify)

PRODUCTION INTERVAL Dually Completed. Commingled