

KANSAS

State Geological Survey

P1

WELL COMPLETION REPORT AND DRILLER'S LOG WICHITA BRANCH

S. 23 T. 25 R. 21 E

API No. 15 — 057 — 20,221  
County Number

Loc. C NE NW

County Ford

Operator  
Dunne-Gardner Petroleum, Inc.

Address  
Suite 250, 200 West Douglas, Wichita, Kansas 67202

Well No. #1 Lease Name  
Hubbell & Hubbell Inc.

Footage Location  
660 feet from (N) (S) line 660 feet from (E) (W) line

Principal Contractor Geologist  
Dunne-Gardner Rig #2 Sherry Heathman

Spud Date Date Completed Total Depth P.B.T.D.  
June 20, 1981 July 4, 1981 4796LTD/4800 RTD

Directional Deviation Oil and/or Gas Purchaser

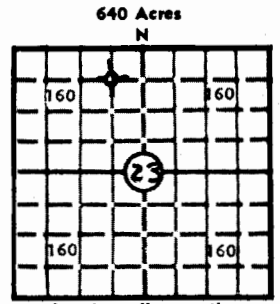

Locate well correctly  
Elev.: Gr. 2307

DF 2318 KB 2320

CASING RECORD

Report of all strings set — surface, intermediate, production, etc.

Purpose of string	Size hole drilled	Size casing set (in O.D.)	Weight lbs/ft.	Setting depth	Type cement	Sacks	Type and percent additives
Surface		8-5/8"		335'		250	

LINER RECORD

PERFORATION RECORD

Top, ft.	Bottom, ft.	Sacks cement	Shots per ft.	Size & type	Depth interval
None			None		

TUBING RECORD

Size	Setting depth	Packer set at
None		

ACID, FRACTURE, SHOT, CEMENT SQUEEZE RECORD

Amount and kind of material used	Depth interval treated
None	

INITIAL PRODUCTION

Date of first production None	Producing method (flowing, pumping, gas lift, etc.)
RATE OF PRODUCTION PER 24 HOURS	Oil Gas Water Gas-oil ratio
	bbls. MCF bbls. CFPB
Disposition of gas (vented, used on lease or sold)	Producing interval (s)

INSTRUCTIONS: As provided in KCC Rule 82-2-125, within 90 days after completion of a well, one completed copy of this Drillers Log shall be transmitted to the State Geological Survey of Kansas, 4150 Monroe Street, Wichita, Kansas 67209. Copies of this form are available from the Conservation Division, State Corporation Commission, 245 No. Water, Wichita, Kansas 67202. Phone AC 316-522-2206. If confidential custody is desired, please note Rule 82-2-125. Drillers Logs will be on an open file in the Oil and Gas Division, State Geological Survey of Kansas, Lawrence, Kansas 66044.

Operator Dunne-Gardner Petroleum, Inc. DESIGNATE TYPE OF COMP.: OIL, GAS, DRY HOLE, SWDW, ETC.: Dry Hole

Well No. #1 Lease Name Hubbell & Hubbell, Inc.

S 23 T 25 R 21 (W)

**WELL LOG**

Show all important zones of porosity and contents thereof; cored intervals, and all drill-stem tests, including depth interval tested, cushion used, time tool open, flowing and shut-in pressures, and recoveries.

SHOW GEOLOGICAL MARKERS, LOGS RUN, OR OTHER DESCRIPTIVE INFORMATION.

FORMATION DESCRIPTION, CONTENTS, ETC.	TOP	BOTTOM	NAME	DEPTH
<u>LOG TOPS</u>				
Stone Corral	1412	(+908)		
Heebner	4009	(-1689)		
Brown Limestone	4112	(-1792)		
Lansing	4122	(-1802)		
Base Kansas City	4508	(-2188)		
Fort Scott	4628	(-2308)		
Cherokee	4644	(-2324)		
Mississippian	----	(-----)		
Warsaw	4738	(-2418)		
Osage	4756	(-2436)		
Total Depth	4796	(-2476)		
<u>DST'S</u>				
DST #1	4668 - 4708			
	30-60-60-60			
	Rec 135' S O & G C M			
	FP 103 - 103/114 - 114			
	SIP 887 - 572			
	HP 2312 - 2300			
	BHT 107 <sup>o</sup>			
DST #2	4742 - 4750			
	Misrun			
DST #3	4715 - 4750			
	30-60-60-60			
	Rec 135' S O C M W			
	(7% oil, 54% water)			
	60' M W			
	FP 114 - 137/206 - 252			
	SIP 1475 - 1497			
	HP 2334 - 2323			
	BHT 123 <sup>o</sup>			

USE ADDITIONAL SHEETS, IF NECESSARY, TO COMPLETE WELL RECORD.

Date Received

Sherry L. Heathman  
 Signature  
 Geologist  
 Title  
August 3, 1981  
 Date