

**IMPORTANT**  
 Kans. Geo. Survey request  
 samples on this well.

15-055-20346

API No. 15 — 055 — 20,346  
County Number

S. 36 T. 25 R. 31 <sup>E</sup>/<sub>W</sub>

Loc. C NW

County Finney

Operator  
Alfred D. McKelvy

Address  
48 Lloyd Drive Atherton, Cal. 94025

Well No. #36 Lease Name Corley # 4/6

Footage Location  
feet from (N) (S) line \_\_\_\_\_ feet from (E) (W) line \_\_\_\_\_

Principal Contractor B&N DRILLING COMPANY Geologist RAYMOND PALMER

Spud Date 1/12/79 Total Depth 2720 P.B.T.D. 2720

Date Completed STILL COMPLETING Oil Purchaser \_\_\_\_\_

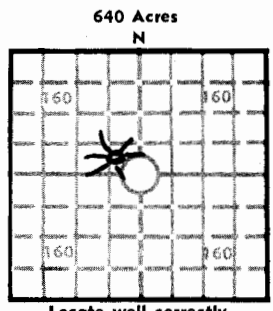

Locate well correctly  
Elev.: Gr. 2806

DF \_\_\_\_\_ KB 2811

**CASING RECORD**

Report of all strings set — surface, intermediate, production, etc.

Purpose of string	Size hole drilled	Size casing set (in O.D.)	Weight lbs/ft.	Setting depth	Type cement	Sacks	Type and percent additives
SURFACE	12½	7 7/8	20#	373	CLASS "H"	225	3% CALC
PRODUCTION	7 7/8	5½	14#	2720	65/35+"H"	500+150	D29

**LINER RECORD**

**PERFORATION RECORD**

Top, ft.	Bottom, ft.	Sacks cement	Shots per ft.	Size & type	Depth interval
			2 PER	JET	2646-2656

**TUBING RECORD**

Size	Setting depth	Packer set at
1½"	2700	

**ACID, FRACTURE, SHOT, CEMENT SQUEEZE RECORD**

Amount and kind of material used	Depth interval treated
ACIDIZE 15%HCL(500g) w/F40 w/M38	2646-2656
ACID FRAC 28%HCL(6,000g) w/F40 w/M38	2646-2656
MSR TREAT MSR-100(10,000g) W/A200 50BBL FLUSH	2646-2656

**INITIAL PRODUCTION**

Date of first production TESTING Producing method (flowing, pumping, gas lift, etc.) \_\_\_\_\_

RATE OF PRODUCTION PER 24 HOURS	Oil	Gas	Water	Gas-oil ratio
	bbls.	MCF	bbls.	CFPB

Disposition of gas (vented, used on lease or sold) \_\_\_\_\_ Producing interval (s) \_\_\_\_\_

INSTRUCTIONS: As provided in KCC Rule 82-2-125, within 90 days after completion of a well, one completed copy of this Drillers Log shall be transmitted to the State Geological Survey of Kansas, 4150 Monroe Street, Wichita, Kansas 67209. Copies of this form are available from the Conservation Division, State Corporation Commission, 3830 So. Meridian (P.O. Box 17027), Wichita, Kansas 66217. Phone AC 316-522-2206. If confidential custody is desired, please note Rule 82-2-125. Drillers Logs will be on open file in the Oil and Gas Division, State Geological Survey of Kansas, Lawrence, Kansas 66044.

Operator

McKELVY OIL COMPANY

DESIGNATE TYPE OF COMP.: OIL, GAS,  
DRY HOLE, SWDW, ETC.:

GAS

Well No. 36	Lease Name CORLEY
----------------	----------------------

S 16 T 25 R 31 E W

## WELL LOG

Show all important zones of porosity and contents thereof; cored intervals, and all drill-stem tests, including depth interval tested, cushion used, time tool open, flowing and shut-in pressures, and recoveries.

SHOW GEOLOGICAL MARKERS, LOGS RUN,  
OR OTHER DESCRIPTIVE INFORMATION.

FORMATION DESCRIPTION, CONTENTS, ETC.

TOP

BOTTOM

NAME

DEPTH

DOLO CRM/TAN FXLM TRC FGH, HD 2610 2626 HERRINGTON

CRM/GRY, MTL D, FGN/FXLN SCTR D  
BRTL/SEMIVIT 2644 2660 KRIDERDOLO GRYGRN GFN FXLN HD  
BRTL POOR P.P Ø N.S. 2703 TD WINFIELD

USE ADDITIONAL SHEETS, IF NECESSARY, TO COMPLETE WELL RECORD.

Date Received

*Robert D. H. H. H.*  
Signature

EXPLORATION

Title

APRIL 9, 1979

Date