

WELL COMPLETION REPORT AND DRILLER'S LOG

State Geological Survey

API No. 15 — 055 — 20,466 WICHITA BRANCH  
County Number

S. 21 T. 25S R. 34 W  
Loc. SW/4  
County Finney

Operator  
Mobil Oil Corporation

Address  
P. O. Box 5444 Denver, Co. 80217

Well No. 25 Lease Name Brown No. 24

Footage Location  
1800 feet from (N) (S) line 2530 feet from (E) (W) line

Principal Contractor Wakefield Drilling Geologist V. C. Andresen

Spud Date 5/7/81 Date Completed 6/2/81 Total Depth 2950' P.B.T.D. 2935'

Directional Deviation 3/4° @ 794'; 1/2° @ 1300'; 3/4° Oil and/or Gas Purchaser Northern Natural Gas

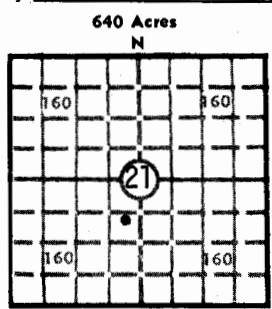

Locate well correctly  
Elev.: Gr. 2954  
DF KB 2962

CASING RECORD  
@ 1971'; 3/4° @ 2521'; 1-1/4° @ 2950'

Report of all strings set — surface, intermediate, production, etc.

Purpose of string	Size hole drilled	Size casing set (in O.D.)	Weight lbs/ft.	Setting depth	Type cement	Sacks	Type and percent additives
Surface casing	12-1/4"	8-5/8"	24#	794'	Class H Class H Reg	150 150	12% Gel + 3% CaCl <sub>2</sub> 3% CaCl <sub>2</sub>
Prod. casing	7-7/8"	5-1/2"	14#	2950'	Lite Class H reg	500 150	1/4#/sk Flocele 18% NaCl + .75% CFR-2

LINER RECORD

PERFORATION RECORD

Top, ft.	Bottom, ft.	Sacks cement	Shots per ft.	Size & type	Depth interval
			3	III 1078.31	2769-2773
			3	III 1078.31	2778-2780
Size 2-3/8"	Setting depth 2818'	Packer set at			2787-2794

ACID, FRACTURE, SHOT, CEMENT SQUEEZE RECORD

Amount and kind of material used	Depth interval treated
2500 gals. MOD 202 acid + additives + 60 ball sealers	2769-2794
41,000 gals. fresh gelled water + 78,000# 20-40 frac sand + additives	

INITIAL PRODUCTION

Date of first production Awaiting connections Producing method (flowing, pumping, gas lift, etc.) Pumping

RATE OF PRODUCTION PER 24 HOURS  
Oil Gas Water Gas-oil ratio  
bbls. N/A 7/13/81 MCF bbbs. CFPB

Disposition of gas (vented, used on lease or sold) Awaiting connections Producing interval(s) 2769-2794

INSTRUCTIONS: As provided in KCC Rule 82-2-125, within 90 days after completion of a well, one completed copy of this Drillers Log shall be transmitted to the State Geological Survey of Kansas, 4150 Monroe Street, Wichita, Kansas 67209. Copies of this form are available from the Conservation Division, State Corporation Commission, 245 No. Water, Wichita, Kansas 67202. Phone AC 316-522-2206. If confidential custody is desired, please note Rule 82-2-125. Drillers Logs will be on open file in the Oil and Gas Division, State Geological Survey of Kansas, Lawrence, Kansas 66044.

Operator Mobil Oil Corporation DESIGNATE TYPE OF COMP.: OIL, GAS, DRY HOLE, SWDW, ETC.: Gas

Well No. 25 Lease Name Brown No. 24

s 21 T 25S R 34 <sup>K</sup> W

**WELL LOG**

Show all important zones of porosity and contents thereof; cored intervals, and all drill-stem tests, including depth interval tested, cushion used, time tool open, flowing and shut-in pressures, and recoveries.

SHOW GEOLOGICAL MARKERS, LOGS RUN, OR OTHER DESCRIPTIVE INFORMATION.

FORMATION DESCRIPTION, CONTENTS, ETC.	TOP	BOTTOM	NAME	DEPTH
Sand	0	200	Stone Corral	1758
Sand, clay, blue shale	200	750	Chase	2442
Red Bed	750	1080	Council Grove	2747
Red bed & gyp	1080	1420		
Sand	1420	1525		
Shale & gyp	1525	1775		
Anhydrite & shale w/lime streaks	1775	2025		
Shale	2026	2295		
Shale & lime	2295	2950		
R.T.D.		2950		

USE ADDITIONAL SHEETS, IF NECESSARY, TO COMPLETE WELL RECORD.

Date Received

*C. J. Park*  
 C. J. Park Signature  
 Producing Accounting Supervisor Title  
 7-13-81 Date