

## KANSAS DRILLERS LOG

State Geological Survey

S. 7 T. 25S R. 37 <sup>E</sup>WAPI No. 15 — 093 — 20, WICHITA, BRANCH  
County Number 233Loc. 1250' FEL & 2590' FNLCounty Kearny

Operator <b>Amoco Production Company</b>		
Address <b>P. O. Box 432 - Liberal, Kansas 67901</b>		
Well No. <b>2</b>	Lease Name <b>Harbaugh Gas Unit</b>	
Footage Location <b>2590</b> feet from (N) (S) line <b>1250</b> feet from (E) (W) line		
Principal Contractor <b>Service Drilling Company</b>		Geologist
Spud Date <b>11-22-75</b>	Total Depth <b>2840</b>	P.B.T.D. <b>2840</b>
Date Completed <b>12-23-75</b>	Oil Purchaser	

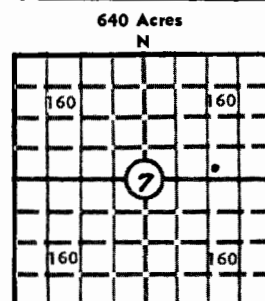

Locate well correctly

Elev.: Gr. 3080'DF \_\_\_\_\_ KB 3087'

## CASING RECORD

Report of all strings set — surface, intermediate, production, etc.

Purpose of string	Size hole drilled	Size casing set (in O.D.)	Weight lbs/ft.	Setting depth	Type cement	Sacks	Type and percent additives
Surface	12-1/4	8-5/8	24.00	556	Class "H"	400	3% CACL
Production	7-7/8	5-9/16	15.50	2840	Special	800	10% CACL

## LINER RECORD

## PERFORATION RECORD

Top, ft.	Bottom, ft.	Sacks cement	Shots per ft.	Size & type	Depth interval
			2	1/2	2635-45, 2654-58
					2662-70, 2673-79
					2688-95, 2703-13
					2723-32

## TUBING RECORD

Size	Setting depth	Packer set at
2-3/8	2709	

## ACID, FRACTURE, SHOT, CEMENT SQUEEZE RECORD

Amount and kind of material used	Depth interval treated
Acidized with 2500 gals. 15% HCL. Fraced with 100,000 gals. treated water and 200,000# river sand.	2635 - 2732'

## INITIAL PRODUCTION

Date of first production <b>12-23-75</b>	Producing method (flowing, pumping, gas lift, etc.) <b>Flowing</b>			
RATE OF PRODUCTION PER 24 HOURS	Oil bbls.	Gas <b>3,800</b> MCF	Water bbls.	Gas-oil ratio CFPB
Disposition of gas (vented, used on lease or sold) <b>Waiting on pipeline connection</b>			Producing interval (s) <b>2635 - 2732'</b>	

INSTRUCTIONS: As provided in KCC Rule 82-2-125, within 90 days after completion of a well, one completed copy of this Drillers Log shall be transmitted to the State Geological Survey of Kansas, 4150 Monroe Street, Wichita, Kansas 67209. Copies of this form are available from the Conservation Division, State Corporation Commission, 3830 So. Meridian (P.O. Box 17027), Wichita, Kansas 66217. Phone AC 316-522-2206. If confidential custody is desired, please note Rule 82-2-125. Drillers Logs will be on open file in the Oil and Gas Division, State Geological Survey of Kansas, Lawrence, Kansas 66044.

Operator <b>Amoco Production Company</b>		DESIGNATE TYPE OF COMP.: OIL, GAS, DRY HOLE, SWDW, ETC.: <b>Gas</b>
Well No. <b>2</b>	Lease Name <b>Harbaugh Gas Unit</b>	
S <b>7</b> T <b>25</b> R <b>37</b> W		

WELL LOG			SHOW GEOLOGICAL MARKERS, LOGS RUN, OR OTHER DESCRIPTIVE INFORMATION.	
Show all important zones of porosity and contents thereof; cored intervals, and all drill-stem tests, including depth interval tested, cushion used, time tool open, flowing and shut-in pressures, and recoveries.				
FORMATION DESCRIPTION, CONTENTS, ETC.	TOP	BOTTOM	NAME	DEPTH
Rocks, Sand, Gyp.	0	167		
Sand, Gyp., Red Bed	167	556		
Red Bed, Lime, Sand	556	756		
Red Bed, Sand	756	1140		
Sand, Gyp.	1140	1615		
Lime, Shale	1615	1908		
Shale, Lime	1908	2840		
TD	2840			
USE ADDITIONAL SHEETS, IF NECESSARY, TO COMPLETE WELL RECORD.				

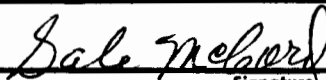
Date Received	 Signature	Gale McCord
	Administrative Assistant	
	Title	
	1-20-76	
Date		