

State Geological Survey
WICHITA, BRANCH

KANSAS DRILLERS LOG

API No. 15 — 093 — 20,231
County Number

S. 15 T. 25S R. 37 ^E/_W
Loc. 1250' FEL & 1250' FSL

County Kearny

Operator
Amoco Production Company

Address
P. O. Box 432 - Liberal, Kansas 67901

Well No. 2 Lease Name **Waechter Gas Unit "M"**

Footage Location
1250 feet from (S) line 1250 feet from (E) line

Principal Contractor **Service Drilling Company** Geologist

Spud Date 10-13-75 Total Depth 2928 P.B.T.D. 2744

Date Completed 11-17-75 Oil Purchaser

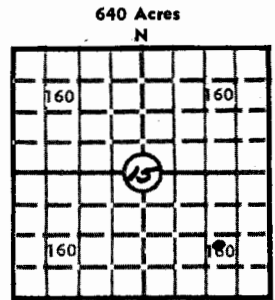

Locate well correctly
Elev.: Gr. 3055'

DF KB 3062'

CASING RECORD

Report of all strings set — surface, intermediate, production, etc.

Purpose of string	Size hole drilled	Size casing set (in O.D.)	Weight lbs/ft.	Setting depth	Type cement	Sacks	Type and percent additives
Surface	12-1/4	8-5/8"	28.55 24.00	566	Class "H"	400	3% CACL
Production	7-7/8	5-1/2 5-9/16	14.00 14.62	2928	Special	800	10% CACL

LINER RECORD

PERFORATION RECORD

Top, ft.	Bottom, ft.	Sacks cement	Shots per ft.	Size & type	Depth interval
			2	1/2	2647-66, 2675-82
TUBING RECORD					2697-06, 2711-19
					2730-40, 2752-55
Size	Setting depth	Packer set at			2758-63, 2766-68
2-3/8"	2697'				2777-80, 2787-04
ACID, FRACTURE, SHOT, CEMENT SQUEEZE RECORD					2839-54

Amount and kind of material used

Depth interval treated

Acidized with 1900 gals. 15% HCL and Squeezed with 150 sacks of cement to 3000#.	2777 - 2854'
Acidized with 600 gals. 15% HCL and Squeezed with 100 sacks of cement to 3000#.	2752 - 2768'
Acidized with 2100 gals. 15% HCL and Fraced with 100,000 gals. treated water and 200,000# river sand	2647 - 2740'

INITIAL PRODUCTION

Date of first production 11-17-75 Producing method (flowing, pumping, gas lift, etc.) **Flowing**

RATE OF PRODUCTION PER 24 HOURS	Oil	Gas	Water	Gas-oil ratio
	bbls.	5,100 MCF	bbls.	CFPB

Disposition of gas (vented, used on lease or sold) **Waiting on pipeline connection** Producing interval (s) **2647 - 2740'**

INSTRUCTIONS: As provided in KCC Rule 82-2-125, within 90 days after completion of a well, one completed copy of this Drillers Log shall be transmitted to the State Geological Survey of Kansas, 4150 Monroe Street, Wichita, Kansas 67209. Copies of this form are available from the Conservation Division, State Corporation Commission, 3830 So. Meridian (P.O. Box 17027), Wichita, Kansas 66217. Phone AC 316-522-2206. If confidential custody is desired, please note Rule 82-2-125. Drillers Logs will be on open file in the Oil and Gas Division, State Geological Survey of Kansas, Lawrence, Kansas 66044.

Operator **Amoco Production Company** DESIGNATE TYPE OF COMP.: OIL, GAS, DRY HOLE, SWDW, ETC.: **Gas**

Well No. **2** Lease Name **Waechter Gas Unit "M"**

S 15 T 25S R 37 ^R/_W

WELL LOG

Show all important zones of porosity and contents thereof; cored intervals, and all drill-stem tests, including depth interval tested, cushion used, time tool open, flowing and shut-in pressures, and recoveries.

SHOW GEOLOGICAL MARKERS, LOGS RUN, OR OTHER DESCRIPTIVE INFORMATION.

FORMATION DESCRIPTION, CONTENTS, ETC.	TOP	BOTTOM	NAME	DEPTH
Sand, Rock	0	330	Gamma-Neutron	1400 - 2926'
Red Bed	330	567		
Red Bed, Sand	567	1215		
Lime, Shale	1215	1515		
Lime, Shale	1515	1735		
Shale, Lime	1735	2928		
TD	2928			

USE ADDITIONAL SHEETS, IF NECESSARY, TO COMPLETE WELL RECORD.

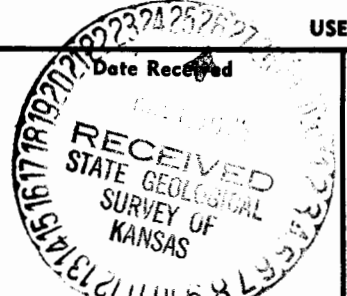

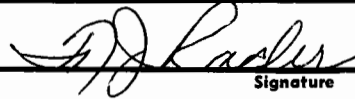
 Signature **F. J. Rader**
 Administrative Assistant
 Title
 11-18-75
 Date

15-25-37w

FORMATION RECORD

DESCRIBE EACH FORMATION DRILLED. INDICATE THICKNESS, CONTENT AND WHETHER DRY, OR OIL, GAS, OR WATER BEARING.

FORMATION	TOP	BOTTOM	FORMATION	TOP	BOTTOM
Sand, Rock	0	330			
Red Bed	330	567			
Red Bed, Sand	567	1215			
, Shale	1215	1735			
Shale, Lime	1735	2928			
TD	2928				