

KANSAS DRILLERS LOG

S. 27 T. 25 R. 39 ^K/_W
 Loc. 1320' FNL x 1320' FEL
 County Hamilton

API No. 15 — 075 — 20267
 County Number

Operator
Amoco Production Company

Address
P. O. Box 432, Liberal, Kansas 67901

Well No. 2 Lease Name R. M. Englert G. U.

Footage Location
1320 feet from (N) line 1320 feet from (E) line

Principal Contractor Service Drilling Co. Geologist _____

Spud Date 3-17-79 Total Depth 2700 P.B.T.D. 2700

Date Completed 5-2-79 Oil Purchaser _____

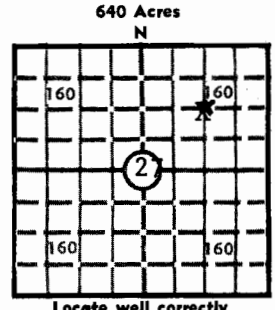

Locate well correctly
 Elev.: Gr. 3324'
 DF _____ KB _____

CASING RECORD

Report of all strings set — surface, intermediate, production, etc.

Purpose of string	Size hole drilled	Size casing set (in O.D.)	Weight lbs/ft.	Setting depth	Type cement	Sacks	Type and percent additives
Surface	12 1/4"	8 5/8"	24#	637'	65/35 POZ MIX	250	6% gel 2% cc 1/4# D-29
					Class H	150	3% CC
Production	7 7/8"	5 1/2"	14#	2699'	65/35 POZMIX	400	6% Gel 1/4# D-29
					50/50 POZMIX	150	2% Gel 10% Salt

LINER RECORD

PERFORATION RECORD

Top, ft.	Bottom, ft.	Sacks cement	Shots per ft.	Size & type	Depth interval
			2	.5 Jet	2488-99'
TUBING RECORD					2540-52'
					2563-68'

ACID, FRACTURE, SHOT, CEMENT SQUEEZE RECORD

Amount and kind of material used	Depth interval treated
ACD W/1500 Gal 15% HCL. FRAC W/60,000 Gal TRT. WT x 120,000#	2488-2568'
River Sand	

INITIAL PRODUCTION

Date of first production 5-2-79 Producing method (flowing, pumping, gas lift, etc.) Flowing

RATE OF PRODUCTION PER 24 HOURS	Oil	Gas	Water	Gas-oil ratio
	bbis.	1200	MCF	bbis. CFPB

Disposition of gas (vented, used on lease or sold) WO Pipeline connection Producing interval (s) 2488-2568

INSTRUCTIONS: As provided in KCC Rule 82-2-125, within 90 days after completion of a well, one completed copy of this Drillers Log shall be transmitted to the State Geological Survey of Kansas, 4150 Monroe Street, Wichita, Kansas 67209. Copies of this form are available from the Conservation Division, State Corporation Commission, 3830 So. Meridian (P.O. Box 17027), Wichita, Kansas 66217. Phone AC 316-522-2206. If confidential custody is desired, please note Rule 82-2-125. Drillers Logs will be on open file in the Oil and Gas Division, State Geological Survey of Kansas, Lawrence, Kansas 66044.

Operator Amoco Production Company DESIGNATE TYPE OF COMP.: OIL, GAS, DRY HOLE, SWDW, ETC.: Gas

Well No. 2 Lease Name R. M. Englert

S 27 T 25 R 39 ~~X~~ W

WELL LOG

Show all important zones of porosity and contents thereof; cored intervals, and all drill-stem tests, including depth interval tested, cushion used, time tool open, flowing and shut-in pressures, and recoveries. SHOW GEOLOGICAL MARKERS, LOGS RUN, OR OTHER DESCRIPTIVE INFORMATION.

FORMATION DESCRIPTION, CONTENTS, ETC.	TOP	BOTTOM	NAME	DEPTH
Surface Sand	0	525		
Redbed	525	1410		
Sand, Shale	1410	1745		
Shale, Sand	1745	2367		
Shale, Lime	2367	2565		
Lime	2565	2700		
Total Depth		2700		

USE ADDITIONAL SHEETS, IF NECESSARY, TO COMPLETE WELL RECORD.

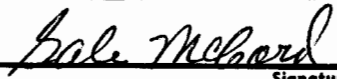
Date Received	<div style="display: flex; justify-content: space-between; align-items: center;"> <div style="text-align: center;">  <small>Signature</small> </div> <div style="text-align: right;"> Gale McCord </div> </div> <hr/> <div style="display: flex; justify-content: space-between; align-items: center;"> <div style="text-align: center;"> Administrative Supervisor <small>Title</small> </div> </div> <hr/> <div style="display: flex; justify-content: space-between; align-items: center;"> <div style="text-align: center;"> May 7, 1979 <small>Date</small> </div> </div>
---------------	--