

KANSAS

WELL COMPLETION REPORT AND DRILLER'S LOG

State Geological Survey WICHITA BRANCH

S. 17 T. 26 R. 11 W

Loc. SE NE SW

API No. 15 - 15 - 20,945 County Number

County Pratt

Operator J. A. Allison Address 300 W. Douglas, Suite 305 Wichita, Kansas 67202

Well No. #1 Lease Name Jorns

Footage Location 16500 feet from (M) (S) line 2310 feet from (K) (W) line

Principal Contractor Big Kat Drilling Geologist Allen S. Munroe

Spud Date 6/22/81 Date Completed 7/6/81 Total Depth 4475' P.B.T.D. 3961'

Directional Deviation Oil and/or Gas Purchaser Clear Creek

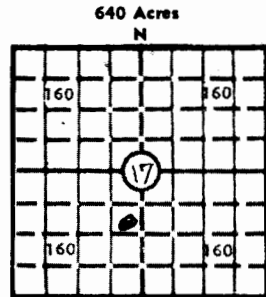

Locate well correctly

Elev.: Gr. 1858

DF 1860 KB 1863

CASING RECORD

Report of all strings set — surface, intermediate, production, etc.

Table with 8 columns: Purpose of string, Size hole drilled, Size casing set (in O.D.), Weight lbs/ft., Setting depth, Type cement, Sacks, Type and percent additives. Rows include Surface and Prod. String.

LINER RECORD

PERFORATION RECORD

Tables for Liner and Tubing records. Liner record columns: Top, ft., Bottom, ft., Sacks cement, Shots per ft., Size & type, Depth interval. Tubing record columns: Size, Setting depth, Packer set at.

ACID, FRACTURE, SHOT, CEMENT SQUEEZE RECORD

Table with 2 columns: Amount and kind of material used, Depth interval treated. Row: 250g MCA 1000g 15% HCLNE, 3938-42'

INITIAL PRODUCTION

Table with 4 columns: Date of first production, Producing method, RATE OF PRODUCTION PER 24 HOURS (Oil, Gas, Water), Gas-oil ratio, Disposition of gas, Producing interval (s).

INSTRUCTIONS: As provided in KCC Rule 82-2-125, within 90 days after completion of a well, one completed copy of this Drillers Log shall be transmitted to the State Geological Survey of Kansas, 4150 Monroe Street, Wichita, Kansas 67209.

operator J. A. Allison		DESIGNATE TYPE OF COMP.: OIL, GAS, DRY HOLE, SWDW, ETC.:
Well No. #1	Lease Name Jorns	Oil Well
S 17 T 26 R 11 ³⁴ W		

WELL LOG

Show all important zones of porosity and contents thereof; cored intervals, and all drill-stem tests, including depth interval tested, cushion used, time tool open, flowing and shut-in pressures, and recoveries.

SHOW GEOLOGICAL MARKERS, LOGS RUN, OR OTHER DESCRIPTIVE INFORMATION.

FORMATION DESCRIPTION, CONTENTS, ETC.	TOP	BOTTOM	NAME	DEPTH
<u>DST #1</u> , cop 30, si 45; op 60, si 45, rec. 60' slightly oil and gas cut mud, 180' heavy oil gas cut mud, 60' watery oil cut mud, 180' water. IFP 68-136, FFP 150-232; ISIP 1715, FSIP 1227. Temperature 110°.	3632	3665	Heebner Toronto Douglas Sh. Douglas Sd. Brown Lime Lansing	3443 (-1580) 3462 (-1599) 3483 (-1620) 3527 (-1664) 3630 (-1767) 3646 (-1783)
<u>DST #2</u> , op 30, si 45; op 60, si 45; IFP 40-40, FFP 40-40; ISIP 68, FSIP 68, rec. 30' oil specked mud. Temperature 110°.	3672	3695	Base Kansas Mississippian Kinderhook Sh Viola	3990 (-2127) 4076 (-2213) 4175 (-2312) 4278 (-2412)
<u>DST #3</u> , op 30, si 45; op 60, si 45; IFP 54-68, FFP 68-95; ISIP 1308, FSIP 1254 - recovered 180' muddy water	3695	3730	Simpson Sh. Simpson Sd. Arbuckle	4274 (-2511) 4392 (-2529) 4452 (-2589)
<u>DST #4</u> , op 30, si 45; op 60, si 45; IFP 54-163, FFP 191-341; ISIP 1347, FSIP 1306 - recovered 720' water.	3748	3786		
<u>DST #5</u> , op 30, si 45; op 30, si 45; IFP 54-54, FFP 68-68; ISIP 218, FSIP 95, recovered 65' mud - weak initial open, died 2nd open.	3804	3820		
<u>DST #6</u> , op 30, si 45; op 60, si 45; IFP 61-61, FFP 86-86, ISIP 1408, FSIP 1408-recovered 185' gas cut mud.	3820	3865		
<u>DST #7</u> , op 30, si 45; op 60, si 45; IFP 68-81, FFP 95-109; ISIP 1403, FSIP 1349 - recovered 1980' Gas In Pipe, 270' Heavy Oil and Gas Cut Mud, 30' water.	3924	3955		
<u>DST #8</u> , op 30, si 45; op 60, si 45; recovered 75' Gas Cut Mud, IFP 81-81, FFP 95-95; ISIP 232, FSIP 232.	4058	4133		

USE ADDITIONAL SHEETS, IF NECESSARY, TO COMPLETE WELL RECORD.

Date Received	 J. A. ALLISON OPERATOR Title December 23, 1981 Date
---------------	---