



RUPE OIL COMPANY, INC.

P.O. BOX 2273 • 3101 OHIO, WICHITA, KANSAS 67201 • (316) 262-3718

BRITTON PROSPECT - W/2 of Section 4;
 All of Section 5;
 All of Section 8; and
 NW/4 of Section 9 all in

TOWNSHIP 26 South RANGE 18 West COUNTY Edwards STATE Kansas = 1760 Acres

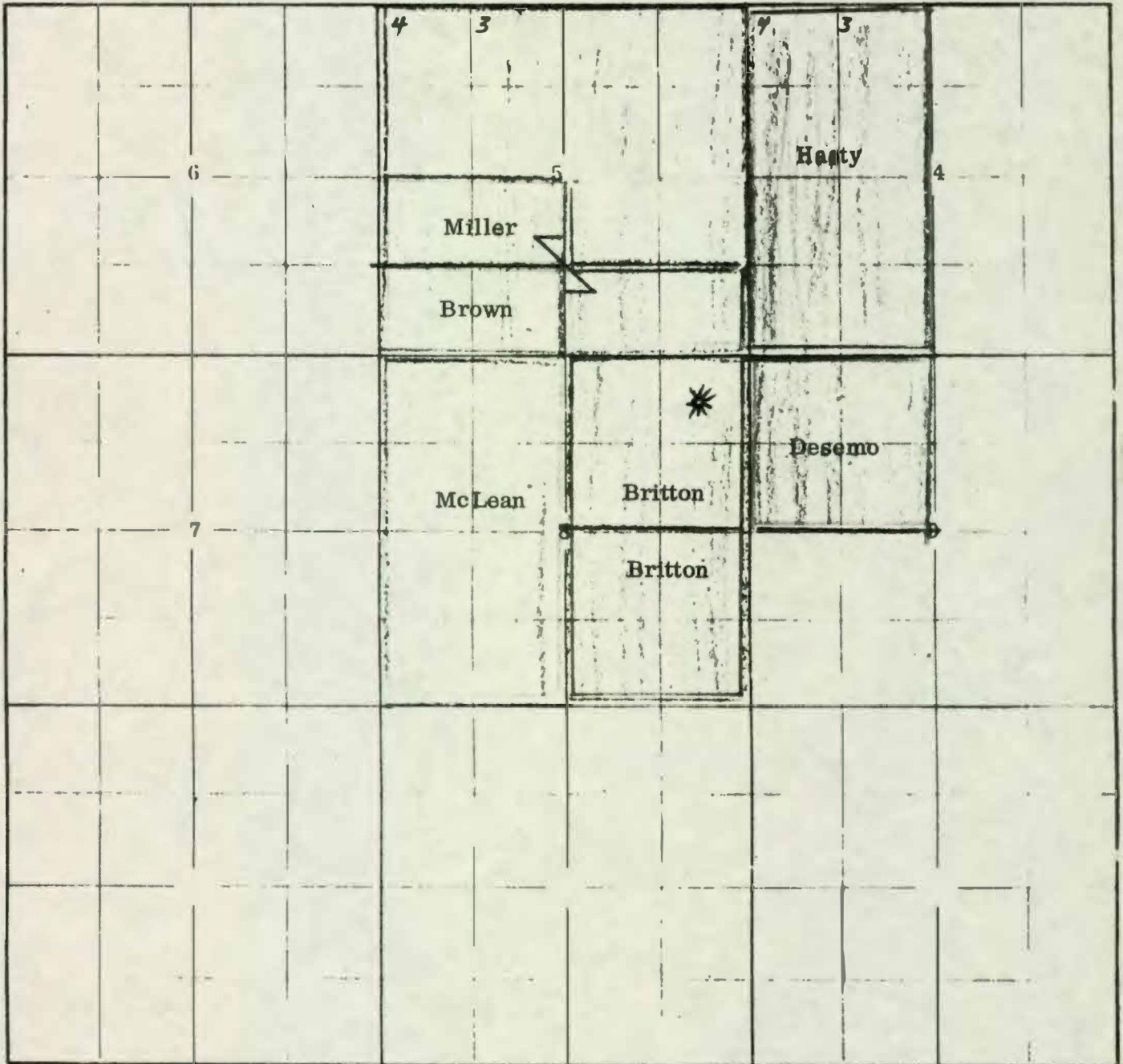

EXHIBIT "A"

BRITTON PROSPECT

BRITTON "Gas Unit" - Unitized 1/7/77			Acres	Acres	Expires
#803 - David Britton	NE/4	8-26S-18W	160		1/11/77
#817 - Gale Britton	SE/4	8-26S-18W	160		1/11/77
#816 - Lloyd Miller	N/2 SW/4 & S/2 SE/4	5-26S-18W		320	1/23/79
#1112- Leroy Brown	S/2 SW/4	5-26S-18W		80	12/21/81
#1113--Robert McLean	W/2	8-26S-18W		320	12/23/79
#1114 - Joe Desemo	NW/4	9-26S-18W		160	12/13/79
#1117 - Joyce Hasty	Lt. 3,4;S/2 NW/4 & SW/4	4-26S-18W		417	12/17/81

1457

BRITTON PROSPECT - W/2 of Section 4;
 All of Section 5;
 All of Section 8; and
 NW/4 of Section 9 all in

TOWNSHIP 26 South RANGE 18 West COUNTY Edwards STATE Kansas = 1760 Acres

connected quarter (1/4 sec) and 1/2 sec 2/24/79

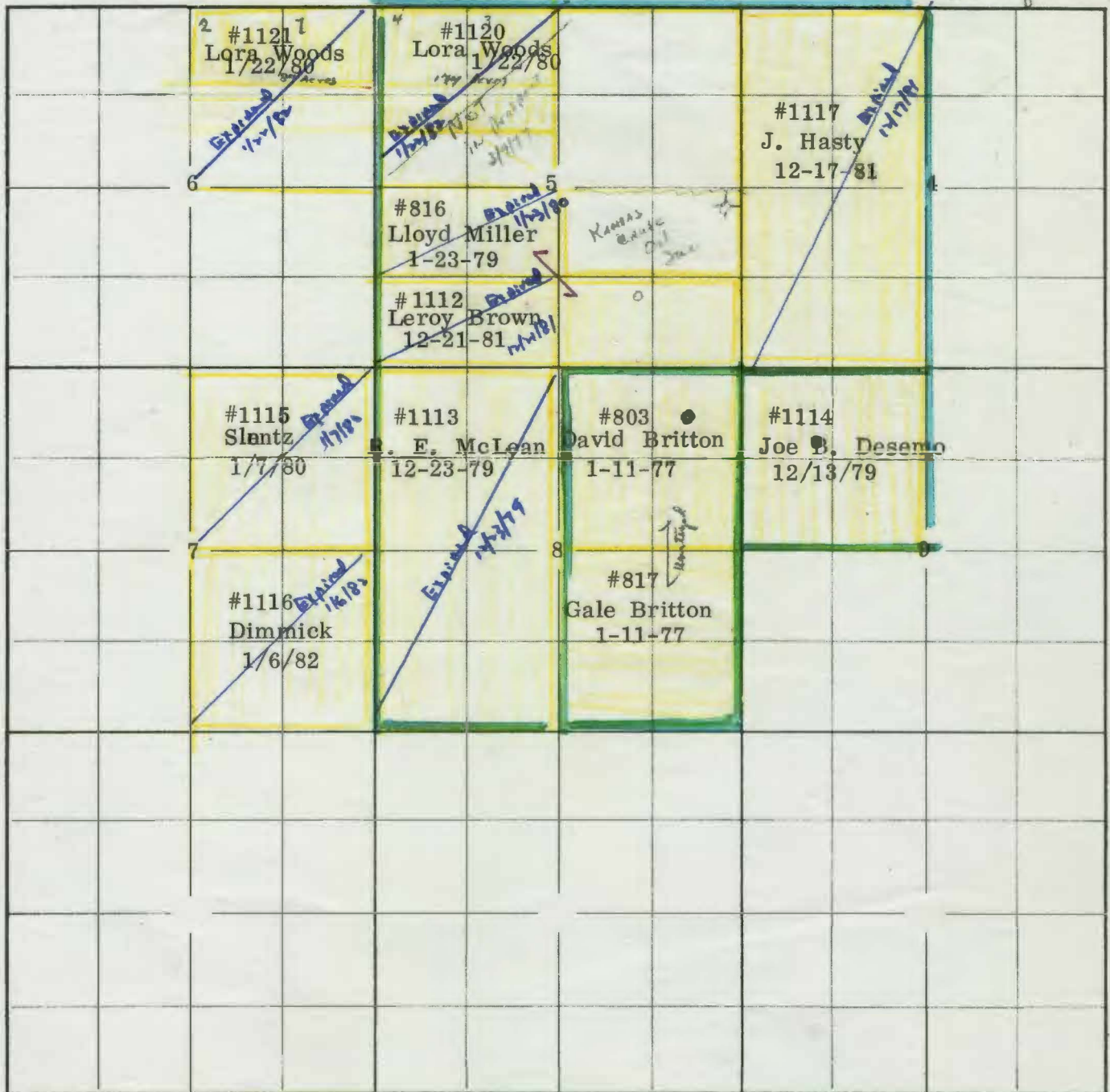

EXHIBIT "A"

BRITTON "GAS UNIT" - E/2 of Section 8-26S-18W

Lse #803 - David Britton - NE/4 of Section 8-26S-18W

Lse #817 - Gale Britton - SE/4 of Section 8-26S-18W

160

160

320

Acres

320



RUPE OIL COMPANY, INC.

P.O. BOX 2273 • 434 OHIO, WICHITA, KANSAS 67201 • (316)262-3718

BRITTON PROSPECT - W/2 of Section 4;
All of Section 5;
All of Section 8; and
NW/4 of Section 9 all in

TOWNSHIP 26 South RANGE 18 West COUNTY Edwards STATE Kansas = 1760 Acres

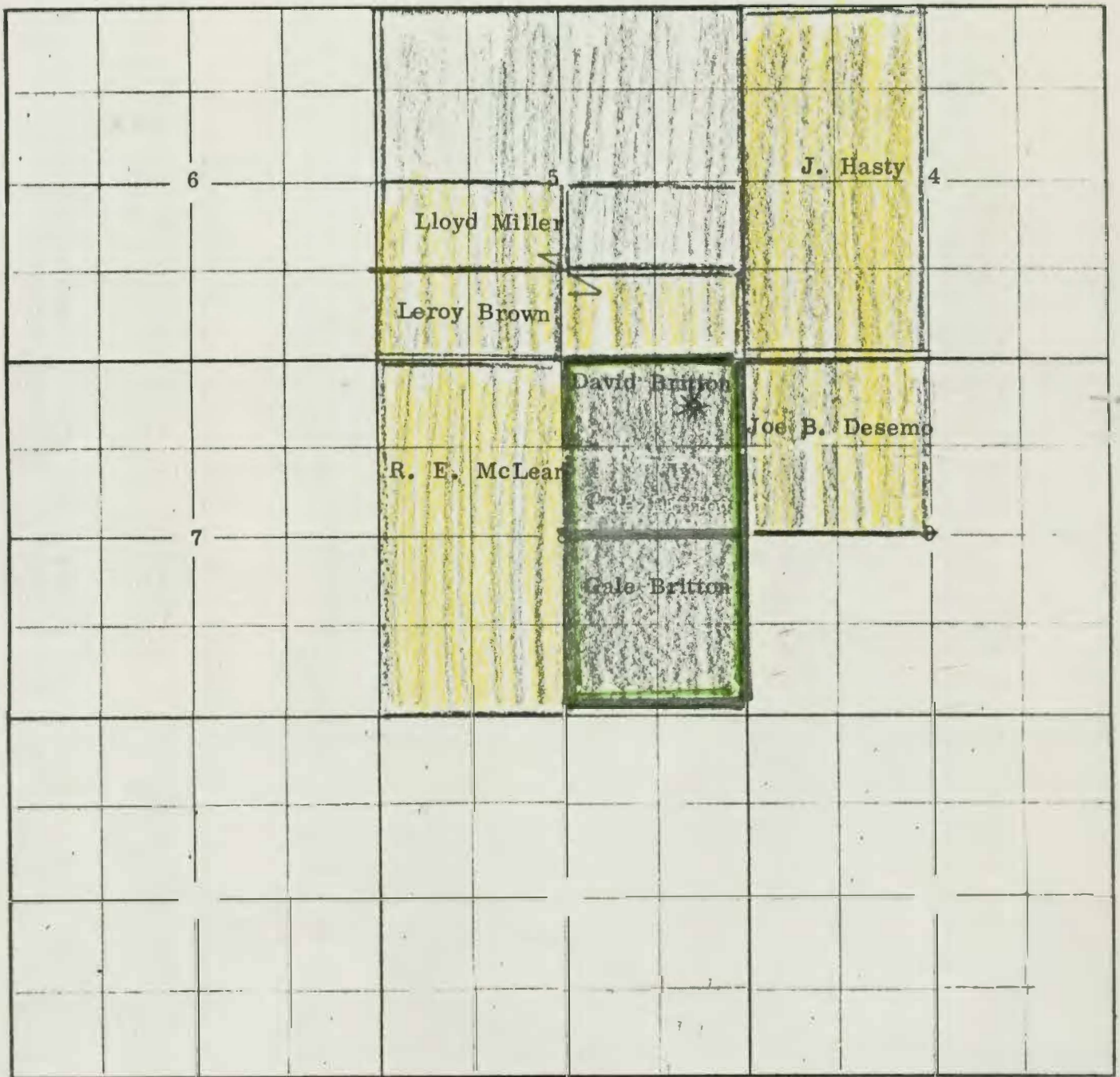

EXHIBIT "A"

12-1-77
DATE

Edwards 5 26s 18w NE SW SE
 COUNTY S T R LOCATION
 Rupe Oil 1 Miller
 OPERATOR NO.
 ELEVATION: 2186 9v

APR 12 DEC 3 1977

Glen N. Rupe
 Box 2273
 Wichita, KS 67201

SCALE: 2" = 1 mile

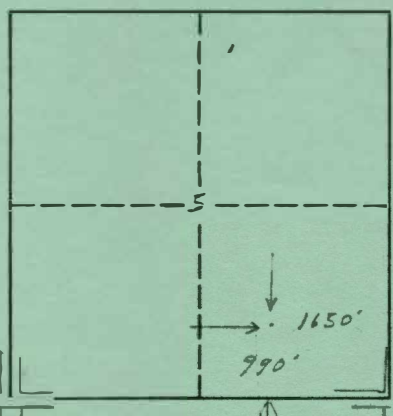

Set 4 1/4" wood
 stake Flagged
 Location is in
 level wheat
 stubble

MINIMUM STAKING CHARGE: \$95.00
 (INCLUDES GROUND ELEVATION)
 EXTRA TIME & MILEAGE: 10.00
 ELEVATION CHARGE: #
 TOTAL: 105.00

Thank you
 Vernon C Becker
 L-S SURVEYOR

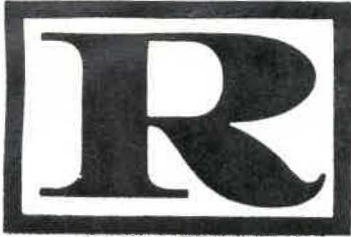

RUPE OIL COMPANY, INC.

P.O. BOX 2273 - 131 OHIO, WICHITA, KANSAS 67201 - (316) 262-3718

MILLER "Gas Unit" - S/2 N/2 & SE/4 of Section 5-26S-18W,

TOWNSHIP 26 South RANGE 18 West COUNTY Edwards STATE Kansas = 320 Acres

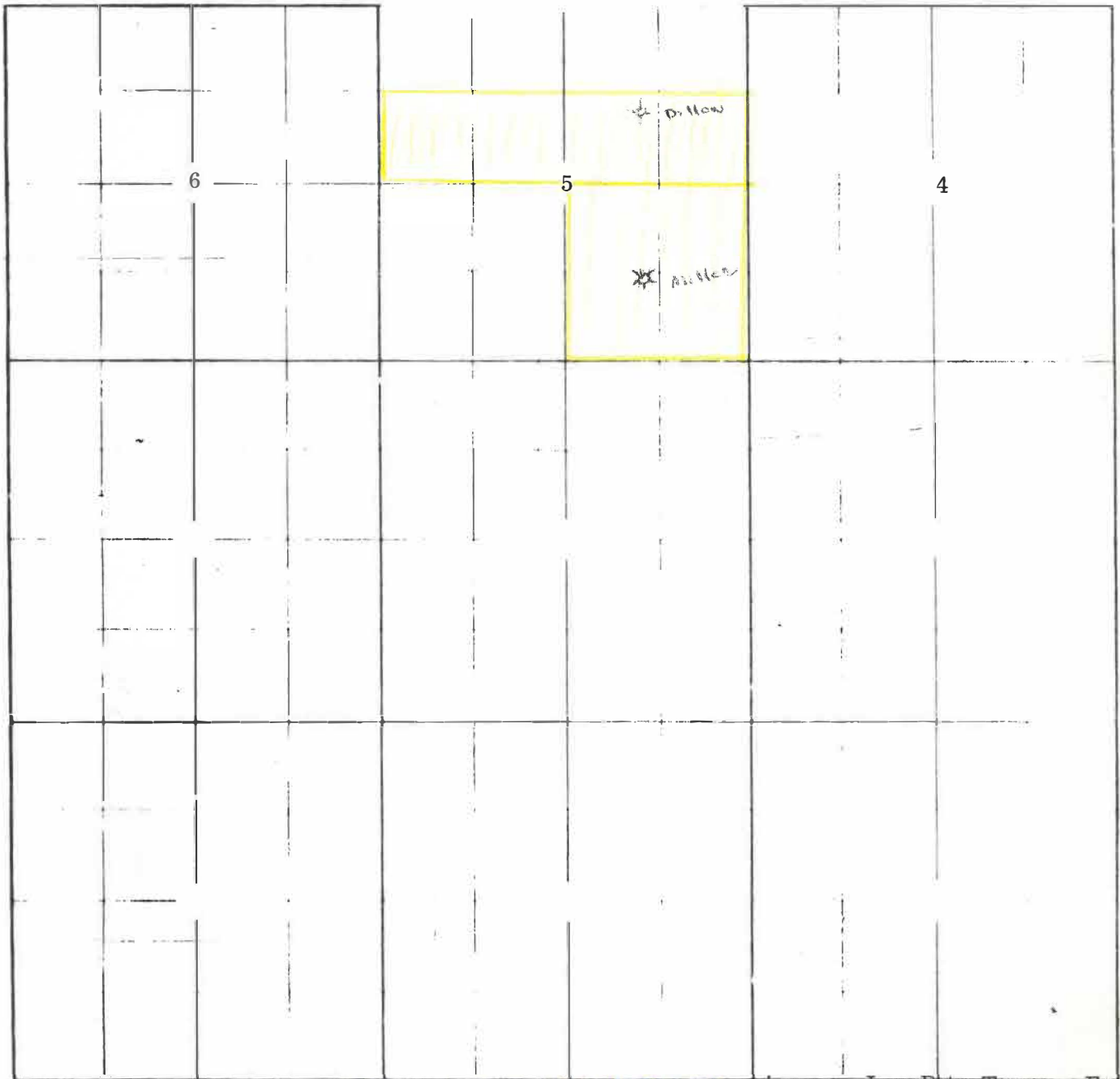

Lse #	Owner	Acres	Lse Date	Term	Expires
Lse #816	Lloyd Miller	80	1/23/74	5 yrs.	1/23/79
Lse #1187	*Glenn E. Hetrick	80	5/20/77	1 yr.	6/20/78
Lse #1189	*L. W. Newsom (Dillon)	160	6/13/73	6 yrs.	6/13/78
		320			

~~#1 MILLER - NE SW SE of Sec. 5-26S-18W - commenced 12/18/77 - plugged 4/8/80
 (Drilled and completed as producer 1/1/78 - (Affidavit of Production dated 1/10/78
 Production ceased 11/20/77) filed of record 1/11/78)~~

#1 DILLON - Appr. NE SW NE of Sec. 5-26S-18W - commenced 1/28/78
 (Drilled and completed as D&A 3/30/78 (making into SWD well))

Assigned William P. Higgins - 3/4ths Interest in MILLER 'Gas Unit' - Miller (Lse #816) 12/27/76
 Hetrick (Lse #1187) 5/24/78
 Newsom (Lse #1189) 1/13/78

subject to 1/ x7/8ths 'override' in favor of Fred Shaffer (6/20/77)
 covering N/2 SE/4 of 5-26S-18W (Hetrick)(Dillon)

subject to 1/8x7/8ths 'override' in favor of Continental Oil Company
 covering S/2 N/2 of 5-26S-18W (Newsom)(Dillon)

MILLER "GAS UNIT" UNITIZED June 2, 1978

copy to 6/1 7/2/78