

GHLIN-SIMMONS & CO. OF KANSAS,

OILWELL ELEVATIONS AND LOCATIONS

21 W. 18TH STREET

(316) 943-5351

KW012878-2

WICHITA, KANSAS 67203
1337 N. Meridian Suite 2

Wichita, Kansas 67203

DATE _____

Edwards

~~Kiowa~~

5 26s 18w

Appx 1570FEL 3630FSL of Sec

COUNTY

S T R

LOCATION

ROCO Inc (Rupe Oil)

1

Dillon

OPERATOR

NO.

FARM

ELEVATION: 2187 DF
2184 Gr

Glen N. Rupe
Box 2273
Wichita, KS 67201

11/15/1978

SCALE:

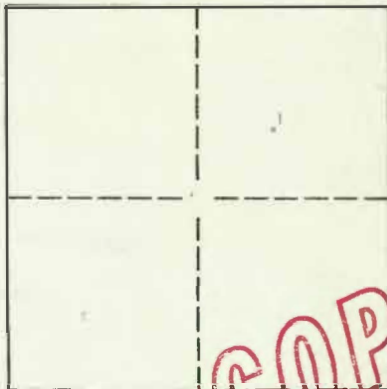

Location moved
330' E & N

COPY

*and location
of elevation only
stated by John
Cruz*

MINIMUM STAKING CHARGE: _____
(INCLUDES GROUND ELEVATION)

EXTRA TIME & MILEAGE: _____

\$50.00

ELEVATION CHARGE: _____

WELL LOCATION

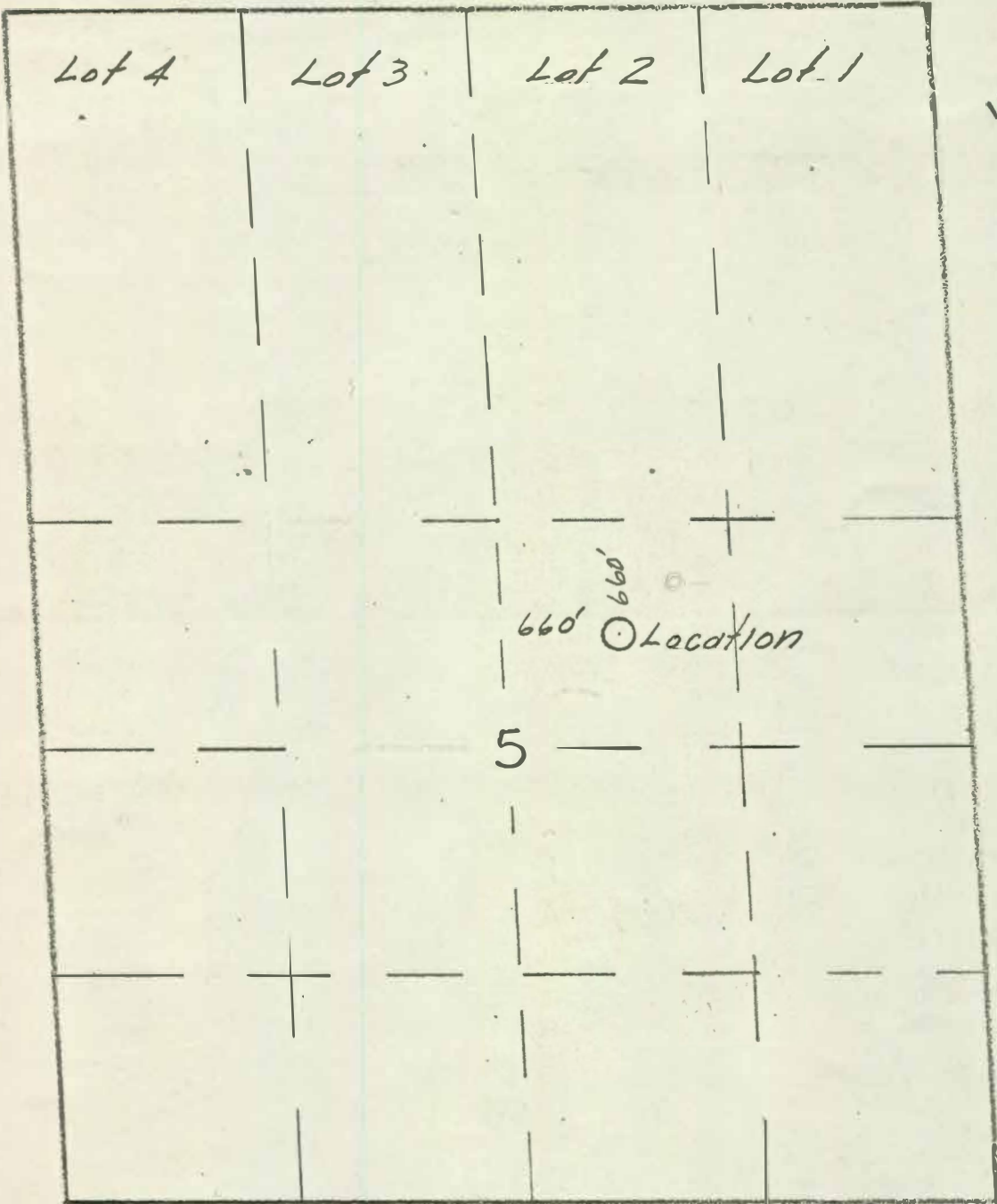

JAN 21 1978

DILLON NO. 1
SW NE SEC. 5, 26, 18
EDWARDS CO. KS.
JAN. 18, 1978

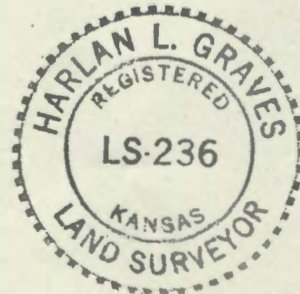

mailed copy
John Gail
1/25/78

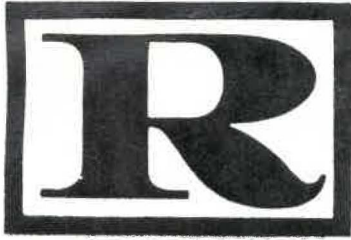

RUPE OIL COMPANY, INC.

P.O. BOX 2273 · 431 OHIO, WICHITA, KANSAS 67201 · (316)262-3718

MILLER "Gas Unit" - S/2 N/2 & SE/4 of Section 5-26S-18W,

TOWNSHIP 26 South RANGE 18 West COUNTY Edwards STATE Kansas = 320 Acres

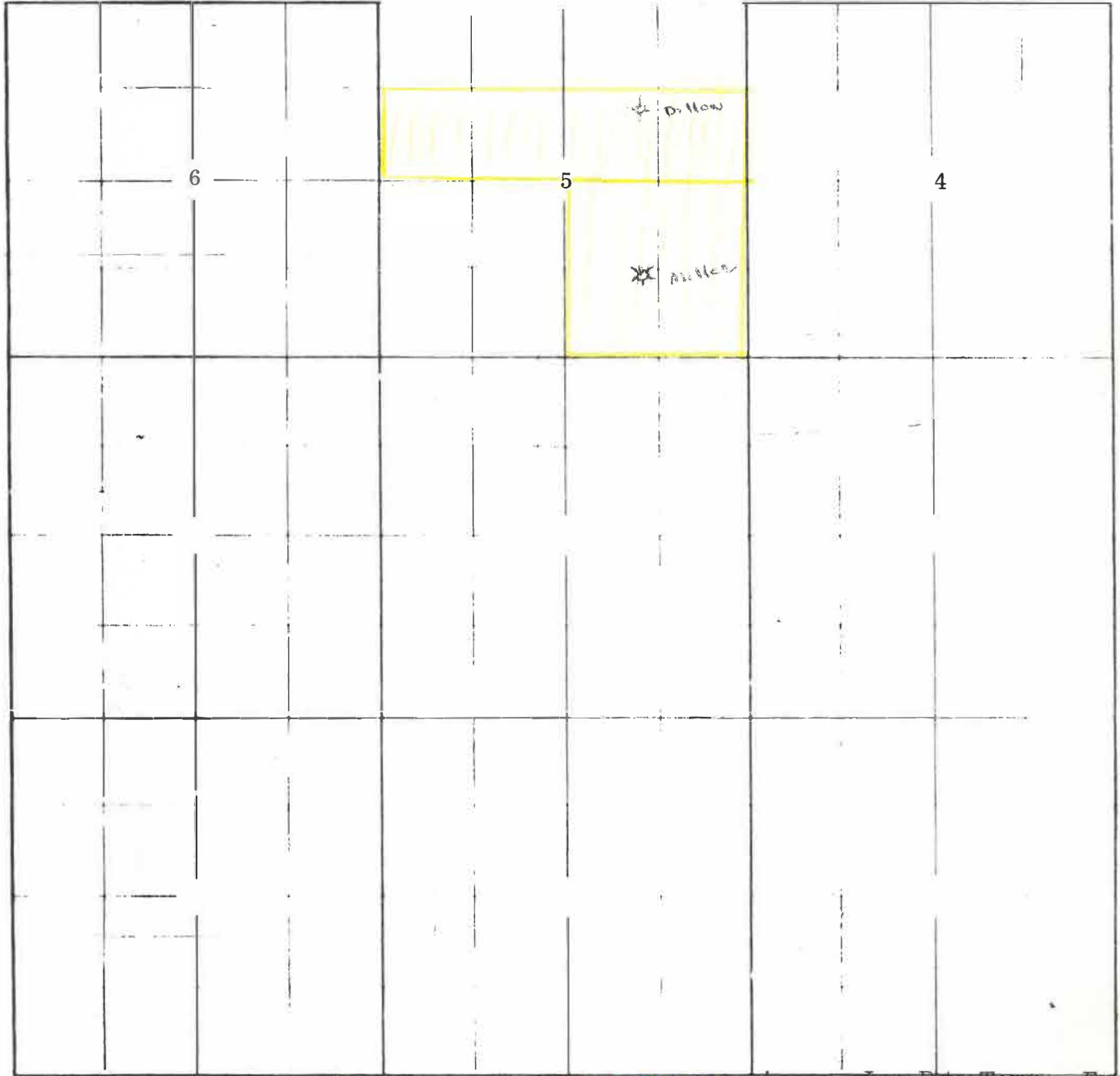

Lse #	Owner	Acres	Lse Date	Term	Expires
Lse #816	Lloyd Miller	80	1/23/74	5 yrs.	1/23/79
Lse #1187	*Glenn E. Hetrick	80	5/20/77	1 yr	6/20/78
Lse #1189	*L. W. Newsom (Dillon)	160	6/13/73	6 yrs.	6/13/78
		320			

~~#1 MILLER - NE SW SE of Sec. 5-26S-18W - commenced 12/18/77 - plugged 4/8/80
 (Drilled and completed as producer 1/1/78 - (Affidavit of Production dated 1/10/78
 Production ceased 11/26/77) filed of record 1/11/78)~~

#1 DILLON - Appr. NE SW NE of Sec. 5-26S-18W - commenced 1/28/78
 (Drilled and completed as D&A 3/30/78 (making into S&D well))
 Assigned William P. Higgins - 3/4ths Interest in MILLER 'Gas Unit' - Miller (Lse #816) 12/27/76
 Hetrick (Lse #1187) 5/24/78
 Newsom (Lse #1189) 1/13/78

subject to 1/ x7/8ths 'override' in favor of Fred Shaffer (Lse #117) covering N/2 SE/4 of 5-26S-18W (Hetrick) (Dillon)
 *subject to 1/8x7/8ths 'override' in favor of Continental Oil Company covering S/2 N/2 of 5-26S-18W (Newsom)(Dillon)

MILLER "GAS UNIT" UNITIZED June 2, 1978

copy to G1 7/28/78