

LAUGHLIN-SIMMONS & CO. OF KANSAS, INC.
 OILWELL ELEVATIONS AND LOCATIONS
 2121 W. 18TH STREET WICHITA, KANSAS 67203
 (316) 943-5351

311974

12-30-74
 DATE

Edwards COUNTY 11 S 26s T 19w R LOCATION 640'N 1800'E of SWc
 Glen Rupe OPERATOR 1 NO. Titus FARM

ELEVATION: 2221 Cr.

Mr. Glen N. Rupe
 925 Olive Garvey Building
 Wichita, Kansas 67202

SCALE: 2" = 1 Mile

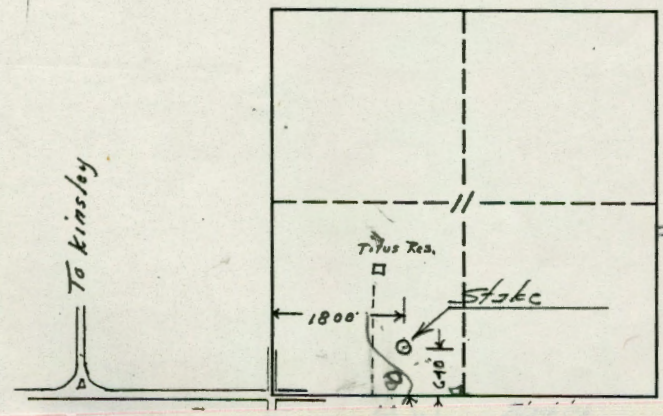

5' wood stake & pink-white flagging
 Level alfalfa field

VOID
 No more
 1/16/75

Titus
 corrected loc.
 to Sec. 11-26s-19w
 840 N } 1800 E. of
 SW/c

W. W. W. W.
 ENGINEER
 d/or omissions.

(G.L. Plat. 2223) From
 Section Elev.
 S.P. C-3
 around 405' W (450 S)

Now SW 34 SW
 Never get copy of section elevation