

Incl 9/28/84 Kay

STATE CORPORATION COMMISSION OF KANSAS
OIL & GAS CONSERVATION DIVISION

WELL COMPLETION OR RECOMPLETION FORM
ACO-1 WELL HISTORY

DESCRIPTION OF WELL AND LEASE

Operator: License # 9726
Name Gruss Petroleum Management, Inc.
Address 900 Building of the Southwest
310 West Texas Street
City/State/Zip Midland, Texas 79701

Purchaser N/A

Operator Contact Person Earl W. Levea
Phone (915) 682-8319

Contractor: License # 5832
Name Cheyenne Drilling, Inc.

Wellsite Geologist Dusty Rhodes
Phone (913) 743-5419

Designate Type of Completion

- New Well
- Re-Entry
- Workover
- Oil
- SWD
- Temp Abd
- Gas
- Inj
- Delayed Comp.
- Dry
- Other (Core, Water Supply etc.)

If **OWWO**: old well info as follows:
Operator
Well Name
Comp. Date Old Total Depth

WELL HISTORY

Drilling Method:
 Mud Rotary Air Rotary Cable
9/19/84 9/28/84 9/28/84
Spud Date Date Reached TD Completion Date
4901' N/A
Total Depth PBDT

Amount of Surface Pipe Set and Cemented at 474 feet
Multiple Stage Cementing Collar Used? Yes No
If yes, show depth set feet
If alternate 2 completion, cement circulated from feet depth to w/SX cmt

API No. 15-057-20,389
County Ford
C. E/2 E/2 SE/4 Sec. 29 Twp. 26S Rge. 21 East West

1320 Ft North from Southeast Corner of Section
330 Ft West from Southeast Corner of Section
(Note: Locate well in section plat below)

Lease Name Van Nehman Well # 1

Field Name Wildcat

Producing Formation D & A

Elevation: Ground 2302' KB 2311'

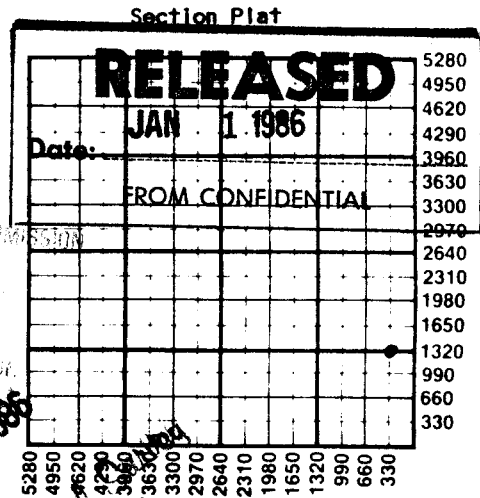

WATER SUPPLY INFORMATION
Disposition of Produced Water: Disposal Repressuring
Docket

Questions on this portion of the ACO-1 call:
Water Resources Board (913) 296-3717

Source of Water:
Division of Water Resources Permit #
 Groundwater Ft North from Southeast Corner (Well) Ft West from Southeast Corner of Sec Twp Rge East West
 Surface Water Ft North from Southeast Corner (Stream, pond etc) Ft West from Southeast Corner Sec Twp Rge East West
 Other (explain) (purchased from city, R.W.D. #)

INSTRUCTIONS: This form shall be completed in duplicate and filed with the Kansas Corporation Commission, 200 Colorado Derby Building, Wichita, Kansas 67202, within 90 days after completion or recompletion of any well. Rule 82-3-130 and 82-3-107 apply. Information on side two of this form will be held confidential for a period of 12 months if requested in writing and submitted with the form. See rule 82-3-107 for confidentiality in excess of 12 months. One copy of all wireline logs and drillers time log shall be attached with this form. Submit CP-4 form with all plugged wells. Submit CP-111 form with all temporarily abandoned wells.

SIDE TWO

Operator Name Gruss Petroleum Management, Inc. Lease Name Van Nehman Well # 1

Sec. 29 Twp. 26S Rge. 21 East West County Ford

WELL LOG

INSTRUCTIONS: Show important tops and base of formations penetrated. Detail all cores. Report all drill stem tests giving interval tested, time tool open and closed, flowing and shut-in pressures, whether shut-in pressure reached static level, hydrostatic pressures, bottom hole temperature, fluid recovery, and flow rates if gas to surface during test. Attach extra sheet if more space is needed. Attach copy of log.

Drill Stem Tests Taken Yes No
 Samples Sent to Geological Survey Yes No
 Cores Taken Yes No

Formation Description
 Log Sample

DST #1 - 4,805-25' (Mississippi)
 Recovered 30' slightly oil cut mud and 180' water. 45-90-60-120. IHP 2356 psi, IFP 57-84 psi, ISIP 1079 psi, FFP 109-135 psi, FSIP 544 psi, FHP 2350 psi, BHT 124° F.

DST #2 - 4,820-40' (Mississippi)
 Recovered 20' mud cut oil and 660' water. 45-90-60-120. IHP 2391 psi, IFP 71-211 psi, ISIP 1518 psi, FFP 260-331 psi, FSIP 1522 psi, FHP 2366 psi, BHT 124° F.

Name	Top	Bottom
Herington	2490'	
Krider	2528'	
Towanda	2635'	
Foraker	3238'	
Root Shale	3326'	
Stotter Lime	3410'	
Tarkeo	3469'	
Bern Lime	3548'	
Howard Lime	3607'	
Topeka	3636'	
Deer Creek Lime	3722'	
LaCompton	3825'	
Heebner Shale	4041'	
Amazonia	4121'	
Brown Lime	4158'	
Lansing	4169'	
Shark Shale	4415'	

(See Attached Page)

CASING RECORD <input checked="" type="checkbox"/> New <input type="checkbox"/> Used Report all strings set-conductor, surface, intermediate, production, etc.							
Purpose of String	Size Hole Drilled	Size Casing Set (in O.D.)	Weight Lbs/Ft.	Setting Depth	Type of Cement	#Sacks Used	Type and Percent Additives
Surface csg.	12-1/4"	8-5/8"	24	474'	Pozmix	360	3% CaCl # Flocele/sx
PERFORATION RECORD N/A Shots Per Foot Specify Footage of Each Interval Perforated				Acid, Fracture, Shot, Cement Squeeze Record (Amount and Kind of Material Used) Depth			
.....						
.....						
.....						
.....						
TUBING RECORD				Liner Run <input type="checkbox"/> Yes <input type="checkbox"/> No			
Date of First Production		Producing Method					
D C A				<input type="checkbox"/> Flowing <input type="checkbox"/> Pumping <input type="checkbox"/> Gas Lift <input type="checkbox"/> Other (explain).....			

29-26-21W

GRUSS PETROLEUM MANAGEMENT, INC. X
900 BUILDING OF THE SOUTHWEST
MIDLAND, TEXAS 79701
915-682-8319

Gruss Petroleum Management, Inc.
Van Nahmen #1
Section 29, T26S-R21W
Ford Co., Kansas

Q 5/2 5/2 SE

Form ACO-1

Formation Description
(Additional Log Tops)

Name	Top
Hush Shale	4499'
Ft. Scott	4691'
Cherokee Shale	4708'
Upper Cherokee	4732'
L. Cherokee	4771'
Mississippian	4802'

JAN 21 1984
State Geological Survey
WICHITA BRANCH

NOV 2 1984
CONFIDENTIAL
State Geological Survey
WICHITA BRANCH

STATE GEOLOGICAL SURVEY
WICHITA BRANCH
OCT 11 1984
COURTESY OF THE STATE GEOLOGICAL SURVEY

File
P1

DRILLER'S LOG *

Gruss Petroleum, Inc.
Van Nehman #1
1320 FSL, 330 FEL
Section 29 - T26S - R21W
Ford County, Kansas

Commenced: 9-19-84
Completed: 9-28-84

Surface Casing: 461' of 8-5/8"
cmtd w/300 sx 60/40 pozmix,
3% cc, 1/4# Flocele/barrel.

OCT 12 1984
State Geologist
WICHITA MISSOURI

FORMATION

DEPTH

Surface Hole	0 - 474
Clay	474 - 650
Red Bed, Shale	650 - 1300
Shale	1300 - 1331
Anhydrite	1331 - 1377
Sand, Shale	1377 - 1695
Shale	1695 - 2455
Lime, Shale	2455 - 2710
Shale, Lime	2710 - 3180
Lime, Shale	3180 - 3415
Lime	3415 - 3900
Lime, Shale	3900 - 4310
Lime	4310 - 4480
Lime, Shale	4480 - 4605
Lime	4605 - 4815
Lime, Shale	4815 - 4825
Mississippi	4825 - 4840
Lime, Shale	4840 - 4901 RTD

I do hereby certify that the foregoing statements are true and correct to the best of my knowledge and belief.

CHEYENNE DRILLING, INC.

A. J. Jacques
A. J. Jacques

STATE OF KANSAS: ss:

Subscribed and sworn to before me this 4th day of October, 1984.

Sharyn K. Coates
Sharyn K. Coates, Notary Public

