

STATE CORPORATION COMMISSION OF KANSAS  
OIL & GAS CONSERVATION DIVISION  
WELL COMPLETION OR RECOMPLETION FORM  
ACO-1 WELL HISTORY  
DESCRIPTION OF WELL AND LEASE

Operator: License # 5293  
Name Helmerich & Payne, Inc.  
Address P O Box 558  
City/State/Zip Garden City, KS 67846

Purchaser

Operator Contact Person Millard Lindsay  
Phone 316-276-3693

Contractor: License # N.A.  
Name N.A.

Wellsite Geologist Charles Nelson  
Phone N.A.

Designate Type of Completion  
 New Well  Re-Entry  Workover  
 Oil  SWD  Temp Abd  
 Gas  Inj  Delayed Comp.  
 Dry  Other (Core, Water Supply etc.)  
If OWO: old well info as follows:  
Operator  
Well Name  
Comp. Date Old Total Depth

WELL HISTORY

Drilling Method:  
 Mud Rotary  Air Rotary  Cable  
15-59 3-29-59 7-30-59  
Spud Date Date Reached TD Completion Date  
5219 5191  
Total Depth PBDT

Amount of Surface Pipe Set and Cemented at 817 feet  
Multiple Stage Cementing Collar Used?  Yes  No  
If yes, show depth set 2808 feet  
If alternate 2 completion, cement circulated from 2808 feet depth to surf w/ 350 SX cmt  
Cement Company Name N.A.  
Invoice #

METHOD OF COMPLETION

Disposition of gas:  Vented  Sold  Used on Lease  None

API NO. 15- N/A  
County Finney  
C. NE. SE. Sec. 18. Twp. 26. Rge. 34. X West

1980 Ft North from Southeast Corner of Section  
660 Ft West from Southeast Corner of Section  
(Note: Locate well in section plat below)

Lease Name PPU WIW Well # 2

Field Name Pleasant Prairie

Injection Producing Formation Morrow and Miss B & C

Elevation: Ground 3015 KB 3020

Section Plat

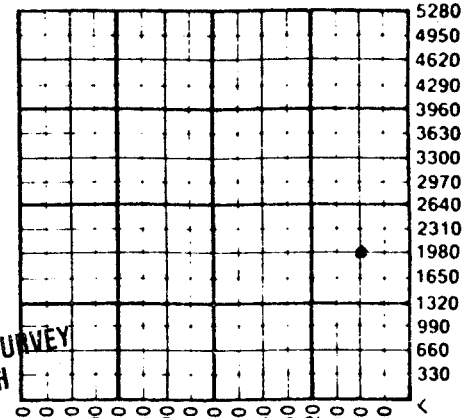

KANSAS GEOLOGICAL SURVEY  
WICHITA BRANCH

AUG 5 1987

WATER SUPPLY INFORMATION

Disposition of Produced Water:  Disposal  
Docket #  Repressuring

Questions on this portion of the ACO-1 call:

Water Resources Board (913) 296-3717

Source of Water:  
Division of Water Resources Permit #

Groundwater Ft North from Southeast Corner  
(Well) Ft West from Southeast Corner of  
Sec Twp Rge East West

Surface Water Ft North from Southeast Corner  
(Stream, pond etc.) Ft West from Southeast Corner  
Sec Twp Rge East West

Other (explain) N/A  
(purchased from city R.W.D. #)  
Production Interval

Open Hole  Perforation  
 Other (Specify) 5018-5028  
 Dually Completed 5092-5104  
 Commingled 5164-5178

AUG 18 1987

NOTE: Converted to water injection well 4-66

Operator Name Helmerich & Payne, Inc. Lease Name PPU WIW Well # 2

Sec. 18 Twp. 26s Rge. 34  East  West County Finney

Estimated Production Per 24 Hours	Oil	Gas	Water	Gas-Oil Ratio	Gravity
	26 Bbls	0 MCF	72 Bbls	CFPB	

Drill Stem Tests Taken  Yes  No  
 Samples Sent to Geological Survey  Yes  No  
 Cores Taken  Yes  No

Formation Description  
 Log  Sample

Name	Top	Bottom
Topeka	3459	
Heebner	3877	
Toronto	3891	
Lansing	3927	
Base KC	4435	
Marm	4506	
Cherokee	4654	
Atoka	4863	
Morrow	4926	
St. Gen	5042	
St Louis	5087	
T D	5220	

CASING RECORD  New  Used

Report all strings set-conductor, surface, intermediate, production, etc.

Purpose of String	Size Hole Drilled	Size Casing Set (in O.D.)	Weight Lbs/Ft.	Setting Depth	Type of Cement	#Sacks Used	Type and Percent Additives
Surface	12 1/4	8-5/8	24	817	N/A	500	
Production	7-7/8	5 1/2	14 & 15.5	5219	N/A	750	Stage Tool @ 2808'
Production	---	2-7/8	6.5	5191	Poz mix	500	1/2#/sk Flocele

PERFORATION RECORD

Acid, Fracture, Shot, Cement Squeeze Record

Shots Per Foot	Specify Footage of Each Interval Perforated	(Amount and Kind of Material Used)	Depth
2	5018-5028	1000 gal 15% HCL	
2	5092-5104		
2	5164-5178		

TUBING RECORD Size 1 1/2" Set At 4998 Packer at 4998 Liner Run  Yes  No 2-7/8 from surface to 5191'

Date of First Production 4-15-59 Producing Method  Flowing  Pumping  Gas Lift  Other (explain).....