

23 - 26 - 39W

KANSAS DRILLERS LOG *State Geological Survey*

WICHITA; BRANCH

API No. 15 — 075 — 20,094
County Number

S. 23 T. 26 R. 39 E W

Loc. 1250 FSL & 2540 FEL

County Hamilton

Operator
Amoco Production Company

Address
P. O. Box 432 - Liberal, Kansas 67901

Well No. 2 Lease Name
McDonald Gas Unit "D"

Footage Location
1250 feet from XX (S) line 2540 feet from (E) XX line

Principal Contractor
Service Drilling Co. Geologist

Spud Date 4-26-75 Total Depth 2934 P.B.T.D. 2932

Date Completed 5-24-75 Oil Purchaser

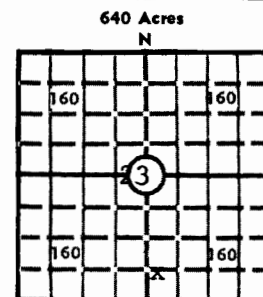

Elev.: Gr. 3307

DF KB 3314

CASING RECORD

Report of all strings set — surface, intermediate, production, etc.

Purpose of string	Size hole drilled	Size casing set (in O.D.)	Weight lbs/ft.	Setting depth	Type cement	Sacks	Type and percent additives
Surface	12-1/4	8-5/8	28.55	611	Class "H"	385	3% CACL
Production	7-7/8	5-1/2	15.5	2934	Special	850	18% CACL

LINER RECORD

Top, ft.	Bottom, ft.	Sacks cement

PERFORATION RECORD

Shots per ft.	Size & type	Depth interval
2	1/2" Jet	2742-50, 2760-65, 2770-76, 2780-86, 2802-10, 2814-18, 2826-32, 2847-56, 2876-82

TUBING RECORD

Size	Setting depth	Packer set at
2-3/8	2810	

ACID, FRACTURE, SHOT, CEMENT SQUEEZE RECORD

Amount and kind of material used	Depth interval treated
Acid. w/ 2500 gal. 15% HCL. Frac w/ 100,000 gal. trt. wt. and 150,000# River Sand.	2742-2882

INITIAL PRODUCTION

Date of first production 5-24-75 Producing method (flowing, pumping, gas lift, etc.) Flow

RATE OF PRODUCTION PER 24 HOURS Oil bbls. Gas 7400 MCF Water bbls. Gas-oil ratio CFPB

Disposition of gas (vented, used on lease or sold) SI for Pipeline Connection Producing interval(s) 2742-2882

INSTRUCTIONS: As provided in KCC Rule 82-2-125, within 90 days after completion of a well, one completed copy of this Drillers Log shall be transmitted to the State Geological Survey of Kansas, 4150 Monroe Street, Wichita, Kansas 67209. Copies of this form are available from the Conservation Division, State Corporation Commission, 3830 So. Meridian (P.O. Box 17027), Wichita, Kansas 66217. Phone AC 316-522-2206. If confidential custody is desired, please note Rule 82-2-125. Drillers Logs will be on open file in the Oil and Gas Division, State Geological Survey of Kansas, Lawrence, Kansas 66044.

Operator Amoco Production Company		DESIGNATE TYPE OF COMP.: OIL, GAS, DRY HOLE, SWDW, ETC.: Gas
Well No. 2	Lease Name McDonald Gas Unit "D"	
S 23 T 26 R 39 E W		

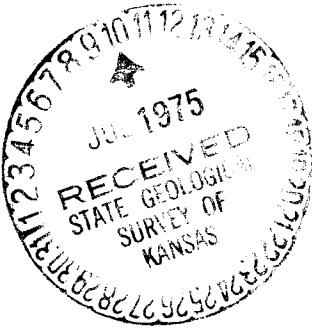
WELL LOG			SHOW GEOLOGICAL MARKERS, LOGS RUN, OR OTHER DESCRIPTIVE INFORMATION.	
Show all important zones of porosity and contents thereof; cored intervals, and all drill-stem tests, including depth interval tested, cushion used, time tool open, flowing and shut-in pressures, and recoveries.				
FORMATION DESCRIPTION, CONTENTS, ETC.	TOP	BOTTOM	NAME	DEPTH
Sand, Blue Shale, Red Bed	0	611		
Red Bed, Sand	611	1787		
Shale, Anhydrite	1787	1941		
Shale, Lime	1941	2171		
Sand, Shale, Lime	2171	2424		
Shale, Lime	2424	2760		
Lime, Shale	2760	2915		
Shale, Lime	2915	2934		
				

USE ADDITIONAL SHEETS, IF NECESSARY, TO COMPLETE WELL RECORD.

Date Received	<div>  </div> <div>F. J. RADER</div> <div>Signature</div> <div>Administrative Assistant</div> <div>Title</div> <div>May 28, 1975</div> <div>Date</div>
---------------	--