

State Geological Survey

WICHITA BRANCH
KANSAS DRILLERS LOG

IMPORTANT
Kans. Geo. Survey request
samples on this well.

15-057-2011

API No. 15 — 057 — 20,111
County Number

Operator
Texas Oil & Gas Corp.

Address 300 - 200 West Douglas Wichita, Kansas 67202

Well No. #1 Lease Name Birney "B"

Footage Location
1320 feet from (N) (S) line 330 feet from (E) (W) line

Principal Contractor Xplor Drlg. Co. Geologist High Plains Consulting Ltd.

Spud Date 1-24-78 Total Depth 5047' P.B.T.D. N/A

Date Completed 2-2-78 Oil Purchaser N/A

S. 35 T. 27 R. 21 E
Loc. 1320' FSL & 330' FWL
County Ford

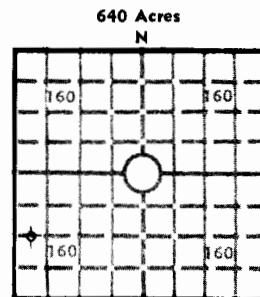

Locate well correctly
Elev.: Gr. 2344'
DF 2349' KB 2352'

CASING RECORD

Report of all strings set— surface, intermediate, production, etc.

Purpose of string	Size hole drilled	Size casing set (in O.D.)	Weight lbs/ft.	Setting depth	Type cement	Sacks	Type and percent additives
Surface	12 1/4"	8-5/8"	24#	585'	Common	575	2% Gel, 3% CaCl

LINER RECORD

Top, ft. N/A Bottom, ft. N/A Sacks cement N/A

PERFORATION RECORD

Shots per ft. Size & type Depth interval

TUBING RECORD

Size N/A Setting depth N/A Packer set at N/A

N/A N/A N/A

ACID, FRACTURE, SHOT, CEMENT SQUEEZE RECORD

Amount and kind of material used

Depth interval treated

N/A

N/A

INITIAL PRODUCTION

Date of first production N/A Producing method (flowing, pumping, gas lift, etc.) N/A

RATE OF PRODUCTION PER 24 HOURS

Oil N/A

Gas N/A

Water N/A

Gas-oil ratio N/A

CFPB

Disposition of gas (vented, used on lease or sold)

N/A

Producing interval (s)

N/A

INSTRUCTIONS: As provided in KCC Rule 82-2-125, within 90 days after completion of a well, one completed copy of this Drillers Log shall be transmitted to the State Geological Survey of Kansas, 4150 Monroe Street, Wichita, Kansas 67209. Copies of this form are available from the Conservation Division, State Corporation Commission, 3830 So. Meridian (P.O. Box 17027), Wichita, Kansas 66217. Phone AC 316-522-2206. If confidential custody is desired, please note Rule 82-2-125. Drillers Logs will be on an open file in the Oil and Gas Division, State Geological Survey of Kansas, Lawrence, Kansas

