

15-081-20127

State Geological Survey  
WICHITA BRANCH

**KANSAS DRILLERS LOG**

S. 6 T. 27 R. 34 <sup>E</sup>/<sub>W</sub>  
Loc. 1495' FNL & 1445' FEL  
County Haskell

API No. 15 — 081 — 20,127  
County Number

Operator  
Helmerich & Payne, Inc.

Address  
P. O. Box 558 Garden City, Kansas 67846

Well No. # 1 Lease Name  
Curry "C"

Footage Location  
1495 feet from (N) 5 line 1445 feet from (E) 400 line

Principal Contractor  
Gabbert - Jones Geologist  
Joseph Blair

Spud Date  
7-21-78 Total Depth  
2956 P.B.T.D.  
2955

Date Completed  
8-28-78 Purchaser Gas  
Colorado Interstate

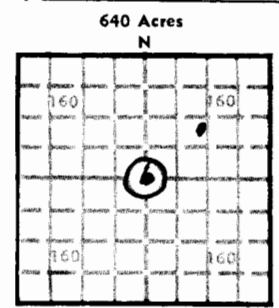

Elev.: Gr. 2995  
DF 2998 KB 3000

**CASING RECORD**

Report of all strings set — surface, intermediate, production, etc.

Purpose of string	Size hole drilled	Size casing set (in O.D.)	Weight lbs/ft.	Setting depth	Type cement	Sacks	Type and percent additives
Surface	12 1/4	8 5/8	24#	795	65-35 Poz mix Class H	350 150	6%gel, 2%CaCl <sub>2</sub> , 1/4#/sk 3% CaCl <sub>2</sub> Celloflake
Production	7 7/8	5 1/2	14# & 15.5#	2955	65-35 Pozmix 50/50 Pozmix	575 100	6%gel, 1/4#/sk 2%gel, 18% salt flake

**LINER RECORD**

**PERFORATION RECORD**

Top, ft.	Bottom, ft.	Sacks cement	Shots per ft.	Size & type	Depth interval
None			2	1/2" Omega jet	2908-2917
<b>TUBING RECORD</b>			2	1/2" Omega jet	2886-2896
			2	1/2" Omega jet	2846-2866
Size	Setting depth	Packer set at	2	1/2" Omega jet	2838-2841
2 3/8	2931	None	2	1/2" Omega jet	2823-2827

**ACID, FRACTURE, SHOT, CEMENT SQUEEZE RECORD**

Amount and kind of material used	Depth interval treated
3250 gals 15% HCl acid and 130 ball sealers,	2823-2917
85,680 gals gelled water w/70,000# 20-40 sand	
and 40,000# 10-20 sand	

**INITIAL PRODUCTION**

Date of first production <u>10-24-78</u>	Producing method (flowing, pumping, gas lift, etc.) <u>Flowing</u>
RATE OF PRODUCTION PER 24 HOURS	Oil <u>0</u> bbls. Gas <u>1783</u> MCF Water <u>31</u> bbls. Gas-oil ratio
Disposition of gas (vented, used on lease or sold) <u>Sold to Colorado Interstate Gas</u>	Producing interval (s) <u>Council Grove 2823-2917</u>

INSTRUCTIONS: As provided in KCC Rule 82-2-125, within 90 days after completion of a well, one completed copy of this Drillers Log shall be transmitted to the State Geological Survey of Kansas, 4150 Monroe Street, Wichita, Kansas 67209. Copies of this form are available from the Conservation Division, State Corporation Commission, 3830 So. Meridian (P.O. Box 17027), Wichita, Kansas 66217. Phone AC 316-522-2206. If confidential custody is desired, please note Rule 82-2-125. Drillers Logs will be on open file in the Oil and Gas Division, State Geological Survey of Kansas, Lawrence, Kansas

Well No. #1 Lease Name Curry C Gas well

S 6 T 27 R 34 W

**WELL LOG**

Show all important zones of porosity and contents thereof; cored intervals, and all drill-stem tests, including depth interval tested, cushion used, time tool open, flowing and shut-in pressures, and recoveries.

SHOW GEOLOGICAL MARKERS, LOGS RUN, OR OTHER DESCRIPTIVE INFORMATION.

FORMATION DESCRIPTION, CONTENTS, ETC.	TOP	BOTTOM	NAME	DEPTH
Herrington Gas	2541	2588	Herrington	2541
Winfield Gas	2602	2626	Winfield	2602
U. Ft. Riley Gas	2662	2696	U. Ft. Riley	2652
L. Ft. Riley Gas	2714	2778	L. Ft. Riley	2778
Wreford	2800	2820	Wreford	2800
Council Grove Gas	2820	2956	DTD	2956
			LTD	2949
Total Depth	2956		Gamma Ray Neutron Log	1500'-2948'
No cores or Drill stem tests taken				

USE ADDITIONAL SHEETS, IF NECESSARY, TO COMPLETE WELL RECORD.

Date Received

*W. E. Spencer*  
Signature  
District Production Superintendent  
Title  
October 26, 1978  
Date