

KANSAS DRILLERS LOG

S. 36 T. 27S R. 41 ^K _W

API No. 15 — 187 — 20231
County Number

Loc. CNW/4

Operator
Amoco Production Company

County Stanton

Address
P. O. Box 432-Liberal, Kansas 67901

640 Acres
 N

Well No. 1 Lease Name L. R. & C.E. Cross

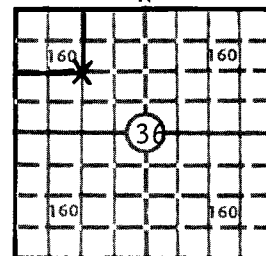

Footage Location
1320 feet from (N) line 1320 feet from (W) line

Locate well correctly

Principal Contractor Service Drilling Geologist

Elev.: Gr. 3308

Spud Date 05-06-77 Total Depth 3000 P.B.T.D. 2455

Date Completed 08-25-77 Oil Purchaser

DF _____ KB _____

CASING RECORD

Report of all strings set — surface, intermediate, production, etc.

Purpose of string	Size hole drilled	Size casing set (in O.D.)	Weight lbs/ft.	Setting depth	Type cement	Sacks	Type and percent additives
Surface	12 1/4	8 5/8	24	639	Howco lite	385	3% CC
Production	7 7/8	5 1/2	14	3000	Howco lite	650	18% SALT

LINER RECORD

PERFORATION RECORD

Top, ft.	Bottom, ft.	Sacks cement	Shots per ft.	Size & type	Depth interval
			2	1/2	2230-2234
TUBING RECORD					2254-2260
Size	Setting depth	Packer set at			2284-2288
2 3/8	2324				

ACID, FRACTURE, SHOT, CEMENT SQUEEZE RECORD

Amount and kind of material used	Depth interval treated
Frac W/500 gals 15% HCL, 20,000 gals treated water	2230-2288
30,000# river sand	

INITIAL PRODUCTION

Date of first production <u>08-25-77</u>	Producing method (flowing, pumping, gas lift, etc.) <u>Flowing</u>		
RATE OF PRODUCTION PER 24 HOURS	Oil bbls.	Gas <u>4100</u> MCF	Water bbls.
Disposition of gas (vented, used on lease or sold) <u>Waiting on pipeline connection</u>	Producing interval (s) <u>2230-2288</u>		

INSTRUCTIONS: As provided in KCC Rule 82-2-125, within 90 days after completion of a well, one completed copy of this Drillers Log shall be transmitted to the State Geological Survey of Kansas, 4150 Monroe Street, Wichita, Kansas 67209. Copies of this form are available from the Conservation Division, State Corporation Commission, 3830 So. Meridian (P.O. Box 17027), Wichita, Kansas 66217. Phone AC 316-522-2206. If confidential custody is desired, please note Rule 82-2-125. Drillers Logs will be on open file in the Oil and Gas Division, State Geological Survey of Kansas, Lawrence, Kansas 66044.

Operator Amoco Production Company DESIGNATE TYPE OF COMP.: OIL, GAS, DRY HOLE, SWDW, ETC.: Gas

Well No. 1 Lease Name L.R. & C.E. Cross

S 36 T27 R 41 ~~EX~~ W

WELL LOG
 Show all important zones of porosity and contents thereof; cored intervals, and all drill-stem tests, including depth interval tested, cushion used, time tool open, flowing and shut-in pressures, and recoveries.
 SHOW GEOLOGICAL MARKERS, LOGS RUN, OR OTHER DESCRIPTIVE INFORMATION.

FORMATION DESCRIPTION, CONTENTS, ETC.	TOP	BOTTOM	NAME	DEPTH
Sand, Red Bed	0	640		
Lime, Sand	640	1911		
Shale, Lime	1,911	2,391		
Lime, Shale	2,391	2,817		
Lime	2,817	3,000		
TD	3,000			

USE ADDITIONAL SHEETS, IF NECESSARY, TO COMPLETE WELL RECORD.

Date Received

Gale McCord Signature
 Gale McCord
 Admn. Asst. Title
 9-13-77 Date