



Ind

STATE CORPORATION COMMISSION OF KANSAS
OIL & GAS CONSERVATION DIVISION

WELL COMPLETION OR RECOMPLETION FORM
ACO-1 WELL HISTORY

DESCRIPTION OF WELL AND LEASE

Operator: License # 5171
Name TXO PRODUCTION CORP.
Address 200 W. Douglas
Suite 300
City/State/Zip Wichita, Kansas 67202

Purchaser Dry Hole

Operator Contact Person Harold R. Trapp
Phone (316) 265-9441 Ext. 261

Contractor: License # 5107
Name H-30 Drilling, Inc.

Wellsite Geologist No Wellsite Geologist
Phone N/A

Designate Type of Completion
 New Well Re-Entry Workover
 Oil SWD Temp Abd
 Gas Inj Delayed Comp.
 Dry Other (Core, Water Supply etc.)

If OWWO: old well, info as follows:
Operator Mid-Continent Energy Corp.
Well Name Fenn #1
Comp. Date 1-22-78 Old Total Depth 4740'

WELL HISTORY

Drilling Method:
 Mud Rotary Air Rotary Cable
..2-27-85.. ..2-28-85.... ..3-01-85....
Spud Date Date Reached TD Completion Date

..2712' ..N/A..
Total Depth PBTD
Wireline Log Recd
Amount of Surface Pipe Set and Cemented at N/A feet
Multiple Stage Cementing Collar Used? Yes No
If yes, show depth set N/A feet
If alternate 2 completion, cement circulated from N/A feet depth to N/A w/ SX cmt

API NO. 15-095-20,676-A-0001
County Kingman
NW NW SE Sec. 31 Twp. 28S Rge. 10 East West

2310' Ft North from Southeast Corner of Section
2310' Ft West from Southeast Corner of Section
(Note: Locate well in section plat below)

Lease Name Fischer "C" (OWWO) Well # 1

Field Name Bortz Ext (1 SE)

Producing Formation Dry Hole

Elevation: Ground 1799' KB 1800'

Section Plat

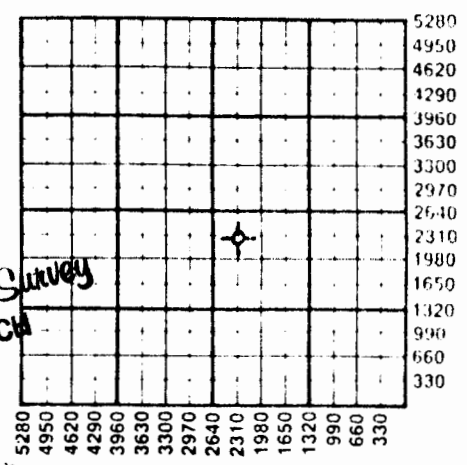

MAR 26 1985
State Geological Survey
WICHITA BRANCH

WATER SUPPLY INFORMATION

Disposition of Produced Water: Disposal Repressuring
Docket # N/A

Questions on this portion of the ACO-1 call:
Water Resources Board (913) 296-3717

Source of Water:
Division of Water Resources Permit # N/A

Groundwater N/A Ft North from Southeast Corner (Well) N/A Ft West from Southeast Corner of Sec Twp Rge East West

Surface Water N/A Ft North from Southeast Corner (Stream, pond etc.) N/A Ft West from Southeast Corner Sec Twp Rge East West

Other (explain) N/A (purchased from city, R.W.D. #)

INSTRUCTIONS: This form shall be completed in duplicate and filed with the Kansas Corporation Commission, 200 Colorado Derby Building, Wichita, Kansas 67202, within 90 days after completion or recompletion of any well. Rule 82-3-130 and 82-3-107 apply.

Information on side two of this form will be held confidential for a period of 12 months if requested in writing and submitted with the form. See rule 82-3-107 for confidentiality in excess of 12 months.

One copy of all wireline logs and drillers time log shall be attached with this form. Submit CP-4 form with all plugged wells. Submit CP-111 form with all temporarily abandoned wells.

MAR 22 1985

182081

SIDE TWO

Operator Name TXO PRODUCTION CORP. Lease Name Fischer "C" (QWWO) Well # 1

Sec. 31 Twp. 28S Rge. 10 East West County Kingman

WELL LOG

INSTRUCTIONS: Show important tops and base of formations penetrated. Detail all cores. Report all drill stem tests giving interval tested, time tool open and closed, flowing and shut-in pressures, whether shut-in pressure reached static level, hydrostatic pressures, bottom hole temperature, fluid recovery, and flow rates if gas to surface during test. Attach extra sheet if more space is needed. Attach copy of log.

Drill Stem Tests Taken [] Yes [X] No
Samples Sent to Geological Survey [X] Yes [] No
Cores Taken [] Yes [X] No

Formation Description [X] Log [] Sample

No DST's Ran.
Ran O.H. Logs

Table with 3 columns: Name, Top, Bottom. Rows include Onaga (2615, -807), Indian Cave (2641, -833), Wabaunsee (2659, -851), LTD (2719'), and RTD (2712').

CASING RECORD, PERFORATION RECORD, TUBING RECORD, and production details. Includes fields for Purpose of String, Size Hole, Size Casing, Weight, Setting Depth, Type of Cement, #Sacks Used, Type and Percent Additives, Shots Per Foot, Specifying Footage, Acid Fracture Shot Cement Squeeze Record, and Producing Method (Dry Hole).