

Ind PI

SIDE ONE

STATE CORPORATION COMMISSION OF KANSAS
OIL & GAS CONSERVATION DIVISION

WELL COMPLETION OR RECOMPLETION FORM
ACO-1 WELL HISTORY

DESCRIPTION OF WELL AND LEASE

Operator: License # 4163
Name Mark III Energy Co., Inc.
Address 207 W. Grand
City/State/Zip Haysville, KS 67060

Purchaser Oil- Derby

Operator Contact Person Dale Stearns - President
Phone 529-1001

Contractor: License # 5420
Name White & Ellis

Wellsite Geologist Mona Manes
Phone 945-8094

- Designate Type of Completion
- New Well Re-Entry Workover
- Oil SWD Temp Abd
- Gas Inj Delayed Comp.
- Dry Other (Core, Water Supply etc.)

If ONWO: old well info as follows:
Operator
Well Name
Comp. Date Old Total Depth.....

WELL HISTORY

Drilling Method:
 Mud Rotary Air Rotary Cable

3-18-85 3-29-85 4-9-85
Spud Date Date Reached TD Completion Date

4995 4780
Total Depth PBTD

Amount of Surface Pipe Set and Cemented at 385 feet
Multiple Stage Cementing Collar Used? Yes No
If yes, show depth set.....feet
If alternate 2 completion, cement circulated
from.....feet depth to.....w/.....SX cmt

API NO. 15-097-21-123
County.....Kiowa
NW.. NW.. SE¹ Sec. 36 Twp. 28S Rge. 17 East West
2310.... Ft North from Southeast Corner of Section
2310.... Ft West from Southeast Corner of Section
(Note: Locate well in section plat below)
Lease Name.....Hannan.....Well #.....1
Field Name.....Wildcat
Producing Formation.....Mississippi
Elevation: Ground.....2115.....KB.....2120

Section Plat

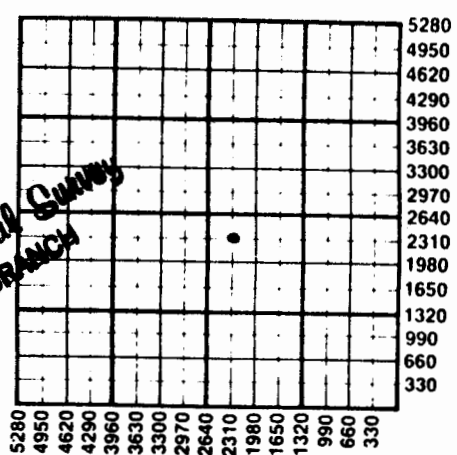

JUL 11 1985
State Geological Survey
WICHITA BRANCH

WATER SUPPLY INFORMATION

Disposition of Produced Water: Disposal Repressuring
Docket #

Questions on this portion of the ACO-1 call:
Water Resources Board (913) 296-3717

Source of Water:
Division of Water Resources Permit # Unknown
(Kellys Water Well Service, Great Bend KS)
 Groundwater 4620....Ft North from Southeast Corner
(Well) 4650....Ft West from Southeast Corner of
Sec 36 Twp 28S Rge 17 East West
 Surface Water.....Ft North from Southeast Corner
(Stream, pond etc).....Ft West from Southeast Corner
Sec Twp Rge East West
 Other (explain).....
(purchased from city, R.W.D. #)

RECEIVED

INSTRUCTIONS: This form shall be completed in duplicate and filed with the Kansas Corporation Commission, 200 Colorado Derby Building, Wichita, Kansas 67202, within 90 days after completion or recompletion of any well. Rule 82-3-130 and 82-3-107 apply.
Information on side two of this form will be held confidential for a period of 12 months if requested in writing and submitted with the form. See rule 82-3-107 for confidentiality in excess of 12 months.
One copy of all wireline logs and drillers time log shall be attached with this form. Submit CP-4 form with all plugged wells. Submit CP-111 form with all temporarily abandoned wells.

SIDE TWO

Operator Name Mark III Energy Co., Inc. Lease Name Hannan Well # 1

Sec. 36 Twp. 28S Rge. 17 East West County Kiowa

WELL LOG

INSTRUCTIONS: Show important tops and base of formations penetrated. Detail all cores. Report all drill stem tests giving interval tested, time tool open and closed, flowing and shut-in pressures, whether shut-in pressure reached static level, hydrostatic pressures, bottom hole temperature, fluid recovery, and flow rates if gas to surface during test. Attach extra sheet if more space is needed. Attach copy of log.

Drill Stem Tests Taken Yes No
 Samples Sent to Geological Survey Yes No
 Cores Taken Yes No

Formation Description
 Log Sample

Attached sheet enclosed

Name	Top	Bottom
Heebner	3996(-1876)	4000
Brown Lime	4164(-2044)	
Lansing	4181(-2061)	
E/KC	4556(-2436)	
Cherokee Shale	4681(-2561)	4685
Mississippi	4718(-2598)	4750
Kinderhook Shale	4766(-2646)	
Viola	4801(-2681)	4890

Estimated Production Per 24 Hours	Oil	Gas	Water	Gas-Oil Ratio	Gravity
	7 Bbls	MCF	60 Bbls	CFPB	48

METHOD OF COMPLETION

Production Interval

Disposition of gas: Vented Open Hole Perforation
 Sold Other (Specify) 4720
 Used on Lease Dually Completed 4740

Purpose of String	Size Hole Drilled	Size Casing Set (in O.D.)	Weight Lbs/Ft.	Setting Depth	Type of Cement	#Sacks Used	Type and Percent Additives
Surface	10	8 5/8	24	385	Common	180	2% gal. 3% cc.
Production	7 7/8	5 1/2	15	4995	Poz. Mix. ASC	120 125	2% gal. 3% cc.

PERFORATION RECORD

Acid, Fracture, Shot, Cement Squeeze Record

Shots Per Foot	Specify Footage of Each Interval Perforated	(Amount and Kind of Material Used)	Depth
3	4720 to 4726	500 gal. 15% Mud Acid Inhibitor	4720
2	4726 to 4740	1000 gal. 15% Mud Acid Inhibitor	4726
2	4848 to 4860	500 gal. 15% Mud Acid Inhibitor	4848
2	4870 to 4871	150 SX Common Cement Squeeze	4870

TUBING RECORD	Size	Set At	Packer at	Liner Run	<input type="checkbox"/> Yes <input checked="" type="checkbox"/> No
	2 3/8	4775	4780		

Date of First Production May 9, 1995 Producing Method Flowing Pumping Gas Lift Other (explain).....

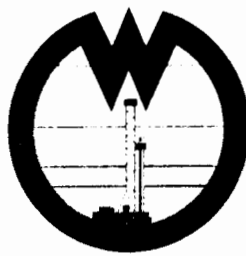

36-28-17W^{p1}
Cal

WHITE

AND ELLIS DRILLING, Inc.

DRILLERS LOG

OPERATOR: Mark III Energy Co, Inc.
207 W. Grand
Haysville, Kansas 67060
CONTRACTOR: White & Ellis Drilling, Inc., 401 E. Douglas, Suite 500,
Wichita, Ks. 67202

Lease Name Hannan Well No. #1
Sec. 36 T. 28S R. 17W Spot C NW NW SE
County Kiowa State Kansas Elevation _____

Casing Record:

Surface: 8 5/8" @ 385' with 300 sx., 2% gel, 3% cc

Production: 5 1/2" @ 4994' with 125 sx.

Type Well: Oil Well Total Depth 4995'

Drilling Commenced 3-18-85 Drilling Completed 3-30-85

Formation	From	To	Tops
Cellar	0	7	
Sand	7	190	
Sand, Shale	190	1955	
Lime, Shale	1955	4765	
Shale	4765	4815	
Lime, Shale	4815	4995	

APR - 8 1985

State Geological Survey
WICHITA BRANCH

30-58-12M