

KANSAS CORPORATION COMMISSION

WELL RECORD

Mail to Kansas Geological Survey, 4150 Monroe Street, Wichita, Kansas 67209)

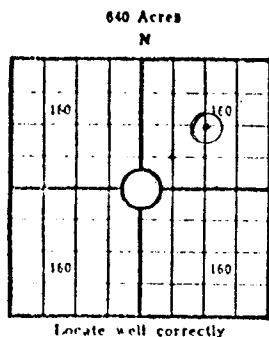

Lease Name: Elmer L. Johnson Unit WN Well No. 2
 Well Located: 1320' FNL & EL Grant Ck
SEC 30 TWP 29S RGE 38W
 Operator: Atlantic Richfield Company
 Address: P.O. Box 521 - Tulsa, Okla. 74102
 Elevation: Ground 3139' D.F. K.B.
 Type Well: (Oil, gas, dry hole) Gas C E g, d

5,363,000 C E g, d

Drilling Commenced: 2-10 19 72 Drilling Completed: 2-14 19 72
 Well Completed: 2-23 19 72 Total Depth 2877'
 Initial Production: 5,363 MCF/day

Casing Record

Size: 8-5/8" Set at 662' Size: Set at
 Size: 5-1/2" Set at 2876' Size: Set at

Liner Record

None

Size: Set from To

Cementing

<u>Casing Size</u>	<u>Sacks</u>	<u>Type Cement and Additives</u>
<u>8-5/8"</u>	<u>375</u>	<u>Regular w/ 3% CaCl</u>
<u>5-1/2"</u>	<u>150</u>	<u>50-50 Pozmix w/ 12-1/2% Gilsonite & 18% salt</u>

Perforations

<u>Formation</u>	<u>Perforated Interval and Number Shots</u>
<u>Council Grove</u>	<u>2813'-2824', 44 holes, set CIBP @ 2800'</u>
<u>Council Grove</u>	<u>2770'-80', 2740'-44', 2718'-24', 2690'-2702', 2630'-40', 168 holes</u>

Electric Log Run (Show type log and depths covered)

<u>Gamma Guard</u>	<u>1600'- TD</u>
<u>Compensated Acoustic Velocity</u>	<u>1600'- TD</u>

Show Drill Stem Tests,
Well Stimulation and
Production Tests

Formation Top Bottom

Sand & Clay	0	500
Redbed	500	668
Redbed & Shells	668	1080
Shale-Sand-Anhy	1080	1358
Sand-Anhy-Shale	1358	1920
Shale-Lime	1920	2041
Lime - Shale	2041	2877

Perf. 2770'-80', 2740'-44', 2718'-24', 2690'-2702',
2630'-40'

5000 gal. 15% HCl

3000 bbls fresh water w/ friction reducer,
bacteriacide & 100,000# 10-20 sand

Final flow rate of 5,363 MCF/day

CAR. 2608