

State Geological Survey
WICHITA, BRANCH

KANSAS DRILLERS LOG

S. 18 T. 29S R. 7 ^{XX}W

API No. 15 — 095 — 20913
County Number

Loc. 100' E/C NE SW

County Kingman

Operator
Rains & Williamson Oil Co., Inc.

Address
435 Page Court, 220 W. Douglas, Wichita, Kansas 67202

Well No. #1 Lease Name Handkins #1

Footage Location
feet from (N) (S) line feet from (E) (W) line

Principal Contractor Rains & Williamson Oil Co., Inc. Geologist Deane Jirrels

Spud Date 2-16-80 Total Depth 4142' P.B.T.D.

Date Completed 2-26-80 Oil Purchaser

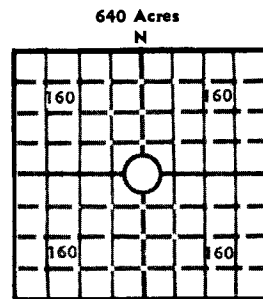

Elev.: Gr. 1561

DF _____ KB 1566

CASING RECORD

Report of all strings set — surface, intermediate, production, etc.

Purpose of string	Size hole drilled	Size casing set (in O.D.)	Weight lbs/ft.	Setting depth	Type cement	Sacks	Type and percent additives
	12 1/4"	8 5/8"	20#	281'	common	215 sx.	3% cc., 2% gel.

LINER RECORD

PERFORATION RECORD

Top, ft.	Bottom, ft.	Sacks cement	Shots per ft.	Size & type	Depth interval

TUBING RECORD

Size	Setting depth	Packer set at

ACID, FRACTURE, SHOT, CEMENT SQUEEZE RECORD

Amount and kind of material used	Depth interval treated

INITIAL PRODUCTION

Date of first production		Producing method (flowing, pumping, gas lift, etc.)			
RATE OF PRODUCTION PER 24 HOURS	Oil	Gas	Water	Gas-oil ratio	
	bbls.	MCF	bbls.	CFPB	
Disposition of gas (vented, used on lease or sold)			Producing interval(s)		

INSTRUCTIONS: As provided in KCC Rule 82-2-125, within 90 days after completion of a well, one completed copy of this Drillers Log shall be transmitted to the State Geological Survey of Kansas, 4150 Monroe Street, Wichita, Kansas 67209. Copies of this form are available from the Conservation Division, State Corporation Commission, 3830 So. Meridian (P.O. Box 17027), Wichita, Kansas 66217. Phone AC 316-522-2206. If confidential custody is desired, please note Rule 82-2-125. Drillers Logs will be on open file in the Oil and Gas Division, State Geological Survey of Kansas, Lawrence, Kansas 66044.

Operator Rains & Williamson Oil Co., Inc.

DESIGNATE TYPE OF COMP.: OIL, GAS, DRY HOLE, SWDW, ETC.: Dry Hole

Well No. #1 Lease Name Habdkins

S 18 T 29 S R 7 W

WELL LOG

Show all important zones of porosity and contents thereof; cored intervals, and all drill-stem tests, including depth interval tested, cushion used, time tool open, flowing and shut-in pressures, and recoveries.

SHOW GEOLOGICAL MARKERS, LOGS RUN, OR OTHER DESCRIPTIVE INFORMATION.

FORMATION DESCRIPTION, CONTENTS, ETC.	TOP	BOTTOM	NAME	DEPTH
DST #1 - 4126-4137, 30 (45) 60 (90). Rec. 60' sl. gassy mud. FP's 52-52, 52-52. IBHP 201, FBHP 232. Temp. 124°			Sample Tops Heebner	3120 (-1554)
DST #2 - 4126-4142, 30 (45) 60 (90). Rec. 90' GIP, 80' gassy mud w/spots oil, 60' muddy saltwater. FP's 73-73, 105-105. IBHP 789, FBHP 1238.			Lansing Miss. RTD	3355 (-1789) 4124 (-2558) 4142 (-2576)

USE ADDITIONAL SHEETS, IF NECESSARY, TO COMPLETE WELL RECORD.

Date Received

Wilson Rains

Signature

President

Title

4-16-80

Date