

KANSAS

Section 21 Township 2 Range 23W

Well No. #1 Kohfeld

Company Empire Drlg

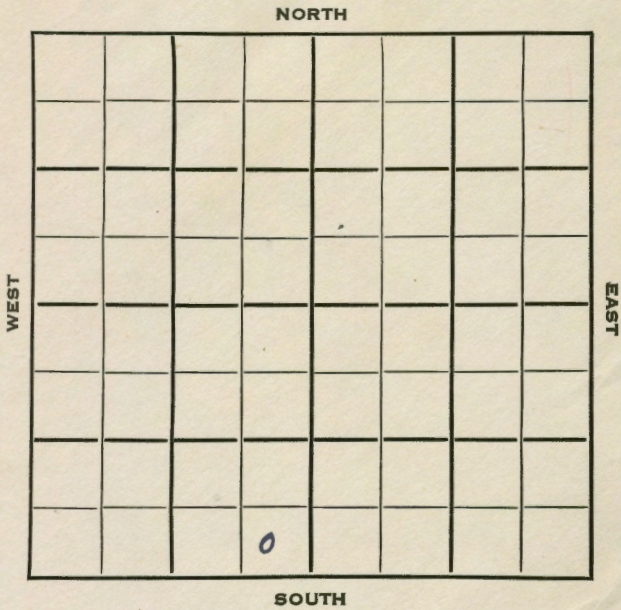

14

SEC. TWP. R. Norton KANSAS

21 2 23 W ✓

WELL NO. # 1 Kohfeld FARM

COMPANY Empire Drlg.

CONTRACTOR Empire Wildcat

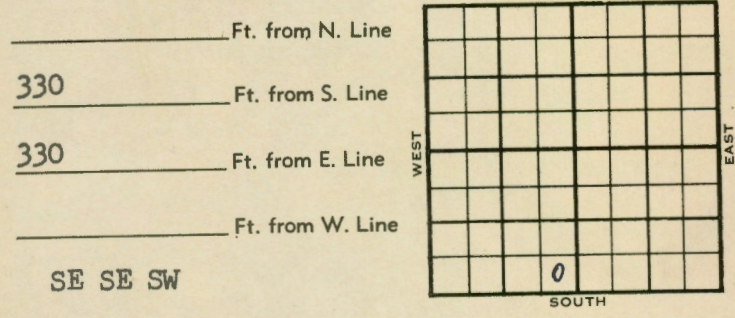

_____ Ft. from N. Line

330 _____ Ft. from S. Line

330 _____ Ft. from E. Line

_____ Ft. from W. Line

SE SE SW

1954 ELEVATION 2362' REPORT

3/17 MIRT
 3/24 8" @ 185 w/115 Heeb 3365
 Tor. 3395' Lans 3410
 Drlg. 3600'

3/31 Spud 3-16-54
 D & a
 TD 3653'
 8" @ 185'
 Heeb 3365', Tor 3395', Lans 3410'
 Arb 3633'
 DST 3635'-40' opn 3/4 hr, rec 15' Mud
 840#
 Gr. Wash 3645', Gr. 3652'
 TD 3653'
 DST 3635'-53' opn 1 hr, rec 30' Mud
 610#
 TD 3653'
 D & A

ABANDONED

County Norton State Kansas
 Sec. 21 (Blk. 2 (Twp. 2 (Sur. 23W (Rge.) Map No.
 Operator Empire Drlg.
 Well No. 1 Farm Kohfeld
 Elev. 2362 Location SE SE SW

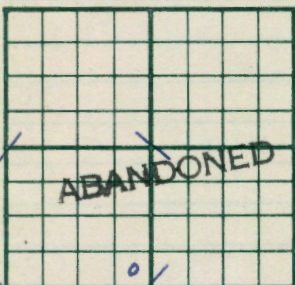

330 Ft. From S Line SW
330 Ft. From E Line Quarter
 Ist. Report
 Completion MAR 31 1954
 Remarks Wildcat
Empire - Contr.
 Spudding Date 3-16-54

Drlg. Data D & A TD 3653
8" @ 185 Heeb. 3365 Tor. 3395
Lans. 3410 Arb. 3633 DST 3635-40
open 3/4 hr. Rec. 15' mud 840#
Gr. wash 3645 Gr. 3652 TD 3653
DST 3635-53 open 1 hr. Rec. 30' mud
610# TD 3653
D & A

J. G. McGEHEE

County Norton State Kansas
 Sec. 21 (Blk. 2 (Twp. 2 (Sur. 23W (Rge.) Map No.
 Operator Empire Drlg.
 Well No. 1 Farm Kohfeld
 Elev. _____ Location SE SE SW

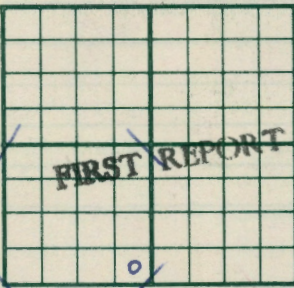

330 Ft. From S Line SW
330 Ft. From E Line Quarter
 Ist. Report MAR 17 1954
 Completion _____
 Remarks _____
Empire - Contr.
 Spudding Date _____

Drlg. Data _____ Wildcat

M I R T

J. G. McGEHEE