

K. G. S. LIBRARY

WELL LOG

35-2-25W

API# 15-137-20,098

COMPANY F & M Oil Company

SEC. 35 T. 2S R. 25W

FARM Coldp

NO. 1

LOG. NE SW NE

RIB. NO. 2

TOTAL DEPTH 3800'

COMM. 12-7-74

COMP. 12-15-74

COUNTY

NOTTON KANSAS

CONTRACTOR Murfin Drilling Company

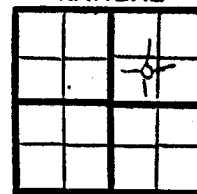

CASING

20	10
15	5/8" @ 236' w/170 SX
12	6
12	5

ELEVATION 2502 KB

PRODUCTION D & A

FIGURES INDICATE BOTTOM OF FORMATIONS

96	Surface soil
218	Sand
930	Shale
1850	Shale & sand
2032	Shale & red bed
2062	Anhydrite
2425	Shale
3015	Shale & lime
3300	Shale
3450	Lime & shale
3800	Lime
3800	TD

LOG TOPS	
Heeb	3422
Tor	3453
Lans	3468
BKC	3662
Cong Sh	3753
Reag Sd	3788
LTD	3800

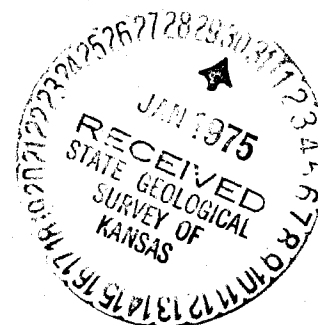

IMPORTANT
Kans. Geo. Survey request
samples on this well.

35-2-25W

S. 35 T. 2 R. 25 ^W

Loc. NE SW NE

County Norton

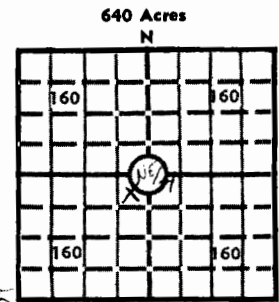

MAY 2 1974

API No. 15 — 137 — 20,098
County Number

Operator
F & M Oil Co., Inc.

Address
603 Union Center Wichita, Kansas

Well # 1 Lease Name Colip

Footage Location
990 feet from (N) (S) line 990 feet from (E) (W) line

Principal Contractor Murfin Drilling Co Geologist E.A. Falkowski

Spud Date 12-7-74 Total Depth 3800 P.B.T.D.

Date Completed 12-14-74 Oil Purchaser

30
Locate well correctly
Elev.: Gr. 2497

DF 2499 KB 2502

CASING RECORD

Report of all strings set — surface, intermediate, production, etc.

Purpose of string	Size hole drilled	Size casing set (in O.D.)	Weight lbs/ft.	Setting depth	Type cement	Sacks	Type and percent additives
surface casing		8-5/8		236	common	170	

LINER RECORD

PERFORATION RECORD

Top, ft.	Bottom, ft.	Sacks cement	Shots per ft.	Size & type	Depth interval

TUBING RECORD

Size	Setting depth	Packer set at

ACID, FRACTURE, SHOT, CEMENT SQUEEZE RECORD

Amount and kind of material used	Depth interval treated

INITIAL PRODUCTION

Date of first production		Producing method (flowing, pumping, gas lift, etc.)			
RATE OF PRODUCTION PER 24 HOURS	Oil bbls.	Gas MCF	Water bbls.	Gas-oil ratio	CFPB
Disposition of gas (vented, used on lease or sold)			Producing interval (s)		

INSTRUCTIONS: As provided in KCC Rule 82-2-125, within 90 days after completion of a well, one completed copy of this Drillers Log shall be transmitted to the State Geological Survey of Kansas, 4150 Monroe Street, Wichita, Kansas 67209. Copies of this form are available from the Conservation Division, State Corporation Commission, 3830 So. Meridian (P.O. Box 17027), Wichita, Kansas 66217. Phone AC 316-522-2206. If confidential custody is desired, please note Rule 82-2-125. Drillers Logs will be on open file in the Oil and Gas Division, State Geological Survey of Kansas, Lawrence, Kansas 66044.

Operator F & M Oil Co., Inc. DESIGNATE TYPE OF COMP.: OIL, GAS, DRY HOLE, SWDW, ETC.: dry hole

Well No. 1 Lease Name Colip

S 35 T 2S R 25 W

WELL LOG

Show all important zones of porosity and contents thereof; cored intervals, and all drill-stem tests, including depth interval tested, cushion used, time tool open, flowing and shut-in pressures, and recoveries.

SHOW GEOLOGICAL MARKERS, LOGS RUN, OR OTHER DESCRIPTIVE INFORMATION.

FORMATION DESCRIPTION, CONTENTS, ETC.	TOP	BOTTOM	NAME	DEPTH
DST #1 3429-75, Open 20", shut in 60". Weak 5" blow. Rec. 3' mud w/specks of oil. FP's 72-72, IBHP 472#, tool did not work on second opening. Preparing to run DST #2, 3475-3515.			Log Tops:	
			Heebner	3422 (-920)
			Toronto	3453 (-951)
			Lansing	3468 (-966)
			B/KC	3662 (-1160)
			Cong. Sh.	3753 (-1286)
			Regan Sd.	3788 (-1286)
			Log TD.	3800 (-1298)
DST #2 3475-3515, open 7-", shut in 30' open 30", shut in 55' Weak 70" blow. Rec. 180' OCM; FP's 80-120, SIP's 904-950. Temps 180.				
DST #3 3520-3555, 20-20-20-20. Weak blow 15". Rec. 40' mud w/specks of oil. FP's 50-72, SIP's 16--104. Temps 108				
DST #4 3549-3615, 45-3 0-45-45. Good blow. Rec. 50' mud, 120' SL.OCM., 300' SL.O.C.M.W. FP's 88-280 BHP's 1057' S.W FP's 112-744, BHP's 1213-1158. Temp 109.				
DST #5 3623-3636, 30-30-30-30. Stron blow. Rec. 1575' S.W. FP's 112-744, BHP'S 1213-1158. Temp. 109.				
DST #6 3642-55, 20-20-20-20. Weak blow (10") Rec. 10' mud. FP's 52-52, BHP's 52-52.				
DST #7 3728-60, 15-15-15-15. Weak 3" blow Rec. 20' mud. FP's 72-72. BHP's 80-77.				
RTD 3800, D& A.				

USE ADDITIONAL SHEETS, IF NECESSARY, TO COMPLETE WELL RECORD.

Date Received	Signature
	Title
	Date