

IMPORTANT
Kans. Geo. Survey request
samples on this well.

Dry Hole
15 039-20451

WICHITA BRANCH
KANSAS DRILLERS LOG

5-2-27W

S. 5 T. 2 R. 27 K
W

API No. 15 — 039 — 20,451
County Number

Loc. SW NE NW

County Decatur

Operator
Murfin Drilling Company

Address
617 Union Center Wichita, Kansas 67202

Well No. #1-5 Lease Name McFee

Footage Location
1650 feet from (N) (S) line 1650 feet from (E) (W) line NW/4

Principal Contractor Geologist
Murfin Drilling Company J. L. Reeves

Spud Date Total Depth P.B.T.D.
3-28-79 3751'

Date Completed Oil Purchaser
4-5-79 none

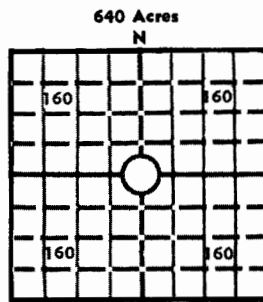

Locate well correctly
Elev.: Gr. 2470'
DF _____ KB 2475'

CASING RECORD

Report of all strings set — surface, intermediate, production, etc.

Purpose of string	Size hole drilled	Size casing set (in O.D.)	Weight lbs/ft.	Setting depth	Type cement	Sacks	Type and percent additives
Surf. Csg.	12 3/4"	8 5/8"	28#	195'	60-40 Pozmix	150	3% CaCl

LINER RECORD

PERFORATION RECORD

Top, ft.	Bottom, ft.	Sacks cement	Shots per ft.	Size & type	Depth interval

TUBING RECORD

Size	Setting depth	Packer set at

ACID, FRACTURE, SHOT, CEMENT SQUEEZE RECORD

Amount and kind of material used	Depth interval treated

INITIAL PRODUCTION

Date of first production		Producing method (flowing, pumping, gas lift, etc.)			
RATE OF PRODUCTION PER 24 HOURS	Oil	Gas	Water	Gas-oil ratio	
	bbls.	MCF	bbls.		CFPB
Disposition of gas (vented, used on lease or sold)			Producing interval (s)		

INSTRUCTIONS: As provided in KCC Rule 82-2-125, within 90 days after completion of a well, one completed copy of this Drillers Log shall be transmitted to the State Geological Survey of Kansas, 4150 Monroe Street, Wichita, Kansas 67209. Copies of this form are available from the Conservation Division, State Corporation Commission, 3830 So. Meridian (P.O. Box 17027), Wichita, Kansas 66217. Phone AC 316-522-2206. If confidential custody is desired, please note Rule 82-2-125. Drillers Logs will be on open file in the Oil and Gas Division, State Geological Survey of Kansas, Lawrence, Kansas 66044.

Operator Murfin Drilling Company DESIGNATE TYPE OF COMP.: OIL, GAS, DRY HOLE, SWDW, ETC.: Dry Hole

Well No. 1-5 Lease Name McFee

S 5 T 2S R 27 W

WELL LOG

Show all important zones of porosity and contents thereof; cored intervals, and all drill-stem tests, including depth interval tested, cushion used, time tool open, flowing and shut-in pressures, and recoveries.

SHOW GEOLOGICAL MARKERS, LOGS RUN, OR OTHER DESCRIPTIVE INFORMATION.

FORMATION DESCRIPTION, CONTENTS, ETC.	TOP	BOTTOM	NAME	DEPTH
Clay and Sand		76'	T/ANHYDRITE	1934'
Shale		196'	B/ANHYDRITE	1966'
Sand		285'	SEVERY	3068'
Sand, Shale, Pyrite		1255'	TOPEKA	3094'
Sand and Shale		1934'	DEER CREEK	3159'
Anhydrite		1966'	OREAD	3198'
Shale		2380'	TORONTO	3243'
Shale and Lime		2930'	L/KC	3256'
Shale		3100'		
Shale and Lime		3277'		
Lime and Shale		3410'		
Shale and Lime		3690'		
Lime, Shale RTD		3751'		
DST #1: 3220-77'/30-60-60-60. Rec. 120' SOCWM. FP: 31/42-52/84#. SIP: 1126-1043#.				
DST #2: 3270-3328'/30-60-60-60. Rec. 2100' SW. FP: 272/710-731/1022#. SIP: 1168-1168#.				
DST #3: 3312-60'/45-45-45-45. Rec. 30' M. FP: 63-63#. SIP: 345-126#.				

USE ADDITIONAL SHEETS, IF NECESSARY, TO COMPLETE WELL RECORD.

Date Received

Wayne Johnston
Signature
Wayne Johnston, Production Manager
Title
June 27, 1979
Date