

OPERATOR JOHN O. FARMER, INC.

ADDRESS P.O. BOX 352, Russell, Kansas

COUNTY Decatur, SEC. 12, TWP. 28, RGE. 28W
COMPANY OPERATING John O. Farmer, Inc.
OFFICE ADDRESS P.O. Box 352, Russell, Kansas
DRILLING STARTED 1/22, 1965 DRILLING FINISHED 2/4, 1965
DATE OF FIRST PRODUCTION _____ COMPLETED _____
WELL LOCATED C $\frac{1}{4}$ NE $\frac{1}{4}$ SW $\frac{1}{4}$, North of South
Line and _____ ft. East of West Line of Quarter Section
Elevation (Relative to sea level) DERRICK FLOOR 2555' GROUND, 2552'
CHARACTER OF WELL (Oil, gas or dryhole) Oil

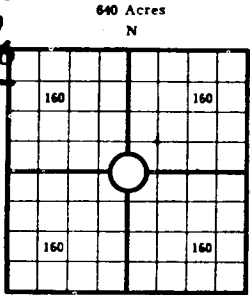

Locate well correctly

OIL OR GAS SANDS OR ZONES

Name	From	To	Name	From	To
1			4		
2			5		
3			6		

Perforating Record If Any

Shot Record

Formation	From	To	No. of Shots	Formation	From	To	Size of Shot

CASING RECORD

Amount Set								Amount Pulled		Packer Record	
Size	Wt.	Thds.	Make	Ft.	In.	Ft.	In.	Size	Length	Depth Set	Make

Liner Record: Amount _____ Kind _____ Top _____ Bottom _____

CEMENTING AND MUDDING

Size	Amount Set		Sacks Cement	Chemical		Method of Cementing	Amount	Mudding Method	Results (See Note)
	Ft.	In.		Gal.	Make				
8 5/8	148'		110	sz					
1 1/2"	3639'		100	sz					

Note: What method was used to protect sands if outer strings were pulled? _____

NOTE: Were bottom hole plugs used? _____ If so, state kind, depth set and results obtained _____

TOOLS USED

Rotary Tools were used from 0 feet to R.T.D. Cable tools were used from _____ feet to _____ feet, and from _____ feet to _____ feet, and from _____ feet to _____ feet

Type Rig Rotary

INITIAL PRODUCTION TEST

Describe initial test: whether by flow through tubing or casing or by pumping _____

Amount of Oil Production _____ bbls. Size of choke, if any _____ Length of test _____ Water

Production _____ bbls. Gravity of oil _____ Type of Pump if pump is used, describe _____

FORMATION RECORD

Give detailed description and thickness of all formation drilled through, contents of sand, whether dry, water, oil or gas.

Formation	Top	Bottom	State Geological Survey WICHITA, BRANCH
Surface		215	
Shale & Sand	215	2035	
Shale & Redbed	2035	2128	
Anhydrite	2128	2160	
Shale & Shells	2160	2390	
Shale	2390	2780	
Shale & Lime	2780	3160	
Lime & Shale	3160	3455	
Lime	3455	3530	
Lime & Shale	3530	3540	
Lime	3540	3640	
T.D.	3640		

Sample Tops

Anhydrite	2138'
Reebmer	3396'
Lansing K.C.	3440'
Rotary T.D.	3640'



12-25-28W

I, the undersigned, being first duly sworn upon oath, state that this well record is true, correct and complete according to the records of this office and to the best of my knowledge and belief.

John O. Farmer
Name and title of representative of company
President

Subscribed and sworn to before me this 8 day of February, 1965

My Commission expires 2/15/67

Helen Carlson
Notary Public

Helen Carlson

WELL NO. 2 COUNTY Decatur TWP. 28 RGE. 28W NAME ANNA