

12-2-280
NE SW NE

KANSAS

API# 15-039-20, 172

FARM NAME REEVES GEOLOGICAL SOCIETY WELL NO. 2 COUNTY Decatur TWP. 2S RGE. 28W

OPERATOR John O. Farmer, Inc.

ADDRESS Box 352, Russell, Kansas

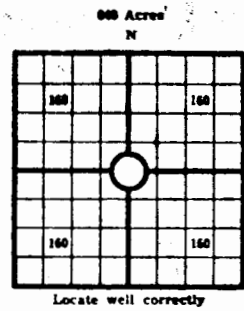

COUNTY Decatur SEC 12 TWP 2S RGE 28W
 COMPANY OPERATING John O. Farmer, Inc.
 OFFICE ADDRESS Box 352, Russell, Ks.
 DRILLING STARTED 7/30/70 DRILLING FINISHED 8/5/70
 DATE OF FIRST PRODUCTION _____ COMPLETED _____
 WELL LOCATED NE 1/4 SW 1/4 NE 1/4, North of South
 Line and _____ ft. East of West Line of Quarter Section
 Elevation (Relative to sea level) DERRICK FLOOR 2483 GROUND 2480
 CHARACTER OF WELL (Oil, gas or dryhole) Dryhole

1	2	3
4	5	6
7	8	9
10	11	12

OIL OR GAS SANDS OR ZONES					
Name	From	To	Name	From	To

Perforating Record If Any				Shot Record			
Formation	From	To	No. of Shots	Formation	From	To	Size of Shot

CASING RECORD											
Amount Set						Amount Pulled			Packer Record		
Size	Wt.	Thds.	Make	Ft.	In.	Ft.	In.	Size	Length	Depth Set	Make

CEMENTING AND MUDDING											
Size	Amount Set		Sacks	Chemical		Method of	Amount	Mudding	Method	Results	(See Note)
	Ft.	In.	Cement	Gal.	Make	Cementing					
5/8"	203'	135									

Note: What method was used to protect sands if outer strings were pulled?

NOTE: Were bottom hole plugs used? If so, state kind, depth set and results obtained

TOOLS USED
 Rotary Tools were used from 0 feet to R.T.D. Cable tools were used from _____ feet to _____ feet, and from _____ feet to _____ feet, and from _____ feet to _____ feet.
 Type Rig Rotary

INITIAL PRODUCTION TEST
 Describe initial test: whether by flow through tubing or casing or by pumping.
 Amount of Oil Production _____ bbls. Size of choke, if any _____ Length of test _____ Water
 Production _____ bbls. Gravity of oil _____ Type of Pump if pump is used, describe _____

FORMATION RECORD

Give detailed description and thickness of all formation drilled through, contents of sand, whether dry, water, oil or gas.

Formation	Top	Bottom	Formation	Top	Bottom
Sand Clay		163			
Shale, Shells	163	623			
Sand	623	665			
Shale shells	665	950			
Sand shale	950	1870			
Redbed shale	1870	2064			
Anhydrite	2064	2104			
Shale	2104	2720			
Lime shale	2720	2820			
Shale lime	2820	3300			
Lime shale	3300	3400			
Lime	3400	3460			
R.T.D.	3460				

Log Tops
 Heebner 3327'
 Lansing 3371'
 Total Depth 3460'

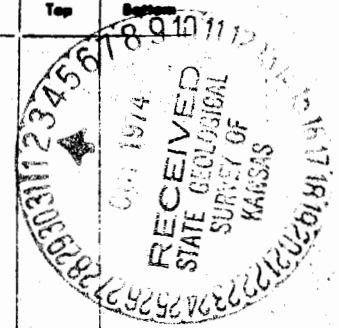

I, the undersigned, being duly sworn upon oath, state that this well record is true, correct and complete according to the records of this office and to the best of my knowledge and belief.
John O. Farmer
 Name and title of representative of company President
 Subscribed and sworn to before me this 10th day of August, 1970
Helen Carlson
 My Commission expires 5/71 Helen Carlson Notary Public.

12-2-280