

35-2-30W

KANSAS DRILLERS LOG

State Geological Survey
WICHITA, BRANCH

S. 35 T. 2 R. 30 ^R/_W
Loc. 440' SNL & 440' WEL NE

API No. 15 — 039 — 20,297
County Number

County Decatur

Operator
A. L. Abercrombie, Inc.

Address
801 Union Center Wichita, Kansas 67202

Well No. #3 Lease Name Berndt

Footage Location
440 feet from (N) ^X/_S line 440 feet from (E) ^X/_W line

Principal Contractor Abercrombie Drilling, Inc. Geologist Jack K. Wharton

Spud Date December 3, 1974 Total Depth 4130' P.B.T.D. 4095'

Date Complete January 4, 1975 Oil Purchaser Koch Oil

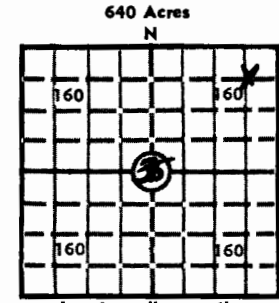

Locate well correctly
Elev.: Gr. 2816

DF 2822 KB 2824

CASING RECORD

Report of all strings set — surface, intermediate, production, etc.

Purpose of string	Size hole drilled	Size casing set (in O.D.)	Weight lbs/ft.	Setting depth	Type cement	Socks	Type and percent additives
Surface	12 1/4"	8-5/8"		245'	Sunset	150	None
Production		4-1/2"		4129'	50/50 Pos.	50	12 1/2# Gilsonite 2% Gel
					Common	100	2% gel, 10% salt 4# Friction Reduc.

LINER RECORD

PERFORATION RECORD

Top, ft.	Bottom, ft.	Socks cement	Shots per ft.	Size & type	Depth interval
			1		4029' & 4002'
			4		3883-3886

TUBING RECORD

ACID, FRACTURE, SHOT, CEMENT SQUEEZE RECORD

Amount and kind of material used	Depth interval treated
Acid 1500 Gal. 15% Non-E	4029' & 4002'
Acid 1500 Gal. Non-E	3883-3886

INITIAL PRODUCTION

Date of first production <u>January 30, 1974</u>	Producing method (flowing, pumping, gas lift, etc.) <u>Pumping</u>
RATE OF PRODUCTION PER 24 HOURS	Oil <u>7</u> bbls. Gas <u>68%</u> bbls. Water <u>MCF</u> Gas-oil ratio <u>CFPB</u>
Disposition of gas (vented, used on lease or sold)	Producing interval (s) <u>3883-3886</u>

INSTRUCTIONS: As provided in KCC Rule 82-2-125, within 90 days after completion of a well, one completed copy of this Drillers Log shall be transmitted to the State Geological Survey of Kansas, 4150 Monroe Street, Wichita, Kansas 67209. Copies of this form are available from the Conservation Division, State Corporation Commission, 3830 So. Meridian (P.O. Box 17027), Wichita, Kansas 66217. Phone AC 316-522-2206. If confidential custody is desired, please note Rule 82-2-125. Drillers Logs will be on open file in the Oil and Gas Division, State Geological Survey of Kansas, Lawrence, Kansas 66044.

Operator

Abercrombie Drilling, Inc.

DESIGNATE TYPE OF COMP.: OIL, GAS, DRY HOLE, SWDW, ETC.:

Well No.

#3

Lease Name

Berndt

Oil

S 35 T 2S R 30 E W

WELL LOG

Show all important zones of porosity and contents thereof; cored intervals, and all drill-stem tests, including depth interval tested, cushion used, time tool open, flowing and shut-in pressures, and recoveries.

SHOW GEOLOGICAL MARKERS, LOGS RUN, OR OTHER DESCRIPTIVE INFORMATION.

FORMATION DESCRIPTION, CONTENTS, ETC.	TOP	BOTTOM	NAME	DEPTH
Clay & Sand	0	250	<u>ELECTRIC LOG:</u>	
Shale	250	932		
Shale & Sand	932	1900	Anhydrite	2590
Shale	1900	2365	B/Anhydrite	2620
Sand	2365	2514	Heebner	3800
Shale	2514	2589	Toronto	3836
Anhydrite	2589	2621	Lansing	3849
Shale	2621	2990	B/Kansas City	4078
Lime & Shale	2990	3895	ELTD	4091
Lime	3895	4090		
Lime & Shale	4090	4130		
Rotary Total Depth		4130		
<p>DST #1 (3806-3859) 30", 30", 30", 30" Weak Blow for 25" & died. Recovered 10' drilling mud. IFP 11-11#; IBHP 142#; FFP 23-23#; FBHP 71#.</p> <p>DST #2 (3858-3900) 30", 45", 60", 60" Strong blow. Recovered 390' GIP, 140' free oil, 70' OCM. IFP 23-47#; IBHP 379#; FFP 71-82#; FBHP 319#.</p> <p>DST #3 (Straddle) (3970-4034) 15", 45", 60", 60". Strong blow. Recovered 225' HOCM and 120' OCM. IFP 47-82#; IBHP 1171#; FFP 106-109#; FBHP 846#.</p>				

USE ADDITIONAL SHEETS, IF NECESSARY, TO COMPLETE WELL RECORD.

Date Received



Jack L. Partridge

Jack L. Partridge Signature
Office Manager

Title

March 12, 1975

Date