

36-2-30W

KANSAS

WELL COMPLETION REPORT AND DRILLER'S LOG

State Geological Survey

S. 36 T. 2S R. 30E  
 WICHITA, KANSAS  
 Loc. SE NE NW  
 County Decatur

API No. 15 — 039 — 20528  
 County Number

Operator  
 Tenneco Oil Company

Address Suite 139, Ciudad Bldg., 3000 United Founders Blvd.  
 Oklahoma City, Oklahoma, 73112

Well No. 3-36 Lease Name Rogers

Footage Location  
 1210 feet from (N) line 2135 feet from (W) line

Principal Contractor Emphasis #1 Geologist -

Spud Date 10-18-80 Date Completed 12-2-80 Total Depth 4074 P.B.T.D. 3927

Directional Deviation - Oil and/or Gas Purchaser Unknown

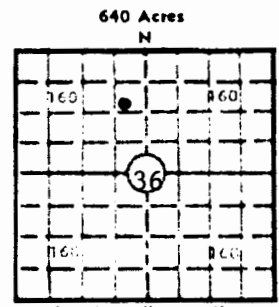

Locate well correctly  
 Elev.: Gr. 2804  
 DF N/A KB N/A

CASING RECORD

Report of all strings set — surface, intermediate, production, etc.

Purpose of string	Size hole drilled	Size casing set (in O.D.)	Weight lbs/ft.	Setting depth	Type cement	Sacks	Type and percent additives
Surface	10-1/4"	8-5/8"	24#	615	60/40 poz Class H	250 200	3% CaCl 2% Gel
Production	7-7/8"	5-1/2"	15.5#	3957	60:40 poz	1050	5% Gel

LINER RECORD

PERFORATION RECORD

Top, ft.	Bottom, ft.	Sacks cement	Shots per ft.	Size & type	Depth interval
-	-	-	1	.3 - jet	3848-52

Size	Setting depth	Packer set at
2-7/8"	3897	-

ACID, FRACTURE, SHOT, CEMENT SQUEEZE RECORD

Amount and kind of material used	Depth interval treated
1750 gal. 15% HCL + 5% Acetic Acid	3848-52

INITIAL PRODUCTION

Date of first production 12-2-80	Producing method (flowing, pumping, gas lift, etc.) Pumping
RATE OF PRODUCTION PER 24 HOURS	Oil 83 bbls. Gas - MCF Water - bbls. Gas-oil ratio - CFPB
Disposition of gas (vented, used on lease or sold) None	Producing interval(s) 3848-52

INSTRUCTIONS: As provided in KCC Rule 82-2-125, within 90 days after completion of a well, one completed copy of this Drillers Log shall be transmitted to the State Geological Survey of Kansas, 4150 Monroe Street, Wichita, Kansas 67209. Copies of this form are available from the Conservation Division, State Corporation Commission, 245 No. Water, Wichita, Kansas 67202. Phone AC 316-522-2206. If confidential custody is desired, please note Rule 82-2-125. Drillers Logs will be on open file in the Oil and Gas Division, State Geological Survey of Kansas, Lawrence, Kansas 66044.

Operator Tenneco Oil Company		DESIGNATE TYPE OF COMP.: OIL, GAS, DRY HOLE, SWDW, ETC.: Oil
Well No. 3-36	Lease Name Rogers	
S 36 T 2S R 30 <sup>25K</sup> W		

**WELL LOG**

Show all important zones of porosity and contents thereof; cored intervals, and all drill-stem tests, including depth interval tested, cushion used, time tool open, flowing and shut-in pressures, and recoveries.

SHOW GEOLOGICAL MARKERS, LOGS RUN, OR OTHER DESCRIPTIVE INFORMATION.

FORMATION DESCRIPTION, CONTENTS, ETC.	TOP	BOTTOM	NAME	DEPTH
Soil & Clay	40			
Sand & Shale	1850			
Shale & Sand	2680			
Shale	3480			
Shale & Lime	3852			
Lime & Shale	3995			
Lime (R.T.D.)	4079			

USE ADDITIONAL SHEETS, IF NECESSARY, TO COMPLETE WELL RECORD.

Date Received	<i>Allen D. Ashley</i>
	Signature
	Allen D. Ashley, Administrative Supervisor
	Title
	December 9, 1980
	Date