

KANSAS DRILLERS LOG

State Geological Survey
WICHITA, BRANCH

29-2-35W

S. 29 T. 2S R. 35 ^{SEX}
_W
Loc. (150' SE) C NW NW

API No. 15 — 153 — 20265
County Number

County Rawlins

Operator
Murfin Drilling Company

Address
617 Union Center, Wichita, Kansas 67202

Well No. 1 Lease Name SEBERGER

Footage Location
766 feet from (N) (X) line 766 feet from (X) (W) line NW/4

Principal Contractor Murfin Drilling Geologist Roger Welty

Spud Date 9/28/76 Total Depth 4790' P.B.T.D. 4434'

Date Completed 10/11/76 Oil Purchaser Clear Creek

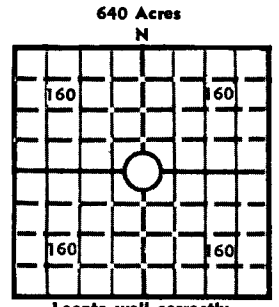

APR 07 1977

Elev.: Gr. 3262'

DF _____ KB _____

CASING RECORD

Report of all strings set — surface, intermediate, production, etc.

Purpose of string	Size hole drilled	Size casing set (in O.D.)	Weight lbs/ft.	Setting depth	Type cement	Sacks	Type and percent additives
Surface	12 1/4	8 5/8"	24#	377'	60/40 Pozmix	235	
Production	7 7/8	5 1/2"	14#	4478'	Class "A" Latex	150 50	

LINER RECORD

PERFORATION RECORD

Top, ft.	Bottom, ft.	Sacks cement	Shots per ft.	Size & type	Depth interval
			4	DPJ/reactive	4274-75'
				liners	4263-67'
					4251-55'
					4240-44'

TUBING RECORD

Size	Setting depth	Packer set at
2"	4267.56'	--

ACID, FRACTURE, SHOT, CEMENT SQUEEZE RECORD

Amount and kind of material used	Depth interval treated
No acid	

INITIAL PRODUCTION

Date of first production 1/2/77 Producing method (flowing, pumping, gas lift, etc.) Pumping

RATE OF PRODUCTION PER 24 HOURS
Oil 155 bbls. Gas _____ MCF Water -- bbls. Gas-oil ratio _____ CFPB

Disposition of gas (vented, used on lease or sold) _____ Producing interval(s) _____

INSTRUCTIONS: As provided in KCC Rule 82-2-125, within 90 days after completion of a well, one completed copy of this Drillers Log shall be transmitted to the State Geological Survey of Kansas, 4150 Monroe Street, Wichita, Kansas 67209. Copies of this form are available from the Conservation Division, State Corporation Commission, 3830 So. Meridian (P.O. Box 17027), Wichita, Kansas 66217. Phone AC 316-522-2206. If confidential custody is desired, please note Rule 82-2-125. Drillers Logs will be on open file in the Oil and Gas Division, State Geological Survey of Kansas, Lawrence, Kansas 66044.

Operator Murfin Drilling

DESIGNATE TYPE OF COMP.: OIL, GAS, DRY HOLE, SWDW, ETC.:
Dry Hole

Well No.
1

Lease Name
SEBERGER

S 29 T 2s R 35 ^{EX}_W

WELL LOG

Show all important zones of porosity and contents thereof; cored intervals, and all drill-stem tests, including depth interval tested, cushion used, time tool open, flowing and shut-in pressures, and recoveries.

SHOW GEOLOGICAL MARKERS, LOGS RUN, OR OTHER DESCRIPTIVE INFORMATION.

FORMATION DESCRIPTION, CONTENTS, ETC.	TOP	BOTTOM	NAME	DEPTH
clay, sand, shale		300	ANHY top	3108 +159
clay, sand		355	base	3142 -125
shale		1600	TOPEKA	3988 -721
shale, sand		2470	OREAD	4086 -819
shale, pyrite		2700	LKC	4181 -914
shale, shells		3640	BKC	4472 -1205
shale, lime		3785	CHER. SAND	4698 -1431
shale, shells		3990	LTD	4794 -1527
shale, lime		4220		
lime		4320		
lime, shale		4352		
lime		4405		
lime, shale		4790		
RTD		4790		
DST #1: 4163-4204/30-30-30-30, 65' SOCM, SIP 681-669, FP 50-75, 130°.				
DST #2: 4244-57/45-45-30-45, 320' MSlight show oil, SIP 1357-1345, FP 188-200.				
DST #3: 4200-57/30-45-30-45, st bl off btm, 570' GIP + 1710' MGO, 33° Gr. @ 700, SIP 1297-1273, FP 548-729, 132°.				
DST #4: 4271-4304/30-45-30-45, fr bl, 480' MO, SIP 1092-995, FP 50-225#.				
DST #5: 4304-20/30-45-30-45, st bl, 2970' SW, SIP 1406-1406, FP 500-1406, 44°.				
DST #6: 4316-52/45-45-30-45, 90' WM, SIP 1309-1273, FP 38-75, 144°.				
DST #7: 4350-4400/45-45-30-45, 60' M, SIP 1357-1333, FP 50-53, 144°.				

USE ADDITIONAL SHEETS, IF NECESSARY, TO COMPLETE WELL RECORD.

Date Received

Wm. S. Shropshire
Signature

Wm. S. Shropshire, Asst. Gen. Manager

Title

January 5, 1977

Date

218L67