

State Geological Survey  
WICHITA, BRANCH

Released 1-7-75  
**CONFIDENTIAL**

**KANSAS DRILLERS LOG**

S. 29 T. 30 R. 18 <sup>Ex</sup><sub>W</sub>  
Loc. C NE SW  
County Kiowa

API No. 15 — 097 — 20,180  
County Number

Operator  
Okmar Oil Company

Address 1130 Vickers KSB&T Building  
Wichita, Kansas

Well No. #3 Lease Name Cobb

Footage Location  
1980 feet from ~~X~~ (S) line 1980 feet from ~~X~~ (W) line

Principal Contractor DNB Drilling, Inc. Geologist Harold Steincamp

Spud Date October 23, 1973 Total Depth 5042 P.B.T.D.

Date Completed November 3, 1973 Oil Purchaser Derby Refg. Co.

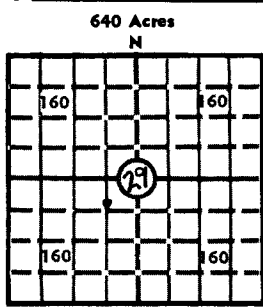

Locate well correctly  
Elev.: Gr. 2167  
DF \_\_\_\_\_ KB 2172

**CASING RECORD**

Report of all strings set — surface, intermediate, production, etc.

Purpose of string	Size hole drilled	Size casing set (in O.D.)	Weight lbs/ft.	Setting depth	Type cement	Sacks	Type and percent additives
Surface		13-3/8		423	60/40 Poz.	400	2% Gel, 3% C.C.
Surface	12 1/2	8-5/8		925	60/40 Poz.	200	3% C.C.
Production	7-7/8	5-1/2		5037	60/40 Poz.	150	18% Salt

**LINER RECORD**

**PERFORATION RECORD**

Top, ft.	Bottom, ft.	Sacks cement	Shots per ft.	Size & type	Depth interval
					5037 - 42

Size	Setting depth	Packer set at

**ACID, FRACTURE, SHOT, CEMENT SQUEEZE RECORD**

Amount and kind of material used	Depth interval treated
500 gal, 15% regular	5037 - 42

**INITIAL PRODUCTION**

Date of first production <u>1/28/74</u>	Producing method (flowing, pumping, gas lift, etc.) <u>pumping</u>
RATE OF PRODUCTION PER 24 HOURS	Oil <u>50</u> bbls. Gas <u>-0-</u> MCF Water <u>-0-</u> bbls. Gas-oil ratio <u>-0-</u> CFPB
Disposition of gas (vented, used on lease or sold)	Producing interval (s) <u>5037 - 42</u>

INSTRUCTIONS: As provided in KCC Rule 82-2-125, within 90 days after completion of a well, one completed copy of this Drillers Log shall be transmitted to the State Geological Survey of Kansas, 4150 Monroe Street, Wichita, Kansas 67209. Copies of this form are available from the Conservation Division, State Corporation Commission, 3830 So. Meridian (P.O. Box 17027), Wichita, Kansas 66217. Phone AC 316-522-2206. If confidential custody is desired, please note Rule 82-2-125. Drillers Logs will be on open file in the Oil and Gas Division, State Geological Survey of Kansas, Lawrence, Kansas 66044.

Operator

Okmar Oil Company

DESIGNATE TYPE OF COMP.: OIL, GAS, DRY HOLE, SWDW, ETC.:

Oil

Well No.

3

Lease Name

Cobb

S 29 T 30S R 13 W

WELL LOG

Show all important zones of porosity and contents thereof; cored intervals, and all drill-stem tests, including depth interval tested, cushion used, time tool open, flowing and shut-in pressures, and recoveries.

SHOW GEOLOGICAL MARKERS, LOGS RUN, OR OTHER DESCRIPTIVE INFORMATION.

FORMATION DESCRIPTION, CONTENTS, ETC.	TOP	BOTTOM	NAME	DEPTH
#1 15/45/60/45 weak blow Rec. 60' mud 312/303 66/85	4840	4920	Anhydrite Herington Cottonwood Indian Cave Howard	1101-1130 2515 3056 3440 3718
#2 15/30/30/30 weak blow - 15 min. Rec. 10' mud 114/114 47/95	4993	5022	Heebner Brown Lime Lansing B. Kansas City Cherokee	4183 4357 4376 4760 4941
#3 15/60/90/60 strong blow, gas to surface - 40 min. gauged 8,000 - 15,000 CFG & surging Rec. 180' OGCM, 150' HOGCM, 120' MCO 1491/1482 57/312	4993	5042	Mississippi Lm Mississippi Dolo	5004 5038

USE ADDITIONAL SHEETS, IF NECESSARY, TO COMPLETE WELL RECORD.



*Don W. Beauchamp*  
Signature

Don W. Beauchamp - Geologist  
Title

1-28-74  
Date

OK-100-1117

Wichita, Kansas

DRILLERS' LOG

29-30-18W

CNE SW NEAS

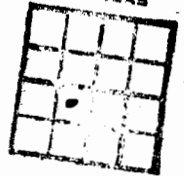

**OKMAR OIL COMPANY**  
 No. 3 Cobb  
 C NE SW, Sec. 29-30S-18W  
 Kiowa County, Kansas

APL#15-097-20,180

Elevation: 2172 K.B.

Commenced: 10-23-73  
 Completed: 11- 3-73

Surface: 425' of 13-3/8" cemented  
 w/400 sx 60-40 Posmix, 3% cc. 10-23-  
 914' of 8-5/8" cemented w/200 sx  
 60-40 Posmix, 3% cc. 10-25-73

FORMATION

DEPTH

<u>FORMATION</u>	<u>DEPTH</u>	SMP TOPS	
Surface Hole	0 - 423	ANH	1101
Shale	423 - 730	HERR	2515
Shale & Sand	730 - 925	COTTONWD	3056
Red Bed	925 - 1101	IND CV	3440
Anhydrite	1101 - 1130	HOW	3718
Shale	1130 - 2305	HEEB	4183
Lime & Shale	2305 - 3705	BR LM	4357
Lime	3705 - 3890	LANS	4376
Lime & Shale	3890 - 4255	BKC	4760
Lime	4255 - 4878	CHER	4941
Lime & Chert	4878 - 4920	MISS LS	5004
Lime	4920 - 5042 T.D.	MISS DOL	5038
		TD	5042

I do hereby certify that the foregoing statements are true and correct to the best of my knowledge and belief.

D N B DRILLING, INC.

*James L. Donelson*  
 JAMES L. DONELSON



STATE OF KANSAS: ss:

Subscribed and sworn to before me, the undersigned, a Notary Public in and for said state, this 9th day of November, 1973.

My Commission Expires:  
 August 25, 1976

*Ella Priess*

Ella Priess, Notary Public

*Ella Priess*  
 STATE NOTARY PUBLIC  
 Sedgwick County, Kansas  
 My Com. Expires Aug. 25, 1976