

10/4/84
KCC

SIDE ONE

STATE CORPORATION COMMISSION OF KANSAS
OIL & GAS CONSERVATION DIVISION

WELL COMPLETION OR RECOMPLETION FORM
ACO-1 WELL HISTORY

DESCRIPTION OF WELL AND LEASE

Operator: License # 5317
Name Continental Energy
Address South Star Route
City/State/Zip Garden City, KS 67846

Purchaser Inland Crude & Northern Natural
Wichita, KS Omaha, NE

Operator Contact Person Russell Freeman
Phone (316) - 276-8710

Contractor: License # 5987
Name Service Drilling

Wellsite Geologist Ron Osterbuhr
Phone 275-7888

Designate Type of Completion
 New Well Re-Entry Workover
 Oil SWD Temp Abd
 Gas Inj Delayed Comp.
 Dry Other (Core, Water Supply etc.)

If OWWO: old well info as follows:
Operator n/a
Well Name n/a
Comp. Date n/a Old Total Depth n/a

WELL HISTORY

Drilling Method:
 Mud Rotary Air Rotary Cable
9/11/84 9/23/84 10/04/84
Spud Date Date Reached TD Completion Date
5600 5600
Total Depth PBT

Amount of Surface Pipe Set and Cemented at 1801 feet
Multiple Stage Cementing Collar Used? Yes No
If yes, show depth set.....feet
If alternate 2 completion, cement circulated
from...n/a...feet depth to...n/a...w./n/a SX cmt

API NO. 15-081-20,232
County Haskell
C SE NE Sec. 26 Twp. 30S Rge. 34 East West

3300 Ft North from Southeast Corner of Section
660 Ft West from Southeast Corner of Section
(Note: Locate well in section plat below)

Lease Name Liz Smith Well # 3

Field Name Victory

Producing Formation St. Louis

Elevation: Ground 2966 KB 2975

Section Plat

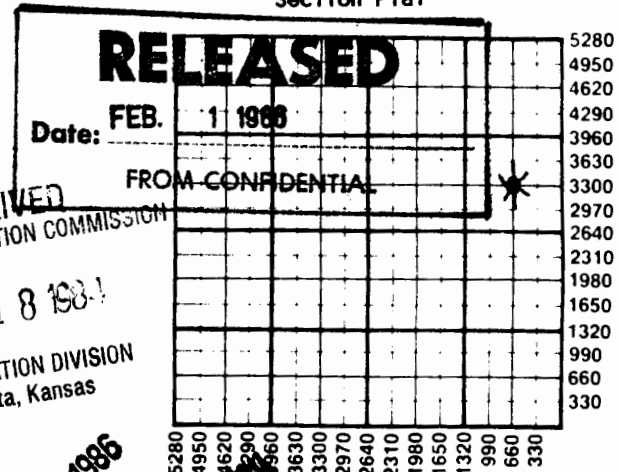

WATER SUPPLY INFORMATION
Disposition of Produced Water: Disposal Repressuring
Docket # 35

Persons on this portion of the ACO-1 call:
Water Resources Board (913) 296-3717

Source of Water:
Division of Water Resources Permit #...n/a...
 Groundwater.....Ft North from Southeast Corner
(Well)Ft West from Southeast Corner of
Sec Twp Rge East West
 Surface Water.....Ft North from Southeast Corner
(Stream, pond etc).....Ft West from Southeast Corner
Sec Twp Rge East West
 Other (explain). Purchased from farmer.....
(purchased from city, R.W.D. #)

INSTRUCTIONS: This form shall be completed in duplicate and filed with the Kansas Corporation Commission, 200 Colorado Derby Building, Wichita, Kansas 67202, within 90 days after completion or recompletion of any well. Rule 82-3-130 and 82-3-107 apply.
Information on side two of this form will be held confidential for a period of 12 months if requested in writing and submitted with the form. See rule 82-3-107 for confidentiality in excess of 12 months.
One copy of all wireline logs and drillers time log shall be attached with this form. Submit CP-4 form with all plugged wells. Submit CP-111 form with all temporarily abandoned wells.

SIDE TWO

Operator Name Continental Energy Lease Name Liz Smith Well # 3

Sec. 26 Twp. 30S Rge. 34 East West County Haskell

Estimated Production Per 24 Hours	Oil	Gas	Water	Gas-Oil Ratio	Gravity
	no test Bbls	no test MCF	no test Bbls	no test CFPB	no test

Drill Stem Tests Taken Yes No
 Samples Sent to Geological Survey Yes No
 Cores Taken Yes No

Formation Description
 Log Sample

	0	990
Sand, Red Bed	0	990
Sand, Gyp.	990	1802
Shale, Lime	1802	2525
Shale, Lime	2525	2854
Shale, Lime	2854	3075
Shale, Lime	3075	3537
Shale, Lime	3537	4120
Shale, Lime	4120	4585
Shale, Lime	4585	4655
Shale, Lime	4655	4999
Shale, Lime	4999	5278
Shale, Lime	5278	5345
Shale, Lime	5345	5600 RTD

Name Top Bottom

DST #1 - 4586-4629-30/60/60/75-1st open 64/96 SIP 899, 2nd flow 64/96 SIP 899, 12" blow off bottom of bucket, recovered 720' of GIP, 185' of GCDM

DST #2 - 5250-5345-30/45/60/75-1st open flow 544.4/487.5 SIP 1427.2, 2nd open flow 470.7/418.3, SIP 1391.1, strong blow 12" in bucket, recovered 360' GCDM

METHOD OF COMPLETION

Production Interval

Disposition of gas: Vented Open Hole Perforation Sold Other (Specify) 5491-5499
 Used on Lease Dually Completed 5430-5484

Surface	12%	8.5/8	24	1801	Howco lite 550	2% c.c.
					Class H. 150	3% c.c.
Production	7.7/8	5 1/2	15.5	5600	Howco lite 200	10% salt
					50-50 poz 200	10% salt

PERFORATION RECORD		Acid, Fracture, Shot, Cement Squeeze Record	
Shots Per Foot	Specify Footage of Each Interval Perforated	(Amount and Kind of Material Used)	Depth
3	5491-5499	1500 gal. 28% MCA	5491-5499
1	5430-5484	24 bbl. 2% KCL water	5430-5484

TUBING RECORD Size 2" Set At 5402.2 Packer at 5406 Liner Run Yes No

Date of First Production _____ Producing Method Flowing Pumping Gas Lift Other (explain).....
 Shut in Shut in