

**WELL COMPLETION REPORT AND  
DRILLER'S LOG**

S. 13 T. 30S R. 35 x W

API No. 15 — 067 — 20,564 **AUG 8 0 RECD**  
County Number

Loc. NW NE  
County Grant

Operator  
**Anadarko Production Company** *State Geological Survey*

Address  
**Box 351, Liberal, Kansas 67901** **WICHITA, BRANCH**

Well No. 4 Lease Name STANLEY "A"

Footage Location  
660 feet from (N) X55 line 1980 feet from (E) X 2000 line

Principal Contractor Lohmann-Johnson Drlg Co., Inc. Geologist Joe Blair

Spud Date 10/6/79 Date Completed 6/30/80 Total Depth 5830' P.B.T.D. 1540'

Directional Deviation not applicable Oil and/or Gas Purchaser SWD

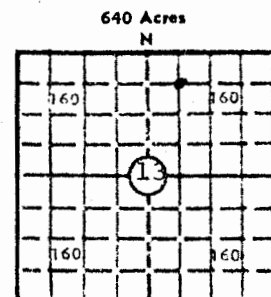

Locate well correctly  
Elev.: Gr. 296'  
DF 2976' KB 2978'

**CASING RECORD**

Report of all strings set — surface, intermediate, production, etc.

Purpose of string	Size hole drilled	Size casing set (in O.D.)	Weight lbs/ft.	Setting depth	Type cement	Sacks	Type and percent additives
Surface	12-1/4"	8-5/8"	24#	1701	Poz Common	600 200	4% gel, 2% CaCl 3% CaCl

**LINER RECORD**

**PERFORATION RECORD**

Top, ft.	Bottom, ft.	Sacks cement	Shots per ft.	Size & type	Depth interval
			2	.46	1248-1288'

**TUBING RECORD**

Size	Setting depth	Packer set at
2-3/8"	1204'	1208'

**ACID, FRACTURE, SHOT, CEMENT SQUEEZE RECORD**

Amount and kind of material used	Depth interval treated
A/2500 gal 7-1/2% HCl	1248-1288'

**INITIAL PRODUCTION**

SALT WATER DISPOSAL WELL		Date of first <del>production</del> injection <u>TEST 7/30/80</u>	Producing method (flowing, pumping, gas lift, etc.) <u>Injected 1 BPM on Vac.</u>	
RATE OF PRODUCTION PER 24 HOURS	Oil bbls.	Gas MCF	Water bbls.	Gas-oil ratio CFPB
Disposition of gas (vented, used on lease or sold)			Producing interval(s)	

INSTRUCTIONS: As provided in KCC Rule 82-2-125, within 90 days after completion of a well, one completed copy of this Drillers Log shall be transmitted to the State Geological Survey of Kansas, 4150 Monroe Street, Wichita, Kansas 67209. Copies of this form are available from the Conservation Division, State Corporation Commission, 245 No. Water, Wichita, Kansas 67202. Phone AC 316-522-2206. If confidential custody is desired, please note Rule 82-2-125. Drillers Logs will be on open file in the Oil and Gas Division, State Geological Survey of Kansas, Lawrence, Kansas 66044.

Operator  
Anadarko Production Company

DESIGNATE TYPE OF COMP.: OIL, GAS, DRY HOLE, SWDW, ETC.:

Well No. 4 Lease Name STANLEY "A" SWDW

S 13 T 30SR 35 W

**WELL LOG**

Show all important zones of porosity and contents thereof; cored intervals, and all drill-stem tests, including depth interval tested, cushion used, time tool open, flowing and shut-in pressures, and recoveries.

SHOW GEOLOGICAL MARKERS, LOGS RUN, OR OTHER DESCRIPTIVE INFORMATION.

FORMATION DESCRIPTION, CONTENTS, ETC.	TOP	BOTTOM	NAME	DEPTH
Sand and Redbed	0'	1620'	LOGS:	
Redbed and Anhydrite	1620'	1701'	GO Wire line Services	
Redbed, Shale and Lime	1701'	2678'	DIL	
Shale and Lime	2678'	5830'	CDL/CNS/GR	
			MEL/GR	
			1701'-5833'	
			Compensated Density	
			Compensated Neutron	
			DIL	
			MEL/GR	
			2389-5833'	

USE ADDITIONAL SHEETS, IF NECESSARY, TO COMPLETE WELL RECORD.

Date Received

*Paul Campbell*  
Signature

Paul Campbell, Division Production Manager  
Title

August 4, 1980  
Date