

WELL RECORD

11-30-38W

(Mail to Kansas Geological Survey, 4150 Monroe Street, Wichita, Kansas 67209)

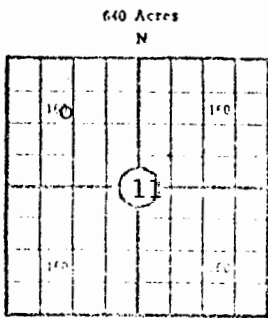

Lease Name: Welter Well No. 2-11
 Well Located: 1250' fr N & W Lns.
Grant Co., Kansas SEC 11 TWP 30S RGE 38W
 Operator: Mesa Petroleum Co.
 Address: P. O. Box 2009 Amarillo, Texas 79105
 Elevation: Ground 3142' D.F. ----- K.B. 3150'
 Type Well: (Oil, gas, dry hole) Gas

Drilling Commenced: 11-11 1971 Drilling Completed: 11-15 1971
 Well Completed: 12-23- 1971 Total Depth 2915'
 Initial Production: _____

Casing Record

Size: 8-5/8" Set at 574 Size: _____ Set at _____
 Size: 5-1/2" Set at 2914' Size: _____ Set at _____

Liner Record

Size: _____ Set from _____ To _____

Cementing

Casing Size	Sacks	Type Cement and Additives
<u>8-5/8"</u>	<u>500</u>	<u>common plus 3% cc.</u>
<u>5-1/2"</u>	<u>300</u>	<u>Posmix, 18% salt, 12-1/2# Gilsonite/sx.</u>

Perforations

Formation	Perforated Interval and Number Shots
<u>Council Grove</u>	<u>2710-2868' (52') 4 shots/ft.</u>
_____	_____
_____	_____

Electric Log Run (Show type log and depths covered)

Radioactivity Log 2918-1750' 600-170' 170-70' 70'-surface

Show Drill Stem Tests,
Well Stimulation and
Production Tests

11-30-38w

Formation Top Bottom

Herrington	2386	2405
Kriber	2405	2480
Winfield	2480	2547
Fort Riley	2547	2598
L/Fort Riley	2598	2680
Wreford	2680	2700
Council Grove	2700	TD

Frac'd with 3000 bbls. water, 100,000#
river sand. Blow test after frac 6270
MCF (pitot tube).

LOG TOPS	DEPTH
HER	2386
C GR	2700
RTD	2915