

CONFIDENTIAL

KANSAS DRILLERS LOG

State Geological Survey
WICHITA, BRANCH

15-187-20286

API No. 15 — 187 — 20286
County Number

S. 22 T. 30S R. 41W E W

Loc. NE SE NE

County Stanton

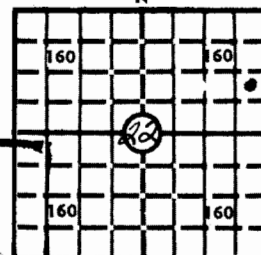
640 Acres
N

Operator

Beren Corporation

Address

970 Fourth Financial Center, Wichita, Kansas 67202

Well No.

1

Lease Name

CARRIE "A"

Footage Location

feet from (N) (S) line

Principal Contractor

Da Mac Drilling

Geologist

Pete W. D. D.

RELEASED

APR 30 1982

Spud Date

October 3, 1978

Total Depth

5600

P.B.T.D.
FROM CONFIDENTIAL

Date Completed

October 10, 1978

Oil Purchaser

Elev.: Gr.

Locate well correctly
3371

DF KB 3380

CASING RECORD

Report of all strings set — surface, intermediate, production, etc.

Purpose of string	Size hole drilled	Size casing set (in O.D.)	Weight lbs/ft.	Setting depth	Type cement	Sacks	Type and percent additives
Surface		8-5/8		1560	Light Weight Common	600 150	3% CC 3% CC
Production		5½	14#	5599	60-40 pozmix	250	10% salt, 2% gel, 10# gilsonite/sx

LINER RECORD

PERFORATION RECORD

Top, ft.	Bottom, ft.	Sacks cement	Shots per ft.	Size & type	Depth interval

Size	Setting depth	Packer set at

ACID, FRACTURE, SHOT, CEMENT SQUEEZE RECORD

Amount and kind of material used	Depth interval treated

INITIAL PRODUCTION

Date of first production		Producing method (flowing, pumping, gas lift, etc.)			
RATE OF PRODUCTION PER 24 HOURS	Oil	Gas	Water	Gas-oil ratio	
	bbls.	MCF	bbls.	CFPB	
Disposition of gas (vented, used on lease or sold)			Producing interval (s)		

INSTRUCTIONS: As provided in KCC Rule 82-2-125, within 90 days after completion of a well, one completed copy of this Drillers Log shall be transmitted to the State Geological Survey of Kansas, 4150 Monroe Street, Wichita, Kansas 67209. Copies of this form are available from the Conservation Division, State Corporation Commission, 3830 So. Meridian (P.O. Box 17027), Wichita, Kansas 66217. Phone AC 316-522-2206. If confidential custody is desired, please note Rule 82-2-125. Drillers Logs will be on open file in the Oil and Gas Division, State Geological Survey of Kansas, Lawrence, Kansas 66044.

Operator Beren Corporation		DESIGNATE TYPE OF COMP.: OIL, GAS, DRY HOLE, SWDW, ETC.:
Well No. 1	Lease Name CARRIE "A"	Oil
S <u>22</u> T <u>30S</u> R <u>41</u> ^W _W		

WELL LOG			SHOW GEOLOGICAL MARKERS, LOGS RUN, OR OTHER DESCRIPTIVE INFORMATION.	
Show all important zones of porosity and contents thereof; cored intervals, and all drill-stem tests, including depth interval tested, cushion used, time tool open, flowing and shut-in pressures, and recoveries.				
FORMATION DESCRIPTION, CONTENTS, ETC.	TOP	BOTTOM	NAME	DEPTH
Sand	0	101		
Sand, Blud clay, red bed, anhydrite	101	904		
Red bed, sand	904	1390		
Anhydrite, shells	1390	1850		
Shale	1850	2358		
Shale, lime	2358	5164		
Shale, sand	5164	5278		
Sand, lime	5278	5320		
Lime, shale	5320	5535		
Lime	5535	5600		
R.T.D.	5600			
USE ADDITIONAL SHEETS, IF NECESSARY, TO COMPLETE WELL RECORD.				

Date Received	<div> <div></div> <div>Signature</div> <div>Don Beauchamp - Geologist</div> <div>Title</div> <div>February 2, 1979</div> <div>Date</div> </div>
---------------	---

114523