

IMPORTANT
 Kans. Geo. Survey request
 samples on this well.

S. 19 T. 30 R. 41 $\frac{1}{2}$ W

API No. 15 — 187 — 20,148
 County Number

Loc. C S $\frac{1}{2}$ SW

County Stanton

Operator
 Graham-Michaelis Corporation

Address Box 247
 Wichita, Kansas

Well No. #1-19 Lease Name Barnes

Footage Location
 660 feet from XM (S) line 1320 feet from XX (W) line

Principal Contractor Geologist
 Murfin Drilling Company Tom Wright

Spud Date Total Depth P.B.T.D.
 December 21, 1973 5600'

Date Completed Oil Purchaser
 January 7, 1974 None - D&A

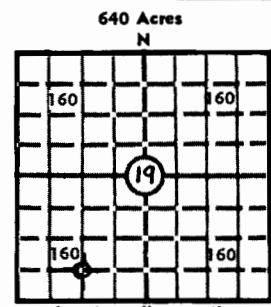

Locate well correctly
 Elev.: Gr. 3441'

DF 3449' KB 3451'

CASING RECORD

Report of all strings set — surface, intermediate, production, etc.

Purpose of string	Size hole drilled	Size casing set (in O.D.)	Weight lbs/ft.	Setting depth	Type cement	Sacks	Type and percent additives
Protect fresh water supply, or shallow water zone		8 5/8"	23#	1550'	light weight common	550 200	2% cc 3% cc

LINER RECORD

PERFORATION RECORD

Top, ft.	Bottom, ft.	Sacks cement	Shots per ft.	Size & type	Depth interval
none			none		

Size	Setting depth	Packer set at
none		

ACID, FRACTURE, SHOT, CEMENT SQUEEZE RECORD

Amount and kind of material used	Depth interval treated
Not shot, fractured or treated	

INITIAL PRODUCTION

Date of first production None	Producing method (flowing, pumping, gas lift, etc.) D&A				
RATE OF PRODUCTION PER 24 HOURS	Oil D&A	Gas D&A	Water MCF	Gas-oil ratio bbls.	CFPB
Disposition of gas (vented, used on lease or sold)			Producing interval(s)		

INSTRUCTIONS: As provided in KCC Rule 82-2-125, within 90 days after completion of a well, one completed copy of this Drillers Log shall be transmitted to the State Geological Survey of Kansas, 4150 Monroe Street, Wichita, Kansas 67209. Copies of this form are available from the Conservation Division, State Corporation Commission, 3830 So. Meridian (P.O. Box 17027), Wichita, Kansas 66217. Phone AC 316-522-2206. If confidential custody is desired, please note Rule 82-2-125. Drillers Logs will be on open file in the Oil and Gas Division, State Geological Survey of Kansas, Lawrence, Kansas 66044.

Operator Graham-Michaelis Corporation

DESIGNATE TYPE OF COMP.: OIL, GAS, DRY HOLE, SWD, ETC.:

Well No. 1-19	Lease Name Barnes	Dry Hole
S19 T 30S R 41W		Stanton County, Kansas

WELL LOG

Show all important zones of porosity and contents thereof; cored intervals, and all drill-stem tests, including depth interval tested, cushion used, time tool open, flowing and shut-in pressures, and recoveries.

SHOW GEOLOGICAL MARKERS, LOGS RUN, OR OTHER DESCRIPTIVE INFORMATION.

FORMATION DESCRIPTION, CONTENTS, ETC.	TOP	BOTTOM	NAME	DEPTH
Surface Clay	70	250		
Shale	250	725	Schlumberger Dual Induction	
Shale & shells w/sand	725	765	Laterolog run	from 1555'-5591'
Lime	765	1315		
Sand	1315	1410	Schlumberger Compensated	
Red Shale & Shells	1410	1544	Formation Density Log	
Anhydrite	1544	1552	run from 2000'	to 5590'
Anhydrite	1552	1567		
Shale	1567	1610		
Shale & Lime Shells	1610	2110		
Lime-Shale	2110	3315	No cores.	
Lime with Chalk	3315	3500		
Lime & Shale	3500	3790		
Lime with Chalk	3790	4070		
Lime & Shale	4070	4385		
Lime	4385	4520		
Lime, Shale & Sand	4520	4600		
Lime	4600	4810		
Lime & Shale	4810	5115		
Shale	5115	5213		
Shale, Sand, Lime	5213	5290		
Lime & Shale	5290	5405		
Lime	5405	5475		
Lime & Shale	5475	5535		
Lime	5535	5600	T.D.	
<p>DRILL STEM TEST #1 4968-5213</p> <p>Open: 90 min. gas to surface in 20 min. too small to measure. Recovery: 540' gas cut mud ISIP: 1292# in 45 min. FP: 130-163# 163-380# FSIP: 1292# in 45 min.</p> <p>DRILL STEM TEST #2 5500-5600'</p> <p>Open: 90 min. strong blow throughout. ISIP: 1355#/45 min. FP (72-557; 557-1282) Recovery: 200' slightly gas & oil speckled salty mud. 2600' gas cut muddy water. FSIP: 1355#/45 min.</p> <p>USE ADDITIONAL SHEETS, IF NECESSARY, TO COMPLETE WELL RECORD.</p>				

Date Received

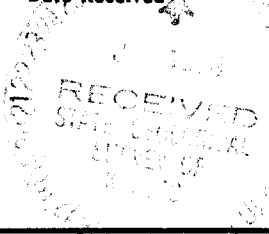

Muriel F. C. Geram

Signature

Geological Secretary

Title

January 16, 1974

Date