

**KANSAS DRILLERS LOG**

API No. 15 — 007 — 20683  
 County Number

S. 31 T. 31S R. 11W <sup>E</sup>/<sub>W</sub>  
 Loc. NW SE SE  
 County Barber

Operator  
Raymond Oil Co.

Address  
200 W. Douglas Wichita, Ks. 67202

Well No. # 1 Lease Name Swartz

Footage Location  
990 feet from  (N) (S) line 990 feet from (E)  (W) line

Principal Contractor Graves Drilling Co. Geologist Richard E. Rowland

Spud Date 11-2-78 Total Depth 3720' P.B.T.D.

Date Completed 11-8-78 Oil Purchaser

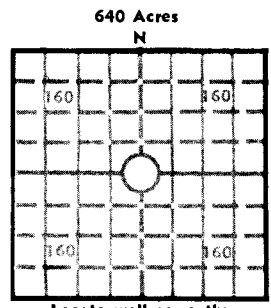

Locate well correctly  
 Elev.: Gr. 1495'  
 DF KB 1506'

**CASING RECORD**

Report of all strings set — surface, intermediate, production, etc.

Purpose of string	Size hole drilled	Size casing set (in O.D.)	Weight lbs/ft.	Setting depth	Type cement	Sacks	Type and percent additives
Surface	12-1/4"	8-5/8"	24#	212'		200	2% gel-3% cc

**LINER RECORD**

**PERFORATION RECORD**

Top, ft.	Bottom, ft.	Sacks cement	Shots per ft.	Size & type	Depth interval

Size	Setting depth	Packer set at

**ACID, FRACTURE, SHOT, CEMENT SQUEEZE RECORD**

Amount and kind of material used	Depth interval treated

**INITIAL PRODUCTION**

Date of first production	Producing method (flowing, pumping, gas lift, etc.)				
<b>RATE OF PRODUCTION PER 24 HOURS</b>	Oil	Gas	Water	Gas-oil ratio	
	bbls.	MCF	bbls.	CFPB	
Disposition of gas (vented, used on lease or sold)			Producing interval (s)		

INSTRUCTIONS: As provided in KCC Rule 82-2-125, within 90 days after completion of a well, one completed copy of this Drillers Log shall be transmitted to the State Geological Survey of Kansas, 4150 Monroe Street, Wichita, Kansas 67209. Copies of this form are available from the Conservation Division, State Corporation Commission, 3830 So. Meridian (P.O. Box 17027), Wichita, Kansas 66217. Phone AC 316-522-2206. If confidential custody is desired, please note Rule 82-2-125. Drillers Logs will be on open file in the Oil and Gas Division, State Geological Survey of Kansas, Lawrence, Kansas 66044.

Operator Raymond Oil Company, Inc. DESIGNATE TYPE OF COMP.: OIL, GAS, DRY HOLE, SWDW, ETC.:

Well No. 1 Lease Name Swartz Dry Hole

S \_\_\_ T \_\_\_ R \_\_\_ E \_\_\_ W

**WELL LOG**  
 Show all important zones of porosity and contents thereof; cored intervals, and all drill-stem tests, including depth interval tested, cushion used, time tool open, flowing and shut-in pressures, and recoveries. SHOW GEOLOGICAL MARKERS, LOGS RUN, OR OTHER DESCRIPTIVE INFORMATION.

FORMATION DESCRIPTION, CONTENTS, ETC.	TOP	BOTTOM	NAME	DEPTH
DST #1 30-30-30-30 Rec. 10' Mud FP 69-69 - ISIP 69 - FP 69-69- FSIP 69	3305	3340	LOG TOPS	
			Towanda	1870
			Wreford	2076
			Admire	2526
			Tarkio	2730
DST #2 30-30-30-30 Rec. 30' Mud FP 70-70 - ISIP 117 - FP 70-70 - FSIP 117	3477	3520	Topeka	2982
			Elgin	3334
			Heebner	3494
			Douglas	3502
			Lansing	3698
DST #3 (Straddle) 60-30-60-30 Rec. 1460' Gas in Pipe 1140' Muddy Water FP 149-398 - ISIP 688 - FP 447-521 - FSIP 688	3336	3364	LTD	3721
			RTD	3720
D & A Plugged 11-8-78				

USE ADDITIONAL SHEETS, IF NECESSARY, TO COMPLETE WELL RECORD.

Date Received

RAYMOND OIL COMPANY, INC.  
*Wm. M. Raymond*  
 Wm. M. Raymond Signature  
 President  
 Title  
 November 16, 1978  
 Date

ROTARY DRILLERS LOG

OPERATOR: Raymond Oil Co., Inc.  
200 West Douglas - Suite 800  
Wichita, Kansas 67202

DRILLING COMMENCED: November 2, 1978

CONTRACTOR: Graves Drilling Co., Inc.  
910 Union Center  
Wichita, Kansas 67202

DRILLING COMPLETED: November 8, 1978

CASING RECORD: 5 Jts. 212' of new 8-5/8"  
cemented with 200 sacks

LOCATION: SWARTZ NO. 1  
NW SE SE  
Section 31-31S-11W  
Barber County, Kansas

---

0	-	40	Sod and Sand
40	-	70	Sand
70	-	212	Red Bed
212	-	830	Red Bed and Shale
830	-	2114	Shale and Lime
2114	-	2275	Shale
2275	-	3340	Shale and Lime
3340	-	3509	Sand and Shale and Lime
3509	-	3520	Shale and Lime
3520	-	3687	Sand and Shale
3687	-	3720	Shale and Lime
		3720	Rotary Total Depth

I hereby certify the foregoing statements to be true and correct to the best of my knowledge.

GRAVES DRILLING CO., INC.

By Betty Bennett  
Secretary-Treasurer