

* ✓

SIDE ONE S

Ind. PI

STATE CORPORATION COMMISSION OF KANSAS
OIL & GAS CONSERVATION DIVISION

WELL COMPLETION OR RECOMPLETION FORM
ACO-1 WELL HISTORY

DESCRIPTION OF WELL AND LEASE

Operator: License # 5601
Name Associated Petroleum Consultants, Inc.
Address Suite 600 - One Main Place
City/State/Zip Wichita, KS 67202

Purchaser Total Petroleum

Operator Contact Person Michael Sevier
Phone 265-9385

Contractor: License # 5867
Name Heartland Drilling

Wellsite Geologist Phillip F. Hargis
Phone 265-9385

Designate Type of Completion
 New Well Re-Entry Workover
 Oil SWD Temp Abd
 Gas Inj Delayed Comp.
 Dry Other (Core, Water Supply etc.)

If OWWO: old well info as follows:
Operator
Well Name
Comp. Date Old Total Depth

WELL HISTORY

Drilling Method:
 Mud Rotary Air Rotary Cable
6/14/85 6/22/85 7/18/85
Spud Date Date Reached TD Completion Date
4874' 4388'
Total Depth PBTD

Amount of Surface Pipe Set and Cemented at 283' feet
Multiple Stage Cementing Collar Used? Yes No
If yes, show depth set feet
If alternate 2 completion, cement circulated from feet depth to w/SX cmt
Alternate One Used

API NO. 15-007-22,051
County Barber
SW SE SE Sec 9 Twp 31S Rge 12 East West

330 Ft North from Southeast Corner of Section
990 Ft West from Southeast Corner of Section
(Note: Locate well in section plat below)

Lease Name Elliott "B" Well # 1

Field Name Ambermills South

Producing Formation Mississippi

Elevation: Ground 1720' KB 1730'
Section Plat

SEP 30 1985
State Geological Survey
WICHITA BRANCH

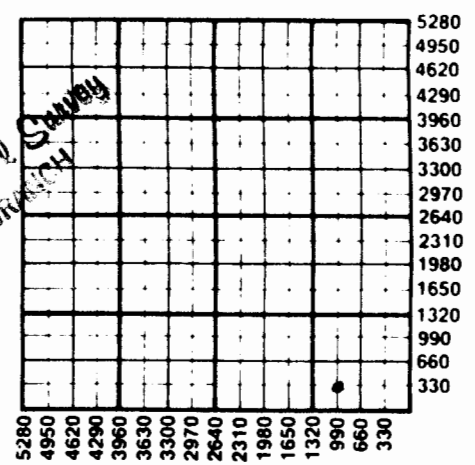

WATER SUPPLY INFORMATION
Disposition of Produced Water: Disposal Repressuring
Docket #

Questions on this portion of the ACO-1 call:
Water Resources Board (913) 296-3717
Source of Water: Small Pond
Division of Water Resources Permit # No permit.
 Groundwater Ft North from Southeast Corner (Well) Ft West from Southeast Corner of Sec Twp Rge East West
 Surface Water 100 Ft North from Southeast Corner (Stream, pond etc) 660 Ft West from Southeast Corner Sec Twp Rge East West
 Other (explain) (purchased from city, R.W.D. #)

INSTRUCTIONS: This form shall be completed in duplicate and filed with the Kansas Corporation Commission, 200 Colorado Derby Building, Wichita, Kansas 67202, within 90 days after completion or recompletion of any well. Rule 82-3-130 and 82-3-107 apply.
Information on side two of this form will be held confidential for a period of 12 months if requested in writing and submitted with the form. See rule 82-3-107 for confidentiality in excess of 12 months.
A copy of all wireline logs and drillers time log shall be attached with this form. Submit CP-4 form with