

State Geological Survey

KANSAS DRILLERS LOG

IMPORTANT
Kans. Geo. Survey request
samples on this well.

API No. 15 — 007 — 20,761
County Number

Operator
Texas Oil & Gas Corp.

Address
300-200 West Douglas Wichita, Kansas 67202

Well No. #1 Lease Name
Gress

Footage Location
1060 feet from (N) (S) line 660 feet from (E) (W) line

Principal Contractor H-30 Drilling Geologist
Core Laboratories

Spud Date 7-2-79 Total Depth 4330' P.B.T.D. 4260'

Date Completed 7-20-79 Oil Purchaser
N/A

S. 28 T. 31 R. 12 W
Loc. 1060' FSL & 660' FWL SW

County Barber

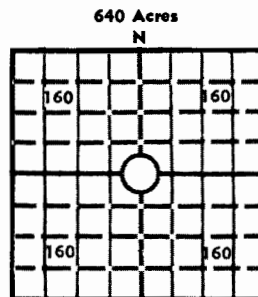

Locate well correctly
Elev.: Gr. 1562'
DF KB 1571'

CASING RECORD

Report of all strings set — surface, intermediate, production, etc.

Purpose of string	Size hole drilled	Size casing set (in O.D.)	Weight lbs/ft.	Setting depth	Type cement	Sacks	Type and percent additives
Surface		8-5/8"		335		300	
Production		4-1/2"		4329		200	

LINER RECORD

PERFORATION RECORD

Top, ft.	Bottom, ft.	Sacks cement	Shots per ft.	Size & type	Depth interval
N/A	N/A	N/A	1 JSPF	4-1/2"	4214-44'
TUBING RECORD					
Size 2-3/8"	Setting depth 2661'	Packer set N/A			
2-3/8"	4120'	N/A			

ACID, FRACTURE, SHOT, CEMENT SQUEEZE RECORD

Amount and kind of material used	Depth interval treated
Acidized w/2000 gallons 15% HCl & 45 ball sealers	4214-44'

INITIAL PRODUCTION

Date of first production 10-18-79	Producing method (flowing, pumping, gas lift, etc.) flowing
RATE OF PRODUCTION PER 24 HOURS Oil N/A bbls. Gas 740 MCF Water none bbls. Gas-oil ratio N/A CFPB	Disposition of gas (vented, used on lease or sold) Peoples Natural Gas
	Producing interval(s) 4214-44'

INSTRUCTIONS: As provided in KCC Rule 82-2-125, within 90 days after completion of a well, one completed copy of this Drillers Log shall be transmitted to the State Geological Survey of Kansas, 4150 Monroe Street, Wichita, Kansas 67209. Copies of this form are available from the Conservation Division, State Corporation Commission, 3830 So. Meridian (P.O. Box 17027), Wichita, Kansas 66217. Phone AC 316-522-2206. If confidential custody is desired, please note Rule 82-2-125. Drillers Logs will be on open file in the Oil and Gas Division, State Geological Survey of Kansas, Lawrence, Kansas 66044.

Operator Texas Oil & Gas Corp.		DESIGNATE TYPE OF COMP.: OIL, GAS, DRY HOLE, SWDW, ETC.:	
Well No. #1	Lease Name Gress	gas	
S <u>28</u> T <u>31</u> R <u>12</u> <u>W</u>			
WELL LOG		SHOW GEOLOGICAL MARKERS, LOGS RUN, OR OTHER DESCRIPTIVE INFORMATION.	
Show all important zones of porosity and contents thereof; cored intervals, and all drill-stem tests, including depth interval tested, cushion used, time tool open, flowing and shut-in pressures, and recoveries.			
FORMATION DESCRIPTION, CONTENTS, ETC.	TOP	BOTTOM	NAME DEPTH
Herington	1808	-237	
Winfield	1870	-299	
Towanda	1937	-366	
Ft. Riley	1993	-422	
Wreford	2139	-568	
Cottonwood	2326	-755	
Red Eagle	2439	-868	
Onaga	2590	-1019	
Indian Cave ss	2606	-1035	
Wabaunsee	2640	-1069	
Topeka	3020	-1449	
Heebner	3510	-1939	
Douglas ss	3662	-2091	
Lansing	3713	-2142	
Swope	4056	-2485	
B/Kansas City	4113	-2542	
Mississippian	4208	-2637	
TD	4330		
PBTD	4260		
<u>DST #1, 2552-2625' (Ind. Cave), w/results as follows:</u> Mis-run.			
<u>DST #2, 2571-2625' (Ind. Cave), w/results as follows:</u> IFP/30": 106-106#, str blow incr. throughout ISIP/60": 1077# FFP/45": 106-85# GTS in 3", 10" -56/8 MCFD, 20" -63.5, 30" -77.8, 40" -89.8, 45" -89.9 Rec. 300' WCM			
USE ADDITIONAL SHEETS, IF NECESSARY, TO COMPLETE WELL RECORD.			
Date Received	<div style="text-align: center;"> <div style="display: flex; justify-content: center; gap: 10px;"> <div>HAROLD A. BROWN</div> <div style="font-size: small;">Signature</div> </div> <div style="display: flex; justify-content: center; gap: 10px;"> <div>District Exploration Manager</div> <div style="font-size: small;">Title</div> </div> <div style="display: flex; justify-content: center; gap: 10px;"> <div>October 24, 1979</div> <div style="font-size: small;">Date</div> </div> </div>		

COMPANY Texas Oil & Gas Corp.

SEC. 28 T. 31S. 12W
LOC. 1060' FSL&660' FWL

FARM Gress

NO. 1

COUNTY Barber

ROTARY TOTAL DEPTH 4,330'
COMM. July 2, 1979
CONTRACTOR H-30, INC.
ISSUED July 19, 1979

COMP. July 10, 1979

CASING

10 3/4"

8 5/8" Set at 335' cemented w/300 sxs cement

ELEVATION 1,562' G.R.

5 1/2"

4 1/2" Set at 4,329' cemented w/200 sxs cement

FIGURES INDICATE BOTTOM OF FORMATIONS

Red Bed and Shale	336'
Shale	1,216'
Shale and Lime	3,740'
Lime and Shale	4,330'
Rotary Total Depth	4,330'

I hereby certify the above and foregoing to be
a true and correct log of the above described
well as shown by the drilling reports.

H-30, INC.

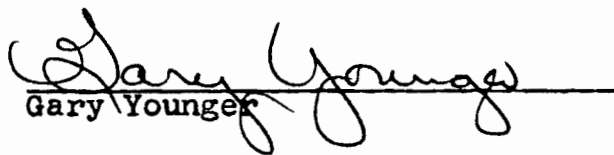
Gary Younger

State of Kansas }
County of Sedgwick } ss:

Subscribed and Sworn to before me a Notary Public
in and for said county and state this 19th day of
July, 1979.

Elsie Willison - Notary Public