

*Ind 8*

STATE CORPORATION COMMISSION OF KANSAS  
OIL & GAS CONSERVATION DIVISION

WELL COMPLETION OR RECOMPLETION FORM  
ACO-1 WELL HISTORY

DESCRIPTION OF WELL AND LEASE

Operator: License # 5205  
Name Mid-Continent Energy Corporation  
Address 120 S. Market, Suite 310  
Wichita, KS 67202  
City/State/Zip

Purchaser: Inland Crude & Central States  
Inland Crude: 200 Douglas Bldg. - Wichita, KS  
Central States: 1700 Lincoln St. - Denver, CO 80203  
Operator Contact Person Bradley R. Ruebler  
Phone 316-265-9501

Contractor: License # 5418  
Name Allen Drilling Company

Wellsite Geologist Doug McGuinness  
Phone 316-267-6065

Designate Type of Completion

New Well  Re-Entry  Workover

Oil  SWD  Temp Abd  
 Gas  Inj  Delayed Comp.  
 Dry  Other (Core, Water Supply etc.)

If ONWO: old well info as follows:

Operator Mid-Continent Energy Corp.  
Well Name Parr #2  
Comp. Date 1/27/85 Old Total Depth 4664'

WELL HISTORY

Drilling Method:

Mud Rotary  Air Rotary  Cable

1/15/85 1/27/85 1/27/85  
Spud Date Date Reached TD Completion Date  
4664' -----  
Total Depth PBD

Amount of Surface Pipe Set and Cemented at 329 feet  
Multiple Stage Cementing Collar Used?  Yes  No

If alternate 2 completion, cement circulated  
from ----- feet depth to ----- w/ ----- SX cmt

API NO. 15-007-21,995

County Barber

NE NW SE Sec. 22 Twp. 31 Rge. 13  East  West

2310 Ft North from Southeast Corner of Section  
1650 Ft West from Southeast Corner of Section  
(Note: Locate well in section plat below)

Lease Name Parr Well # 2

Field Name Nurse

Producing Formation Viola  
KS

Elevation: Ground 1601 KB 1606

Section Plat

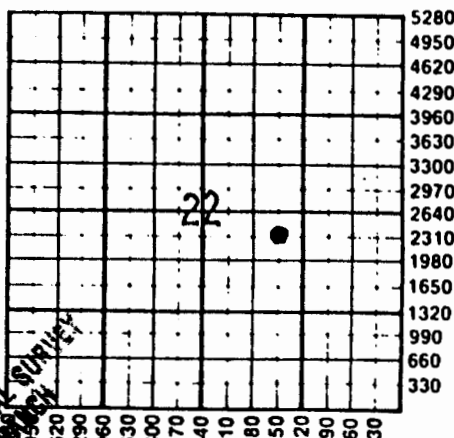

WATER SUPPLY INFORMATION  
Disposition of Produced Water:  Disposal  Repressuring  
Docket #

Questions on this portion of the ACO-1 call:  
Water Resources Board (913) 296-3717

Source of Water:  
Division of Water Resources Permit #

Groundwater ----- Ft North from Southeast Corner (Well) ----- Ft West from Southeast Corner of Sec Twp Rge  East  West

Surface Water ----- Ft North from Southeast Corner (Stream, pond etc) ----- Ft West from Southeast Corner Sec Twp Rge  East  West

Other (explain) Clifton Mills-Lake City, KS 67071  
(purchased from city, R.W.D. #)

INSTRUCTIONS: This form shall be completed in duplicate and filed with the Kansas Corporation Commission, 200 Colorado Derby Building, Wichita, Kansas 67202, within 90 days after completion or recompletion of any well. Rule 82-3-130 and 82-3-107 apply.

Information on side two of this form will be held confidential for a period of 12 months if requested in writing and submitted with the form. See rule 82-3-107 for confidentiality in excess of 12 months.

One copy of all wireline logs and drillers time log shall be attached with this form. Submit CP-4 form with all plugged wells. Submit CP-111 form with all temporarily abandoned wells.

All requirements of the statutes, rules and regulations promulgated to regulate the oil and gas industry have been fully complied with and the statements herein are complete and correct to the best of my knowledge.

Signature Kent R. Roberts

Kent R. Roberts

Title Petroleum Geologist Date 12-3-85

JUN 1 1986

Subscribed and sworn to before me this 3rd day of December 1985

Notary Public Mary Kathleen Bachman

State Commission Expires

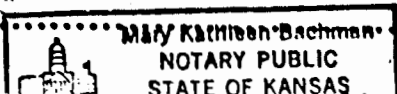

K.C.C. OFFICE USE ONLY  
F  Letter of Confidentiality Attached  
C  Wireline Log Received  
C  Drillers Timelog Received  
Distribution  
 KCC  SWD/Rep  NGPA  
 KGS  Plug  Other (Specify)

Sec: 2 Twp: 31 Rge: 13

SIDE TWO

Operator Name Mid-Continent Energy Corporation Lease Name Parr Well # 2

Sec. 22 Twp. 31 Rge. 13  East  West County Barber

WELL LOG

INSTRUCTIONS: Show important tops and base of formations penetrated. Detail all cores. Report all drill stem tests giving interval tested, time tool open and closed, flowing and shut-in pressures, whether shut-in pressure reached static level, hydrostatic pressures, bottom hole temperature, fluid recovery, and flow rates if gas to surface during test. Attach extra sheet if more space is needed. Attach copy of log.

Drill Stem Tests Taken  Yes  No  
 Samples Sent to Geological Survey  Yes  No  
 Cores Taken  Yes  No

Formation Description  
 Log  Sample

Refer to attached page.

*22-315-13W  
 Parr #2*

Name	Top	Bottom
Indian Cave	2630	-1024
Topeka	3360	-1760
Heebner	3542	-1936
Up. Douglas Sand	3609	-2003
Lansing	3673	-2070
Mississippi	4230	-2624
Kinderhook Shale	4371	-2765
Viola	4454	-2848
Simpson	4563	-2957
Arbuckle	4661	-3055
L.T.D.	4666	-3060

CASING RECORD <input checked="" type="checkbox"/> New <input type="checkbox"/> Used							
Report all strings set-conductor, surface, intermediate, production, etc.							
Purpose of String	Size Hole Drilled	Size Casing Set (In O.D.)	Weight Lbs/Ft.	Setting Depth	Type of Cement	#Sacks Used	Type and Percent Additives
Surface	1 7/8"	8-5/8"	24#	329	60/40 PDZ	220	2% gel, 3% OC
Production	7-7/8"	4 1/2"	10 1/2#	4661	Class A	300	500 gal. BJ.
					Surfill w/ Friction Reducer		Mudsweep
PERFORATION RECORD				Acid, Fracture, Shot, Cement Squeeze Record (Amount and Kind of Material Used)			
Shots Per Foot	Specify Footage of Each Interval Perforated			Depth			
2	3774'-3782', squeezed perf.			500 gal., 15% mud acid			3774'-3782'
4	4458-4462			Fract. w/ 350 gal., 28% 7500# 20/40 sand, 200,00 CF of Nitrogen			4458-4462'
TUBING RECORD		Size	Set At	Packer at	Liner Run <input type="checkbox"/> Yes <input checked="" type="checkbox"/> No		
		2-3/8"	4450'	4425'			
Date of First Production		Producing Method <input checked="" type="checkbox"/> Flowing <input type="checkbox"/> Pumping <input type="checkbox"/> Gas Lift <input type="checkbox"/> Other (explain).....					
Estimated Production Per 24 Hours		Oil	Gas	Water	Gas-Oil Ratio	Gravity	
5-10 Bbls		120 MCF	Bbls	CFPB			

METHOD OF COMPLETION

Production Interval

Disposition of gas:  Vented  Open Hole  Perforation  
 Sold  Other (Specify) ..... 4458-4462'  
 Used on Lease  Dually Completed .....  
 Commingled

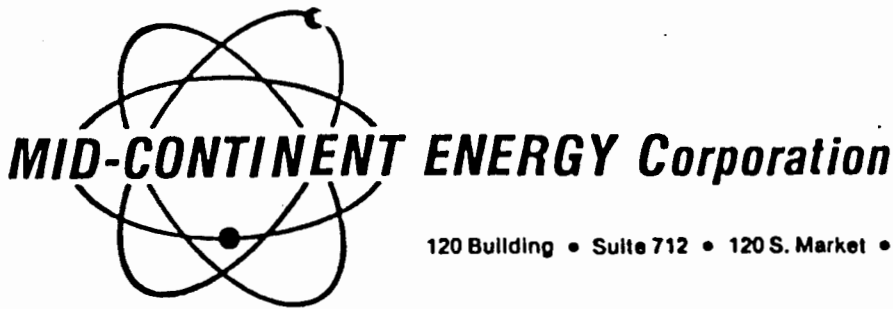

120 Building • Suite 712 • 120 S. Market • Wichita, Kansas 67202 • (316) 265-9501

WELL NAME: Parr #2

Location: NE $\frac{1}{4}$ NW $\frac{1}{4}$ SE $\frac{1}{4}$  of Sec. 22-T31S-R13W  
Barber Co., KS

API #15-007-21,995

Drill Stem Tests Taken:

DST #1: 2818'-35' (Indian Cave); 30"-30"-60"-60"; wk. increasing to gd. blow; Rec. 40' mdy. wtr. + 150' wtr.; SIP=1004-1014.

DST #2: 3364-3380 (Topeka); Misrun (tool plugged); 30"-30"-60"-60".

DST #3: 3364-3380 (Topeka) Misrun (tool plugged)

DST #4: 3363-3380 (Topeka) 30"-30"-30"-30"; very wk. blow; Rec. 30' mud; FP=35-35, SIP=35-35; BHT=113°.

DST #5: 3602-3615 (Upper Douglas Sand); 30"-30"-30"-30"; Fr. increasing to gd. blow; Rec. 30' mud; FP=11-11 & 23-23; SIP=869-811.

DST #6: 3664-3685 (Lower Douglas Sand); 30"-30"-60"-60"; GTS 15" into 2nd open; Gauge 17.2 MCF dec. to 14.4 MCF in 30" & stab.: Rec. 40' SOGCM (5% oil) + 120' OGCWM (15% oil + 20% wtr.) + 60' SOGCWM (5% oil) + 120' SW w/scum oil (87,000 ppm.); 340' Total Fluid; FP=40-40 & 91-132; SIP=1277-1317; BHT=116°.

DST #7: 3770-3785 (Lansing "B") 30"-30"-60"-60"; GTS 9" = 55.2 MCF decr. to 44.8 during 2nd open; Rec. 50' GCM (80% oil) + 650' CGO + 10' wtr.; 710' Total Fluid; (oil 32°, wtr. 43,000 ppm.); FP=60-71 & 132-193; SIP=1317-1317  
BHT=116°

DST #8: 3950-3960 (Lansing "I") 30"-30"-60"-60"; GTS 5"; 55.2 MCF in 70"; Rec. 70' oil & GCWM (15% oil, 20% wtr.) + 120' oil and GCW (5% oil, 80% wtr.) + 60' SW (250' Total Fluid); 110,000 ppm.; FP=50-50 & 71-101; SIP=1307-1196; BHT=119°.

DST #9: 4050-4065 (Lansing "K") 30"-30"-60"-60"; Strg. blow; Rec. 65' oil and GCM (25% oil) + 60' oil and GCMW (5% oil, 70% wtr.) + 210' SW (112,000 ppm.) 245' Total Fluid; FP=40-40 & 81-101; SIP=1348-1398; BHT=120°.

DST #10: 4457-4469 (Viola); 30"-30"-60"-60"; GTS 10", stabilized @ 56.8 MCF in 60"; Rec. 30' GCM; FP=23-23 & 23-23; SIP=1439-1439; BHT=124°.

DST #11: 4573-4590 (Simpson Sand); 30"-30"-30"-30"; very wk. blow; Rec. 5' mud; FP=11-11 & 11-11; SIP=23-11; BHT=125°.