

WICHITA BRANCH
KANSAS DRILLERS LOG

S. 36 T. 31 R. 18 **W**

API No. 15 — _____
County _____ Number _____

Loc. SE NW

County COMANCHE

Operator
PICKRELL DRILLING COMPANY

Address
205 LITWIN BLDG., WICHITA, KS. 67202

Well No. 1 Lease Name DELANEY "B"

Footage Location
feet from (N) (S) line _____ feet from (E) (W) line _____

Principal Contractor PICKRELL DRILLING COMPANY Geologist Richard E. Roby

Spud Date 7-15-78 Total Depth 5225 P.B.T.D. _____

Date Completed 8-29-78 Oil Purchaser Derby

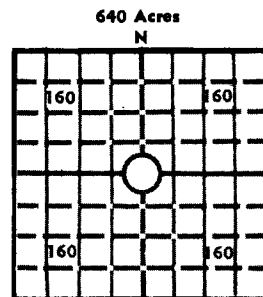

Elev.: Gr. 2144

DF 2146 KB 2149

CASING RECORD

Report of all strings set — surface, intermediate, production, etc.

Purpose of string	Size hole drilled	Size casing set (in O.D.)	Weight lbs./ft.	Setting depth	Type cement	Sacks	Type and percent additives
Surf. casing		8 5/8		606		400	
Prod. casing		4 1/2"		5224		150	

LINER RECORD

PERFORATION RECORD

Top, ft.	Bottom, ft.	Sacks cement	Shots per ft.	Size & type	Depth interval
			4	DP	5152-5157

TUBING RECORD

Size	Setting depth	Packer set at
2 3/8"	5149	

ACID, FRACTURE, SHOT, CEMENT SQUEEZE RECORD

Amount and kind of material used	Depth interval treated
Acidize w/500 gal. 15% mud acid. Acidize with 2000 gal. 15% NE acid.	

INITIAL PRODUCTION

Date of first production	Producing method (flowing, pumping, gas lift, etc.)			
9-25-78	Pumping			
RATE OF PRODUCTION PER 24 HOURS	Oil	Gas	Water	Gas-oil ratio
	9.5 BOPD bbls.		44 BWPD bbls.	CFPB
Disposition of gas (vented, used on lease or sold)	Producing interval (s)			
	5152-5157			

INSTRUCTIONS: As provided in KCC Rule 82-2-125, within 90 days after completion of a well, one completed copy of this Drillers Log shall be submitted to the State Geological Survey of Kansas, 4150 Monroe Street, Wichita, Kansas 67209. Copies of this form are available from the Conservation Division, State Corporation Commission, 3830 So. Meridian (P.O. Box 17027), Wichita, Kansas 66217. Phone AC 316-522-2206. If confidential custody is desired, please note Rule 82-2-125. Drillers Logs will be on open file in the Oil and Gas Division, State Geological Survey of Kansas, Lawrence, Kansas 66044.

Operator

PICKRELL DRILLING COMPANY

DESIGNATE TYPE OF COMP.: OIL, GAS, DRY HOLE, SWDW, ETC.:
OIL

Well No.

1

Lease Name

DELANEY "B"

s 36 T 31 R 18W^E_W

WELL LOG

Show all important zones of porosity and contents thereof; cored intervals, and all drill-stem tests, including depth interval tested, cushion used, time tool open, flowing and shut-in pressures, and recoveries.

SHOW GEOLOGICAL MARKERS, LOGS RUN, OR OTHER DESCRIPTIVE INFORMATION.

FORMATION DESCRIPTION, CONTENTS, ETC.	TOP	BOTTOM	NAME	DEPTH
Sand	0	285		
Red Bed & Shale	285	600		
Shale	600	654		
Shale	654	780		
Shale	780	1279		
Shale & Lime	1279	1752		
Shale & Lime	1752	2080		
Shale & Sand	2080	2495		
Lime & Shale	2495	2587		
Lime & Shale	2587	2735		
Lime & Shale	2735	2915		
Lime & Shale	2915	3047		
Lime & Shale	3047	3223		
Lime & Shale	3223	3410		
Lime & Shale	3410	3550		
Lime	3550	3697		
Lime & Shale	3697	3812		
Lime & Shale	3812	3015		
Lime	3915	3984		
Shale	3984	4055		
Lime & Shale	4055	4093		
Lime & Shale	4093	4270		
Lime	4269	4415		
Lime	4415	4555		
Lime & Shale	4555	4688		
Lime & Shale	4688	4793		
Lime	4793	4897		
Shale & Lime	4897	4989		
Lime	4989	5070		
Lime	5070	5146		
Lime	5146	5160		
Lime	5160	5177		
Lime	5177	5217		
Lime	5217	5225		

USE ADDITIONAL SHEETS, IF NECESSARY, TO COMPLETE WELL RECORD

Date Received

C. W. Sebts
Partner

Signature

Title

11-16-78

Date

COMPANY: PICKRELL DRILLING COMPANY
205 LITWIN BLDG.
WICHITA, KS. 67202
LOCATION: DELANEY "B" #1
SE NW Sec. 36-31S-18W
Comanche Co., Ks.
CONTRACTOR: **PICKRELL DRILLING COMPANY**
Wichita, Kansas

Rotary Drilling Commenced 7-15-78
Rotary Drilling Completed 7-28-78

CASING RECORD:

Surf. casing 8 5/8" set at 606' with 400sx.
Prod. casing 4 1/2" set at 5224' with 150sx.

LOG

(Figures indicate bottom of formation — measurements from top of rotary bushing.)

Sand	285
Red Beds & Shale	600
Shale	654
Shale	780
Shale	1279
Shale & Lime	1752
Shale & Lime	2080
Shale & Sand	2495
Lime & Shale	2587
Lime & Shale	2735
Lime & Shale	2915
Lime & Shale	3047
Lime & Shale	3223
Lime & Shale	3410
Lime & Shale	3550
Lime	3697
Lime & Shale	3812
Lime & Shale	3615
Lime	3904
Shale	4055
Lime & Shale	4093
Lime & Shale	4270
Lime	4415
Lime	4555
Lime & Shale	4688
Lime & Shale	4793
Lime	4897
Shale & Lime	4989
Lime	5070
Lime	5146
Lime	5160
Lime	5177
Lime	5217
Lime	5225

RECEIVED
STATE DEPARTMENT OF CONSERVATION
NOV 30 1978
CONSERVATION DIVISION
Wichita, Kansas

The undersigned, C. W. Sebitts, Attorney-in-Fact for PICKRELL DRILLING COMPANY, hereby certifies in behalf of said Company, that the above is a true and correct log of the formation encountered in drilling the above well as reflected by the Daily Drilling Reports.