

**IMPORTANT**  
Kans. Geo. Survey request samples on this well.

RECEIVED

MAR 12 1966 S. 6 T. 31 R. 21 K W  
Loc. 1980' FSL & 1830' FWL

API No. 15 — 025 — 20,106  
County Number

County Clark

Operator  
Mesa Petroleum Company

AMA. PROD  
MAR 17 1977

Address  
Box 2009 Amarillo, Texas 79105

Well No. # 4-6 Lease Name Daily

Footage Location  
1980 feet from ~~NE~~ (S) line 1830 feet from (E) (W) line

Principal Contractor Rine Drilling Company Geologist Dave Ward, Denver Office

Spud Date 10/7/76 Total Depth 5338' P.B.T.D. -----

Date Completed 10/23/76 Oil Purchaser -----

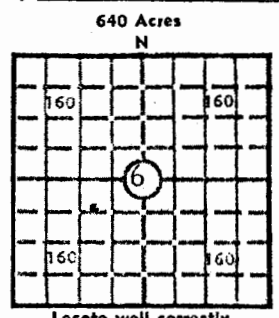

Elev.: Gr. 2156'

DF 2165' KB 2168'

**CASING RECORD**

Report of all strings set — surface, intermediate, production, etc.

Purpose of string	Size hole drilled	Size casing set (in O.D.)	Weight lbs/ft.	Setting depth	Type cement	Sacks	Type and percent additives
Surface	12 1/4"	9 5/8"	32#	728	Light	175	6% gel, 2% CaCl, 1/4# D-29
					"H"	175	3% CaCl

**LINER RECORD**

**PERFORATION RECORD**

Top, ft.	Bottom, ft.	Sacks cement	Shots per ft.	Size & type	Depth interval

**TUBING RECORD**

Size	Setting depth	Packer set at

**ACID, FRACTURE, SHOT, CEMENT SQUEEZE RECORD**

Amount and kind of material used	Depth interval treated

**INITIAL PRODUCTION**

Date of first production	Producing method (flowing, pumping, gas lift, etc.)				
-----					
RATE OF PRODUCTION PER 24 HOURS	Oil	Gas	Water	Gas-oil ratio	
	bbls.	MCF	bbls.	CFPB	
Disposition of gas (vented, used on lease or sold)			Producing interval (s)		

INSTRUCTIONS: As provided in KCC Rule 82-2-125, within 90 days after completion of a well, one completed copy of this Drillers Log shall be transmitted to the State Geological Survey of Kansas, 4150 Monroe Street, Wichita, Kansas 67209. Copies of this form are available from the Conservation Division, State Corporation Commission, 3830 So. Meridian (P.O. Box 17027), Wichita, Kansas 66217. Phone AC 316-522-2206. If confidential custody is desired, please note Rule 82-2-125. Drillers Logs will be on open file in the Oil and Gas Division, State Geological Survey of Kansas, Lawrence, Kansas 66044. XC: KGS (1), Denver Office, File

Operator

MESA PETROLEUM CO.

DESIGNATE TYPE OF COMP.: OIL, GAS, DRY HOLE, SWDW, ETC.:

Well No.

4-6

Lease Name

Daily

DRY HOLE

S 6 T31S R 21W<sup>E</sup><sub>W</sub>

Clark County

**WELL LOG**

Show all important zones of porosity and contents thereof; cored intervals, and all drill-stem tests, including depth interval tested, cushion used, time tool open, flowing and shut-in pressures, and recoveries.

SHOW GEOLOGICAL MARKERS, LOGS RUN, OR OTHER DESCRIPTIVE INFORMATION.

FORMATION DESCRIPTION, CONTENTS, ETC.	TOP	BOTTOM	NAME	DEPTH
<u>SEE ATTACHED DRILLER'S LOG.</u>				

USE ADDITIONAL SHEETS, IF NECESSARY, TO COMPLETE WELL RECORD.

Date Received

S. E. Dobler

Signature

Supervisor, Drilling & Production

Title

November 1, 1976

Date

State Geological Survey  
WICHITA, BRANCH

DAILY #4-6

1980' SL & 1830' WL  
SECTION 6-31S-21W  
CLARK COUNTY, KANSAS

CONTRACTOR: RINE DRILLING COMPANY

STARTED: OCTOBER 7, 1976

COMPLETED: OCTOBER 24, 1976

L O G

Surface	0'	-	41'
Sand & Red Bed	41'	-	112'
Red Bed	112'	-	730'
Red Bed & Anhydrite	730'	-	1167'
Red Bed, Sand, Shale, Lime, & Anhydrite	1167'	-	1830'
Shale & Anhydrite	1830'	-	2235'
Lime & Shale	2235'	-	3457'
Lime, Shale & Sand	3457'	-	3633'
Lime & Shale	3633'	-	5338'

Ran 19 jts. 9 5/8" csg. set @ 728', cmt w/175 sx. 35/65 poz mix, 6% gel, 2% cc, 1/4# D-29 + 175 sx. reg. Class H, 3%cc Totco - 1/2<sup>o</sup> @ 730'

Totco - 1/2<sup>o</sup> @ 1229', 1/4<sup>o</sup> @ 1731'  
Totco - 1/2<sup>o</sup> @ 2235'  
Totco - 1/4<sup>o</sup> @ 2370', 1/2<sup>o</sup> @ 2800'  
Totco - 1/2<sup>o</sup> @ 3489'  
Totco - 1/4<sup>o</sup> @ 4021', 1/2<sup>o</sup> @ 4616'

Plugged through open-end D.P. as follow:  
60 sx. cmt. @ 780', 15 sx. @ 45' to 3'  
5 sx. in RH, 5 sx. in MH  
Cut off 8 5/8" csg. 3' below GL.  
Welded on steel plate w/"Well #1 -  
10/23/76". Job complete @ 6:00 pm  
Kansas State Plugger: Clarence Thomas  
Garden City, Kansas

STATE OF KANSAS )  
COUNTY OF SEDGWICK) ss

I, E. J. Rine, do hereby certify that the above is a true and accurate log of the Daily #4-6, located 1980' SL & 1830' WL of Section 6-31S-21W, Clark County, Kansas.

  
E. J. Rine, President

Subscribed and sworn to before me this 27th day of October, 1976.

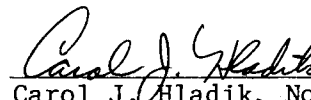
  
Carol J. Hladik, Notary Public

My commission expires: 10/31/79

