

State Geological Survey
 WICHITA, BRANCH
 KANSAS DRILLERS LOG

S. 29 T. 31SR. 3 ^R/_W

API No. 15 - 191 - 20183-0001
 County Number

Loc. C SE

County Sumner

Operator

J. A. Allison

Address

300 W. Douglas, Suite 305, Wichita, Ks.

Well No.

1

Lease Name

Travis OWWO

67202

Footage Location

1320 feet from (N) line

1320

feet from (W) line

Principal Contractor

Gabbert-Jones, Inc.

Geologist

D. Costa

Spud Date

Rework started 3/11/80

Total Depth

4410

P.B.T.D.

Date Completed

rework stopped 3/19/80

Oil Purchaser

Elev.: Gr. 1289

DF _____ KB 1294

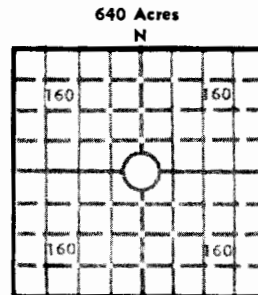

CASING RECORD

Report of all strings set— surface, intermediate, production, etc.

Purpose of string	Size hole drilled	Size casing set (in O.D.)	Weight lbs/ft.	Setting depth	Type cement	Sacks	Type and percent additives
Surface	7 7/8	8 5/8	20#	253'	Common	253	
(Surface casing original rig 253 KB measurements)							

LINER RECORD

PERFORATION RECORD

Top, ft.	Bottom, ft.	Sacks cement	Shots per ft.	Size & type	Depth interval

Size	Setting depth	Packer set at

ACID, FRACTURE, SHOT, CEMENT SQUEEZE RECORD

Amount and kind of material used	Depth interval treated

INITIAL PRODUCTION

Date of first production		Producing method (flowing, pumping, gas lift, etc.)			
RATE OF PRODUCTION PER 24 HOURS	Oil	Gas	Water	Gas-oil ratio	
	bbls.	MCF	bbls.	CFPB	
Disposition of gas (vented, used on lease or sold)			Producing interval(s)		

INSTRUCTIONS: As provided in KCC Rule 82-2-125, within 90 days after completion of a well, one completed copy of this Drillers Log shall be transmitted to the State Geological Survey of Kansas, 4150 Monroe Street, Wichita, Kansas 67209. Copies of this form are available from the Conservation Division, State Corporation Commission, 3830 So. Meridian (P.O. Box 17027), Wichita, Kansas 66217. Phone AC 316-522-2206. If confidential custody is desired, please note Rule 82-2-125. Drillers Logs will be on open file in the Oil and Gas Division, State Geological Survey of Kansas, Lawrence, Kansas 66044.

Operator J. A. Allison DESIGNATE TYPE OF COMP.: OIL, GAS, DRY HOLE, SWDW, ETC.: Dry Hole - OWWO

Well No. 1 Lease Name Travis OWWO

S29 T31 R3 W

WELL LOG

Show all important zones of porosity and contents thereof; cored intervals, and all drill-stem tests, including depth interval tested, cushion used, time tool open, flowing and shut-in pressures, and recoveries.

SHOW GEOLOGICAL MARKERS, LOGS RUN, OR OTHER DESCRIPTIVE INFORMATION.

FORMATION DESCRIPTION, CONTENTS, ETC.	TOP	BOTTOM	NAME	DEPTH
<u>DST #1 - 3442-3462</u>			<u>ELECTRIC LOG TOPS</u>	
Very weak blow (1/2" in bucket) when tool was open. Tool open 90 min; recovered 40' slightly oil cut mud.			Top KC	3288 (-1994)
			Stark	3427 (-2133)
			Hertha	3476 (-2182)
			Base KC	3542 (-2248)
			Miss	3940 (-2646)
IHH 1725 IFP 2-2			Int KC to Miss	652
ISIP 104 FFP 52-31			Kinderhook	4310 (-3016)
FSIP 62 FHH 1715			Int Miss to Kind	370
BHT 116°			Simpson	4388 (-3094)
<u>DST #2 - 3470-3498</u>			Int Kind to Sp	78
Weak, continuous blow (1/2" in bucket) increasing to 4" last 10 min of initial opening. Strong continuous blow off bottom of bucket second open flow. Tool open 90 min, recovered 120' of gas in pipe and 90' heavily oil cut mud.				
IHH 1715 IFP 52-52				
ISIP 229 FFP 62-62				
FSIP 177 FHH 1672				
BHT 116°				
<u>DST #3</u>				
Strong continuous blow off bottom of bucket thruout test. Opened by-pass second opening, tool open 1 hr. 45 min. Gas detected approx. 30 min of final shut-in period. Tool open 1 hr 45 min, recovered 220' gassy, slightly oil cut mud, strong oil odor.			IHH 2052	
			IFP 41-48	
			ISIP 1211	
			FFP 94-104	
			FSIP 1211	
			FHH 2010	
			BHT 122°	

USE ADDITIONAL SHEETS, IF NECESSARY, TO COMPLETE WELL RECORD.

Date Received _____

 Signature
 OPERATOR
 Title
 4/25/80
 Date