

State Geological Survey

28-31-31W ✓

WICHITA, BRANCH
KANSAS DRILLERS' LOG

IMPORTANT
Kans. Geo. Survey request
samples on this well.

API No. 15 — 175 County — 20,254 Number

s. 28 T. 31 R. 31 ^K W
Loc. C SW
County Seward

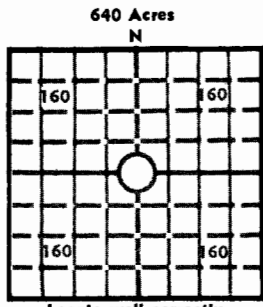

Operator
Imperial Oil Company

Address
720 Fourth Financial Center Wichita, Kansas 67202

Well No. #1-B Lease Name Lippoldt

Footage Location
1320 feet from (N) (S) line 1320 feet from (E) (W) line

Principal Contractor Sage Rig #2 Geologist Richard E. Roby

Spud Date 4-19-75 Total Depth 5660 P.B.T.D.

Date Completed 5-2-75 Oil Purchaser

Elev.: Gr. 2801
DF 2809 KB 2812

CASING RECORD

Report of all strings set — surface, intermediate, production, etc.

Purpose of string	Size hole drilled	Size casing set (in O.D.)	Weight lbs/ft.	Setting depth	Type cement	Socks	Type and percent additives
Surface	12 1/2	8 5/8"	20	1679	Light Common	650 250	2% C.C. 3% C.C.

LINER RECORD

PERFORATION RECORD

Top, ft.	Bottom, ft.	Sacks cement	Shots per ft.	Size & type	Depth interval

TUBING RECORD

Size	Setting depth	Packer set at

ACID, FRACTURE, SHOT, CEMENT SQUEEZE RECORD

Amount and kind of material used	Depth interval treated

INITIAL PRODUCTION

Date of first production Producing method (flowing, pumping, gas lift, etc.)

RATE OF PRODUCTION PER 24 HOURS	Oil	Gas	Water	Gas-oil ratio
	bbls.	MCF	bbls.	CFPB

Disposition of gas (vented, used on lease or sold) Producing interval (s)

INSTRUCTIONS: As provided in KCC Rule 82-2-125, within 90 days after completion of a well, one completed copy of this Drillers Log shall be transmitted to the State Geological Survey of Kansas, 4150 Monroe Street, Wichita, Kansas 67209. Copies of this form are available from the Conservation Division, State Corporation Commission, 3830 So. Meridian (P.O. Box 17027), Wichita, Kansas 66217. Phone AC 316-522-2206. If confidential custody is desired, please note Rule 82-2-125. Drillers Logs will be on open file in the Oil and Gas Division, State Geological Survey of Kansas, Lawrence, Kansas 66044.

Operator

Imperial Oil Company

DESIGNATE TYPE OF COMP.: OIL, GAS, DRY HOLE, SWDW, ETC.:

Dry Hole

Well No.

1-B

Lease Name

Lippoldt

S 27 T 31 R 31 W

WELL LOG

Show all important zones of porosity and contents thereof; cored intervals, and all drill-stem tests, including depth interval tested, cushion used, time tool open, flowing and shut-in pressures, and recoveries.

SHOW GEOLOGICAL MARKERS, LOGS RUN, OR OTHER DESCRIPTIVE INFORMATION.

FORMATION DESCRIPTION, CONTENTS, ETC.	TOP	BOTTOM	NAME	DEPTH
DST #1 5470-86 (Morrow) 30-60-30-60 Rec'd 30' Gas cut mud BHP: 170# - 111 # FP: 35#-35# 40#-40#			Heebner Toronto Lansing Marmaton Cherokee Atoka Morrow	4229 4254 4341 4915 5151 5400 5479
DST #2 5507-5567 (Morrow) 30-60-30-60 Rec'd 35' Mud BHP: 118#-108# FP: 63#-58# 62#-62#			Chester RTD	5550 5660



USE ADDITIONAL SHEETS, IF NECESSARY, TO COMPLETE WELL RECORD

Date Received

J. J. Kelly
 Signature
 Geologist
 Title

5-9-75

Date

15-15-20254
28-31-31W
Dup

State Geological Survey
WICHITA

DRILLERS LOG

LIPPOLDT "B" NO. 1

CASING RECORD:	OPERATOR: Imperial Oil Company	DESCRIPTION:
8-5/8" set @ 1690' w/850 sax cement	CONTRACTOR: Sage Drilling Co.	C SW/4 Sec. 28-31S-31W Seward Co., Kans.
TOTAL DEPTH: 5660'	COMMENCED: April 19, 1975	ELEVATION: 2812KB
	COMPLETED: May 2, 1975	

<u>FORMATION</u>	<u>FROM</u>	<u>TO</u>	<u>REMARKS</u>
Surface Soil & Sand	0	915	
Red Bed & Sand	915	1562	
Shale & Anhydrite	1562	2200	
Anhydrite	2200	2437	
Anhydrite & Dolomite	2437	2615	
Dolomite	2615	2792	
Lime & Shale	2792	5358	
Lime	5358	5419	
Lime & Shale	5419	5660	D&A



I certify that this is a true and correct copy of the above log to the best of my knowledge.

SAGE DRILLING CO., INC.

By John R. Bartholomew
John R. Bartholomew



Subscribed and sworn to before me this 7th day of May, 1975.

[Handwritten signature]