

**KANSAS DRILLERS LOG**

State Geological Survey  
WICHITA, BRANCH

S. 33 T. 31S R. 32 W

API No. 15 — N/A —  
County Number

Loc. C NE $\frac{1}{4}$

County Seward

Operator  
Graham-Michaelis Corporation

Address  
P.O. Box 247, Wichita, Kansas 67201

Well No. 1 Lease Name Printz

Footage Location  
1320 feet from (N) line 1320 feet from (W) line NE $\frac{1}{4}$

Principal Contractor Geologist  
Graham-Michaelis Drilling Co. George Burge

Spud Date Total Depth P.B.T.D.  
March 30, 1957 2742' N/A

Date Completed Oil Purchaser  
May 12, 1957 none

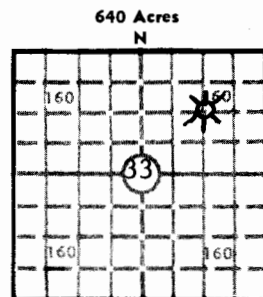

Locate well correctly  
Elev.: Gr. 2848'

DF 2850' KB 2853'

**CASING RECORD**

Report of all strings set — surface, intermediate, production, etc.

Purpose of string	Size hole drilled	Size casing set (in O.D.)	Weight lbs/ft.	Setting depth	Type cement	Sacks	Type and percent additives
To protect fresh water		8 5/8"	28#	565		300	
Production		5 1/2"	14#	2741		300	

**LINER RECORD**

**PERFORATION RECORD**

Top, ft.	Bottom, ft.	Sacks cement	Shots per ft.	Size & type	Depth interval
none					2632-2638
<b>TUBING RECORD</b>					2688-2698'
Size	Setting depth	Packer set at			2658-2670

**ACID, FRACTURE, SHOT, CEMENT SQUEEZE RECORD**

Amount and kind of material used	Depth interval treated
500 gals 15% reg. acid, 4,000 gals Dolofrac, 1# sand/gal	2688-2698 overall
1,000 gals 7½% Doloflush.	
750 gals 15% reg. acid, 5,000 gals Dolofrac, 1# sand/gal	2632-2670 overall

**INITIAL PRODUCTION**

Date of first production May 12, 1957	Producing method (flowing, pumping, gas lift, etc.) flowing				
<b>RATE OF PRODUCTION PER 24 HOURS</b>	Oil none	Gas 5,010	Water MCF	Gas-oil ratio bbls.	CFPB
Disposition of gas (vented, used on lease or sold) sold			Producing interval (s) 2632-2698 overall		

INSTRUCTIONS: As provided in KCC Rule 82-2-125, within 90 days after completion of a well, one completed copy of this Drillers Log shall be transmitted to the State Geological Survey of Kansas, 4150 Monroe Street, Wichita, Kansas 67209. Copies of this form are available from the Conservation Division, State Corporation Commission, 3830 So. Meridian (P.O. Box 17027), Wichita, Kansas 66217. Phone AC 316-522-2206. If confidential custody is desired, please note Rule 82-2-125. Drillers Logs will be on open file in the Oil and Gas Division, State Geological Survey of Kansas, Lawrence, Kansas 66044.

Operator  
Graham-Michaelis Corporation

DESIGNATE TYPE OF COMP.: OIL, GAS,  
DRY HOLE, SWDW, ETC.:

Well No. 1 Lease Name Printz Gas

S 33 T 31 S. R. 32 <sup>E</sup>/<sub>W</sub> C NE 1/4, Seward County, Kansas

**WELL LOG**

Show all important zones of porosity and contents thereof; cored intervals, and all drill-stem tests, including depth interval tested, cushion used, time tool open, flowing and shut-in pressures, and recoveries.

SHOW GEOLOGICAL MARKERS, LOGS RUN,  
OR OTHER DESCRIPTIVE INFORMATION.

FORMATION DESCRIPTION, CONTENTS, ETC.	TOP	BOTTOM	NAME	DEPTH
Soil & Sand	0	8	Halliburton Electric Well Log	
Sand & Clay	8	104		
Sand	104	142		
Sand & Clay	142	420		
Clay, Sand & Red Bed	420	560		
Shale, Sand & Clay	560	1150		
Sand	1150	1350		
Shale, Lime & Gyp	1350	1550		
Shale, Anhy, Sand & Gyp	1550	1890		
Shale & Gyp	1890	2340		
Shale & Gyp	2340	2445		
Lime & Shale	2445	2555		
Lime & Shale	2555	2742		
R.T.D.	2742			
No drill stem tests run				

USE ADDITIONAL SHEETS, IF NECESSARY, TO COMPLETE WELL RECORD.

Date Received

*Muriel F. C. Jeram*  
Signature  
Geological Secretary  
Title  
March 13, 1980  
Date

WELL LOG BUREAU—KANSAS GEOLOGICAL SOCIETY  
508 East Murdock, Wichita, Kansas

Company- GRAHAM-MICHAELIS DRIG. CO.  
Farm- Printz No. 1

SEC. 33 T. 31 R. 32W  
C NE/4

Total Depth. 2742'  
Comm. 3-30-57 Comp. 4-12-57  
Shot or Treated.  
Contractor. Graham-Michaelis Drig.  
Issued. 5-3-58

County Seward  
KANSAS

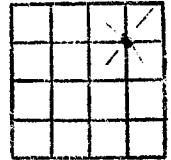

CASING:  
8 5/8" 558' cem w/300 sx.  
5 1/2" 2741' cem w/300 sx.

Elevation. 2850'

Production. 5,010,000 CFG

Figures Indicate Bottom of Formations.

soil & sand	8
sand & clay	104
sand	142
sand & clay	420
clay, sand & red bed	560
shale, sand & clay	1150
sand	1350
shale, lime & gyp	1550
shale, Anhy., sand, gyp	1890
shale & gyp	2340
shale & gyp	2445
lime & shale	2555
lime & shale	2742 RTD
Total Depth	

TOPS: SCOUT	
Herington	2628
Upper Krider	2654
Lower Krider	2681
Winfield	2730