

22-31-33W

KANSAS DRILLERS LOG

State Geological Survey
WICHITA, BRANCH

S. 22 T. 31S R. 33 W
Loc. 2690' FSL & 1250' FEL
County Seward

API No. 15 — 175 — 20,250
County Number

Operator
Amoco Production Company

Address
P. O. Box 432 - Liberal, Kansas 67901

Well No. 2 Lease Name Prater Gas Unit "A"

Footage Location
2690 feet from (N) (S) line 1250 feet from (E) (W) line

Principal Contractor Service Drilling Company Geologist

Spud Date 2-11-75 Total Depth 3400 P.B.T.D. 3060

Date Completed 4-14-75 Oil Purchaser

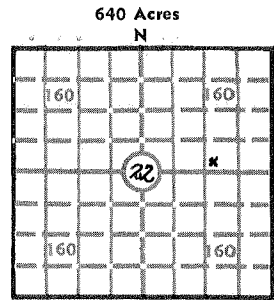

Elev.: Gr. 2877'
DF KB 2884

CASING RECORD

Report of all strings set — surface, intermediate, production, etc.

Purpose of string	Size hole drilled	Size casing set (in O.D.)	Weight lbs./ft.	Setting depth	Type cement	Sacks	Type and percent additives
Surface	12-1/4	8-5/8	28#	591.66	Howco "H"	400	2% CACL
Production	7-7/8	5-1/2	15#	3413.42	Howco Specail	900	18% CACL

LINER RECORD

PERFORATION RECORD

Top, ft.	Bottom, ft.	Sacks cement	Shots per ft.	Size & type	Depth interval
TUBING RECORD			See other side		
Size	Setting depth	Packer set at			

ACID, FRACTURE, SHOT, CEMENT SQUEEZE RECORD

Amount and kind of material used	Depth interval treated
See Other Side	

INITIAL PRODUCTION

Date of first production None Producing method (flowing, pumping, gas lift, etc.) Dry Hole

RATE OF PRODUCTION PER 24 HOURS
Oil bbls. Gas None MCF Water bbls. Gas-oil ratio CFPB

Disposition of gas (vented, used on lease or sold) Producing interval (s) None

INSTRUCTIONS: As provided in KCC Rule 82-2-125, within 90 days after completion of a well, one completed copy of this Drillers Log shall be transmitted to the State Geological Survey of Kansas, 4150 Monroe Street, Wichita, Kansas 67209. Copies of this form are available from the Conservation Division, State Corporation Commission, 3830 So. Meridian (P.O. Box 17027), Wichita, Kansas 66217. Phone AC 316-522-2206. If confidential custody is desired, please note Rule 82-2-125. Drillers Logs will be on open file in the Oil and Gas Division, State Geological Survey of Kansas, Lawrence, Kansas 66044.

Operator **Amoco Production Company** DESIGNATE TYPE OF COMP.: OIL, GAS, DRY HOLE, SWDW, ETC.: **Dry Hole**

Well No. **2** Lease Name **Prater Gas Unit "A"**

S 22 T 31S R 33 W

WELL LOG

Show all important zones of porosity and contents thereof; cored intervals, and all drill-stem tests, including depth interval tested, cushion used, time tool open, flowing and shut-in pressures, and recoveries.

SHOW GEOLOGICAL MARKERS, LOGS RUN, OR OTHER DESCRIPTIVE INFORMATION.

FORMATION DESCRIPTION, CONTENTS, ETC.	TOP	BOTTOM	NAME	DEPTH
Sand, Red Bed	0	596		
Sand, Red Bed, Shale	596	1387		
Sand, Anhydrite, Lime, Shale	1387	2249		
Shale, Lime	2249	3151		
Lime	3151	3400		
TD	3400			
Acidized with 5000 gals. 15% HCL and Squeezed with 300 sacks of cement to 3000#.		3162-82, 3198-		3220, 3230-50
Acidized with 5000 gals 15% HCL and Squeezed with 250 sacks of cement to 3000#		3067-94, 3104-		35
Acidized with 6000 gals. 15% HCL and 300 Ball Sealers. Squeezed with 200 sacks of cement to 3000#		2920-68, 3031-50		2982-3016
<u>WILL HOLD FOR POSSIBLE HUGOTON WELL REPLACEMENT</u>				

USE ADDITIONAL SHEETS, IF NECESSARY, TO COMPLETE WELL RECORD.

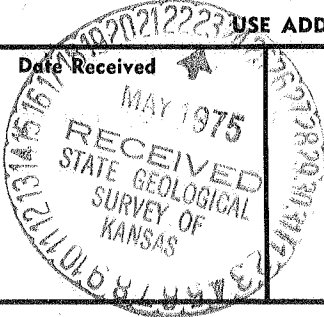

[Signature] **F. J. Rader**
 Signature
Administrative Assistant
 Title
April 16, 1975
 Date