

RELEASED
 JAN 1 1988
 STATE CORPORATION COMMISSION OF KANSAS
 FROM CONFIDENTIALITY DIVISION
 WELL COMPLETION OR RECOMPLETION FORM

11-4-88

18-31-35W 111K/89
 KCC

SIDE ONE

FORMALLY: D.G. HINSHAW WELL #1 *

API No. 15-189-21086
 COUNTY STEVENS
 SW NE Sec 18 Twp 31S Rge 35 East X West
 3300 Ft North from Southeast Corner of Section
 2020 Ft West from Southeast Corner of Section
 (Note: Locate well in section plat below)
 Lease Name HINSHAW ESTATE UNIT WELL # 4
 Field Name UNNAMED
 Producing Formation MORROW *
 Elevation: Ground 2994' KB 3005'

Operator: License # 5208
 Name MOBIL OIL CORPORATION
 Address P.O. BOX 5444
 City/State/Zip DENVER, COLORADO 80217

Purchaser SOLD ON SPOT MARKET---TRANSPORTED BY
 WILLIAMS NATURAL GAS
 P.O. BOX 3288, TULSA, OK 74101

Operator Contact Person B. R. MAYNARD
 Phone (303) 298-2069

Contractor: License # 5382
 Name CHEYENNE DRILLING INC.

Wellsite Geologist T.A. METARKO
 Phone (303) 298-2327

Designate Type of Completion
 XX New Re-Entry Workover
 Oil SWD Temp Abd
 XX Gas Inj Delayed Comp.
 Dry Other (Core, Water Supply, etc.)

If ~~OWMO~~: old well info as follows;
 Operator
 Well Name
 Comp. Date

KANSAS GEOLOGICAL SURVEY
 WICHITA BRANCH

JAN 26 1988

RECEIVED
 STATE CORPORATION COMMISSION
 NOV 10 1988
 CONSERVATION DIVISION
 Wichita, Kansas

SECTION PLAT

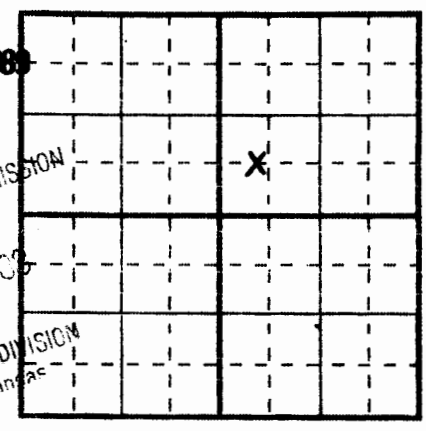

WATER SUPPLY INFORMATION

Disposition of Produced Water: XX Disposal
 Docket # CD-11793 Repressuring

Questions on this portion of ACO-1 call:
 Water Resources Board (913) 296-3717

Source of Water:
 Division of Water Resources Permit# T87-290

XX Groundwater 3330 Ft. North from Southeast Corner
 (well) 2215 Ft. West from Southeast Corner of
 Sec 18 Twp 31S Rge 35 East X West

Surface Water Ft. North from Southeast Corner
 (Stream, pond etc) Ft. West from Southeast Corner
 Sec Twp Rge East West

Other (explain)
 (purchased from city, R.W.D. #)

WELL HISTORY
 Drilling Method:
 XX Mud Rotary Air Rotary Cable
 7-27-87 8-5-87 8-21-87
 Spud Date Date Reached TD Completion Date
 6230' 6188'
 Total Depth PBSD
 Amount of Surface Pipe Set and Cemented at 1750 feet
 Multiple Stage Cementing Collar Used? XX Yes No
 If yes, show depth set 3150 feet
 If alternate 2 completion, cement circulated
 from feet depth to w/ SX cmt
 Cement Company Name
 Invoice #

INSTRUCTIONS: This form shall be completed in triplicate and filed with the Kansas Corporation Commission, 200 Colorado Derby Building, Wichita, Kansas 67202, within 120 days of the spud date of any well. Rule 82-3-130, 82-3-107, and 82-3-106 apply.
 Information on side two of this form will be held confidential for a period of 12 months if requested in writing and submitted with the form. See rule 82-3-107 for confidentiality in excess of 12 months.
 One copy of all wireline logs and drillers time log shall be attached with this form. Submit cp-4 form with all plugged wells. Submit cp-111 form with all temporarily abandoned wells.

All requirements of statutes, rules and regulations promulgated to regulate the oil and gas industry have been fully complied with and the statements herein are complete and correct to the best of my knowledge.

Signature B. R. Maynard B. R. MAYNARD

Title REGULATORY COMPLIANCE MANAGER Date 11-4-88

Subscribed and sworn to before me this 4th day of November 1988
 Notary Public James George
 Date Commission Expires 1/3/91

K.C.C. OFFICE USE ONLY
 Letter of Confidentiality Attached
 Wireline Log Received
 Drillers Timelog Received
 Distribution
 KCC SWD/Rep NGPA
 KGS Plug Other
 (Specify)

KANSAS GEOLOGICAL SURVEY
 WICHITA BRANCH

NOV 17 1988

Form ACO-1 (5-86)

SIDE TWO

Operator Name MOBIL OIL CORPORATION Lease Name HENSHAW ESTATE UNIT Well # 4

Sec 18 Twp 31S Rge 35W XX East
XX West County STEVENS

WELL LOG

INSTRUCTIONS: Show important tops and base of formations penetrated. Detail all cores. Report all drill stem tests giving interval tested, time tool open and closed, flowing and shut-in pressures, whether shut-in pressure reached static level, hydrostatic pressures, bottom hole temperature, fluid recovery, and flow rates if gas to surface during test. Attach extra sheet if more space is needed. Attach copy of log.

Drill Stem Tests Taken XX Yes No
 Samples Sent to Geological Survey XX Yes No
 Cores Taken Yes XX No

Formation Description
XX Log Sample

Name	Top	Bottom
STONE CORRAL		1754'
SUMNER	2187'	
CHASE	2567'	
WINFIELD	2644'	
COUNCIL GROVE	2858'	
ADMIRE	3122'	
WABAUNSEE	3271'	
SHAWNEE	3648'	
LANSING	4184'	
KANSAS CITY	4430'	
HARMATON	4858'	
CHEROKEE	5056'	
MORROW	5466'	
CHESTER	5764'	
STE. GENEVIEVE	6048'	
ST. LOUIS	6230'	

CASING RECORD

XX New Used

Report all strings set-conductor, surface, intermediate, production, etc.

Purpose of String	Size Hole Drilled	Size Casing Set (in. O.D.)	Weight Lbs/Ft.	Setting Depth	Type of Cement	# Sacks Used	Type and Percent Additives
Surface	12-1/4"	8-5/8"	24#	1750'	CL C	565 SX	65:35:6
					CL C	175 SX	+5% CaCl ₂
Production	7-7/8"	5-1/2"	14#	6230'	CL H	350 SX	50:50:2
					CL H	265 SX	50:50:2 +2% CaCl ₂

PERFORATION RECORD

Acid, Fracture, Shot, Cement Squeeze Record

Shots Per Foot	Specify Footage of Each Interval Perforated	(Amount and Kind of Material Used)	Depth
4 SPF	5550'-5562'	48 shots	5550'-
			5562' DA

TUBING RECORD Size 2-7/8" Set At 5480' Packer At 5480' Liner Run Yes XX No

Date of First Production 11-9-87 Producing Method XX Flowing Pumping Gas Lift Other (explain)

Estimated Production Per 24 Hours	CONDENSATE	Gas	Water	Gas-Oil Ratio	Gravity
	<u>12</u> Bbls	<u>3500</u> MCF	<u>0</u> Bbls	<u> </u> CFPB	

METHOD OF COMPLETION

Disposition of gas: Vented Open Hole XX Perforation
XX Sold Other (Specify)
 Used on Lease Dually Completed
 Commingled

Production Interval
5550'-5562' DA

Mobil Oil Corporation

001-228 2-72

DENVER EAST DIVISION DRILL STEM TEST REPORT FORM

WELL NAME O.G. Hinshaw #1

Well Number 21 Hole Size 7 7/8
 Well Section Shallow Conventional Infusible Straddle
 Interval 5564.7' - 5598' Top Pfr Set @ 5558.9' Btm Pfr Set @ 5564.7'
 Depth 5598 Type of Cushion Fluid NONE
 Company Halliburton SERVICES Amount of Cushion 0

TEST DATA:

Tool open at 0845 hours. 8-3-87 Date.
 Initial open period _____ mins. 15
 Initial shut-in period _____ mins. 30
 Final flow period _____ mins. 60
 Final shut-in period _____ mins. 120
 Description of blow on initial open period Steady blow off bottom of bucket in 20 seconds
Then flow out to pit after 2 minutes. Gas to surface in 1 minute
 Description of blow during test Stable gas flow @ 415 Psi

G.T.S. 5 mins; O.T.B. _____ mins; Bottom hole choke size .750
 Surface choke size .625
 Flow Rate: Gas 4144.00 C.F.P.D. OR 4144.0 MCF/DAY B.P.H. G.O.R. _____
 Gravity of Gas _____ Gravity of Oil CANDIAN SATE 57
 Total fluid recovered 100 ft limited water

Resistivity of H₂O NONE Chlorides of H₂O 5000 P.P.M.
 Depth of top press bomb 5543.7 ft Bottom bomb 5594.7 ft

ESSURE DATA:

Top Bomb:		Bottom Bomb:
L.H.P. <u>2461.3</u>		L.H.P. <u>2490.4</u>
L.F.P. <u>504.9</u> to <u>694.0</u>		L.F.P. <u>513.0</u> to <u>719.4</u>
L.S.I.P. <u>1678.5</u>		L.S.I.P. <u>1674.2</u>
F.F.P. <u>983.7</u>		F.F.P. <u>224.7</u> to <u>313.0</u>
F.S.I.P. <u>1662.4</u>		F.S.I.P. <u>1683.9</u>
F.H.P. <u>2461.3</u>		F.H.P. <u>2490.4</u>
Temp. <u>120° F</u>		Temp. <u>120° F</u>
Was S.I.P. bulding? <u>No</u>		

WPLE CHAMBER DATA:

Gas 24.51 C.F.
 Oil Condensate 10.0 C.C.
 H₂O _____ C.C.
 Mud _____ C.C.
 Sample Chamber Pressure 412 psi

MARKS:

RECEIVED
 STATE CORPORATION COMMISSION

MAR 31 1988

RELEASED

SIDE ONE

11/20/88
KCC

Date: DEC 1 1988
STATE CORPORATION COMMISSION OF KANSAS

OIL & GAS CONSERVATION DIVISION
FROM CONFIDENTIAL
WELL COMPLETION OR RECOMPLETION FORM
ACO-1 WELL HISTORY

DESCRIPTION OF WELL AND LEASE

Operator: License # 5208
Name Mobil Oil Corporation
Address P.O. Box 5444
City/State/Zip Denver, CO 80217

Purchaser INFO. NOT AVAILABLE AT THIS TIME

Operator Contact Person D. H. Lawrence
Phone 303-298-2698

Contractor: License # 5382
Name Cheyenne Drilling Inc.

Wellsite Geologist T. A. Metarko
Phone 303-298-2327

Designate Type of Completion
 New Well Re-Entry Workover
 Oil Gas Dry
 SWD Inj Other (Core, Water Supply etc.)
 Temp Abd Delayed Comp.

If ONWO: old well info as follows:
Operator
Well Name
Comp. Date
Old Total Depth

WELL HISTORY

Drilling Method:
 Mud Rotary Air Rotary Cable
7-27-87 8-5-87 8-21-87
Spud Date Date Reached TD Completion Date
6230' 6188'
Total Depth PBDT

Amount of Surface Pipe Set and Cemented at 1750 feet
Multiple Stage Cementing Collar Used? Yes No
If yes, show depth set 3150 feet
If alternate 2 completion, cement circulated from...feet depth to...w/...SX cmt
Cement Company Name
Invoice #

API NO. 15-189-21086
County Stevens
SW NE Sec. 18 Twp. 31S Rge. 35 East
West

3300 Ft North from Southeast Corner of Section
2020 Ft West from Southeast Corner of Section
(Note: Locate well in section plat below)

Lease Name O. G. Hinshaw Well # 1

Field Name Unnamed

Producing Formation Chester

Elevation: Ground 2994' KB 3005'

Section Plat

KANSAS GEOLOGICAL SURVEY
WICHITA BRANCH

DEC 15 1988

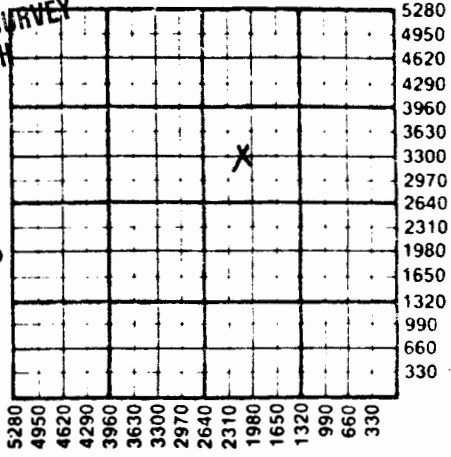

WATER SUPPLY INFORMATION

Disposition of Produced Water: Disposal
Docket # Repressuring
INFO NOT AVAILABLE AT THIS TIME

Questions on this portion of the ACO-1 call:
Water Resources Board (913) 296-3717
Source of Water:
Division of Water Resources Permit # T87-290

Groundwater 3330 Ft North from Southeast Corner
(Well) 2215 Ft West from Southeast Corner of
Sec 18 Twp 31S Rge 35 East West
 Surface Water...Ft North from Southeast Corner
(Stream, pond etc)...Ft West from Southeast Corner
Sec Twp Rge East West
 Other (explain)
(purchased from city, R.W.D. #)

INSTRUCTIONS: This form shall be completed in triplicate and filed with the Kansas Corporation Commission, 200 Colorado Derby Building, Wichita, Kansas 67202, within 120 days of the spud date of any well. Rule 82-3-130, 82-3-107 and 82-3-106 apply.
Information on side two of this form will be held confidential for a period of 12 months if requested in writing and submitted with the form. See rule 82-3-107 for confidentiality in excess of 12 months.
One copy of all wireline logs and drillers time log shall be attached with this form. Submit CP-4 form with all plugged wells. Submit CP-111 form with all temporarily abandoned wells.

All requirements of the statutes, rules and regulations promulgated to regulate the oil and gas industry have been fully complied with and the statements herein are complete and correct to the best of my knowledge.

Signature *D. H. Lawrence* D. H. Lawrence

Title General Accounting Supervisor Date 11-17-87

Subscribed and sworn to before me this 17th day of November 1988

Notary Public *[Signature]*

Date Commission Expires *[Signature]*

K.C.C. OFFICE USE ONLY
 Letter of Confidentiality Attached
 Wireline Log Received
 Drillers Timelog Received
Distribution
 KCC SWD/Rep NGPA
 KGS Plug Other
(Specify)

Sec 18, Twp 31, Rge 35 E

KANSAS GEOLOGICAL SURVEY
WICHITA BRANCH

NOV 24 1987

Form ACO-1 (5-86)

SIDE TWO

Operator Name Mobil Oil Corp Lease Name O. G. Hinshaw Well # 1

Sec. 18 Twp. 31S Rge. 35 East West County Stevens

WELL LOG

INSTRUCTIONS: Show important tops and base of formations penetrated. Detail all cores. Report all drill stem tests giving interval tested, time tool open and closed, flowing and shut-in pressures, whether shut-in pressure reached static level, hydrostatic pressures, bottom hole temperature, fluid recovery, and flow rates if gas to surface during test. Attach extra sheet if more space is needed. Attach copy of log.

Drill Stem Tests Taken Yes No
 Samples Sent to Geological Survey Yes No
 Cores Taken Yes No

Formation Description
 Log Sample

SEE ATTACHED

Name	Top	Bottom
Base Stone Corral	1754	
Sumner	2187	
Chase	2567	
Winfield	2644	
Council Grove	2858	
Admire	3122	
Wabaunsee	3271	
Shawnee	3648	
Lansing	4184	
Kansas City	4430	
Marmaton	4858	
Cherokee	5056	
Morrow	5466	
Chester	5764	
St. Genevieve	6048	
St. Louis	6080	
TD	6230	

CASING RECORD <input checked="" type="checkbox"/> New <input type="checkbox"/> Used							
Report all strings set-conductor, surface, intermediate, production, etc.							
Purpose of String	Size Hole Drilled	Size Casing Set (in O.D.)	Weight Lbs/Ft.	Setting Depth	Type of Cement	#Sacks Used	Type and Percent Additives
Surface	12-1/4"	8-5/8"	24#	1750'	Cl C	565	65:35:6 C: Poz: Gel,
Production	7-7/8"	5-1/2"	14#	6230'	Cl C	175/5%	CaCl ₂ 1/2# cellid-flak
					Cl H	350	50:50 H: Poz. 2% Gel
					Cl H	265	50:50 H: Poz. 2% Gel

PERFORATION RECORD		Acid, Fracture, Shot, Cement Squeeze Record	
Shots Per Foot	Specify Footage of Each Interval Perforated	(Amount and Kind of Material Used)	Depth
4 SPF	5550-5562	48 shots	5550-5562

TUBING RECORD	Size	Set At	Packer at	Liner Run	<input type="checkbox"/> Yes <input checked="" type="checkbox"/> No
NOT AVBL AT THIS TIME					

Date of First Production	Producing Method
INFO NOT AVAILABLE AT THIS TIME	<input type="checkbox"/> Flowing <input type="checkbox"/> Pumping <input type="checkbox"/> Gas Lift <input type="checkbox"/> Other (explain).....

Estimated Production Per 24 Hours	Oil	Gas	Water	Gas-Oil Ratio	Gravity
	Bbls	MCF	Bbls	CFPB	
INFO NOT AVAILABLE AT THIS TIME					

METHOD OF COMPLETION

Production Interval

Disposition of gas: Vented Open Hole Perforation
 Sold Other (Specify) 5550-5562
 Used on Lease Dually Completed
 Commingled

Ref

18-31-35W

DRILLERS LOG

MOBIL OIL CORPORATION
O.G. HINSHAW #1
SECTION 18-T31S-R35W
STEVENS COUNTY, KANSAS

COMMENCED: 7-27-87
COMPLETED: 8-6-87

AUG 18 1987

SURFACE CASING: 1750' OF 8 5/8"
CMTD W/565 SX 65-35 POZ MIX
2% C.C., 1/4# CELOFLAKE, TAILED
IN W/175 SX 65/35 POZ MIX, 3% C.C.

KANSAS GEOLOGICAL SURVEY
WICHITA BRANCH

FORMATION	DEPTH
CONDUCTOR CASING	0- 60
SURFACE HOLE	60-1750
ANHYDRITE & SHALE	1750-1990
RED BED & ANHYDRITE	1990-2490
SHALE & LIME	2490-2700
LIMESTONE & SHALE	2700-3074
LIME & SHALE	3074-3385
SHALE & LIME	3385-3700
LIMESTONE & SHALE	3700-3969
LIME & SHALE	3969-5125
SHALE & LIME	5125-5164
LIME & SHALE	5164-6230 RTD

I DO HEREBY CERTIFY THAT THE FOREGOING STATEMENTS ARE TRUE AND CORRECT
TO THE BEST OF MY KNOWLEDGE AND BELIEF.

CHEYENNE DRILLING, INC.

Claude E. Norwood
CLAUDE E. NORWOOD

RECEIVED
STATE CORPORATION COMMISSION

STATE OF KANSAS :ss:

AUG 17 1987

SUBSCRIBED AND SWORN TO BEFORE ME THIS 13TH DAY OF AUGUST, 1987.

CONSERVATION DIVISION
Wichita, Kansas

PAM KAISER
NOTARY PUBLIC
STATE OF KANSAS
MY APPT. EXPIRES 3-5-91

Pam Kaiser
PAM KAISER, NOTARY PUBLIC