

Ind.

STATE CORPORATION COMMISSION OF KANSAS
OIL & GAS CONSERVATION DIVISION
WELL COMPLETION OR RECOMPLETION FORM
ACO-1 WELL HISTORY
DESCRIPTION OF WELL AND LEASE

Operator: License # 04824
Name Mesa Operating Limited Partnership
Address P.O. Box 2009
Amarillo, Texas 79189
City/State/Zip

Purchaser: Kansas Power & Light
818 Kansas Ave., Topeka, Kansas

Operator Contact Person Wayne Riddle
Phone (316) 356-3026

Contractor: License # 5987
Name Service Drilling Co.

Site Geologist
Phone

Designate Type of Completion

New Well Re-Entry Workover

Oil SWD Temp Abd
 Gas Inj Delayed Comp.
 Dry Other (Core, Water Supply etc.)

If **OWNO**: old well info as follows:

Operator
Well Name
Comp. Date Old Total Depth

WELL HISTORY

Drilling Method:

Mud Rotary Air Rotary Cable

2/7/87 2/10/87 3/12/87
Spud Date Date Reached TD Completion Date

3000' 2915'
Total Depth PBTD

Amount of Surface Pipe Set and Cemented at 638' feet
Multiple Stage Cementing Collar Used? Yes No
If yes, show depth set...feet
If alternate 2 completion, cement circulated from...feet depth to...w/...SX cmt
Cement Company Name
Invoice #

Estimated Production Per 24 Hours	Oil	Gas	Water	Gas-Oil Ratio	Gravity
	-- Bbls	2319MCF	-- Bbls	-- CFFB	--

METHOD OF COMPLETION

Production Interval

Disposition of gas: Vented Sold

Open Hole Perforation Other (Specify)

2456'-2788'

API NO. 15-189-20,967
County: Stevens
NW NW SE Sec 19 Twp 31S Rge 37 East XX West

1300 Ft North from Southeast Corner of Section
2500 Ft West from Southeast Corner of Section
(Note: Locate well in section plat below)

Lease Name: FULK Well # 3-19

Field Name: Hugoton - Infill

Producing Formation: Chase

Elevation: Ground 3130' KB 3137'

Section Plat

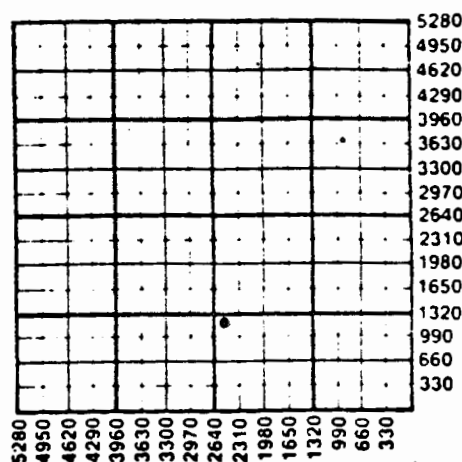

WATER SUPPLY INFORMATION

Disposition of Produced Water: Disposal
Docket # NA Repressuring

Questions on this portion of the ACO-1 call:

Water Resources Board (913) 296-3717

Source of Water:
Division of Water Resources Permit #

Groundwater...Ft North from Southeast Corner (Well) ...Ft West from Southeast Corner of Sec Twp Rge East West

Surface Water...Ft North from Southeast Corner (Stream, pond etc.)...Ft West from Southeast Corner Sec Twp Rge East West

XX Other (explain) Latham Water Service (purchased from city, R.W.D. #)

SIDE TWO

Operator Name Mesa Operating Limited Partnership Lease Name FULK Well # 3-19

Sec 19 Twp 31S Rge 37 East West County Stevens

WELL LOG

INSTRUCTIONS: Show important tops and base of formations penetrated. Detail all cores. Report all drill stem tests giving interval tested, time tool open and closed, flowing and shut-in pressures, whether shut-in pressure reached static level, hydrostatic pressures, bottom hole temperature, fluid recovery, and flow rates if gas to surface during test. Attach extra sheet if more space is needed. Attach copy of log.

Drill Stem Tests Taken Yes No
 Samples Sent to Geological Survey Yes No
 Cores Taken Yes No

Formation Description
 Log Sample

Name	Top	Bottom
Stone Corral	1675'	
Wellington	2250'	
Chase	2456'	
Council Grove	2790'	

CASING RECORD New Used

Report all strings set-conductor, surface, intermediate, production, etc.

Purpose of String	Size Hole Drilled	Size Casing Set (in O.D.)	Weight Lbs/Ft.	Setting Depth	Type of Cement	#Sacks Used	Type and Percent Additives
Surface	12 1/4"	8 5/8"	24#	638'	C	275	3% CaCl
Production	7 7/8"	5 1/2"	15.5#	3000'	C/H	530	5% Kcl

PERFORATION RECORD

Acid, Fracture, Shot, Cement Squeeze Record

Shots Per Foot	Specify Footage of Each Interval Perforated	(Amount and Kind of Material Used)	Depth
1 JS/2'	2456'-2788'	7700 gals 15% Hcl 98,330 gals x-linked gel + 256,100# 12/20 sand	2456'- 2788'

TUBING RECORD Size NA Set At Packer at Liner Run Yes No

Date of First Production Not Connected Producing Method Flowing Pumping Gas Lift Other (explain).....

PLAT AND CERTIFICATION OF ACREAGE ATTRIBUTABLE TO A GAS WELL

CG-8

State Corporation Commission, Conservation Division
200 Colorado Derby Bldg. Wichita, Kansas 67202

OPERATOR Mesa Operating Limited Partnership LOCATION OF WELL

LEASE FULK

1300 feet from the South line
2500 feet from the East line

WELL NUMBER #3-19

Of the SE/4 of Sec. 19 T. 31S. R. 37W

FIELD Kansas Hugoton

COUNTY Stevens

ORDER GRANTING ALLOWABLE ENTERED IN DOCKET NO. 153,649-C (C-22,263)

NUMBER OF ACRES
ATTRIBUTABLE TO WELL 618

DESCRIPTION OF ACREAGE:

PLAT

(Show location of Well and outline attributable acreage)

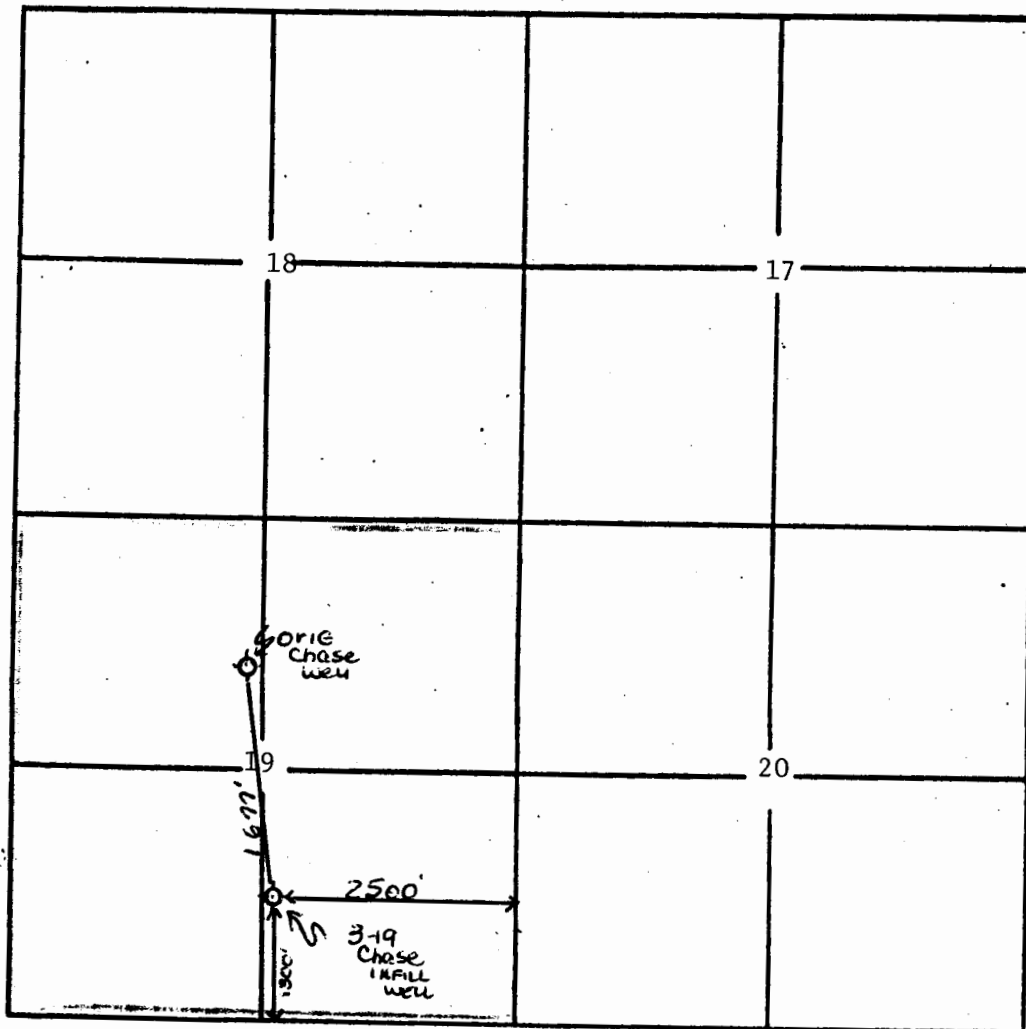

The undersigned hereby certifies that she is Regulatory Analyst
for Mesa Operating Limited Partnership, a duly authorized agent, that all infor-