

Inc

STATE CORPORATION COMMISSION OF KANSAS  
OIL & GAS CONSERVATION DIVISION  
WELL COMPLETION OR RECOMPLETION FORM  
ACO-1 WELL HISTORY  
DESCRIPTION OF WELL AND LEASE

API NO. 15-.....189-20,976.....  
County.....Stevens.....  
NW SE NW Sec. 16 Twp. 31S Rge. 37 East  
..... West

Operator: License # .....04824.....  
Name MESA OPERATING LIMITED PARTNERSHIP  
Address P.O. BOX 2009  
.....AMARILLO, TEXAS 79189.....  
City/State/Zip .....

3935' ..... Ft North from Southeast Corner of Section  
3800' ..... Ft West from Southeast Corner of Section  
(Note: Locate well in section plat below)

Purchaser KANSAS POWER & LIGHT  
818 KANSAS AVE., TOPEKA, KANSAS

Lease Name.....WHEATLEY.....Well #.....3-16.....

Operator Contact Person WAYNE RIDDLE  
Phone .....(316) 356-3026.....

Field Name.....Hugoton-Infill.....

Contractor: License # .....5987.....  
Name Service Drilling Co.

Producing Formation.....Chase.....

Wellsite Geologist.....  
Phone.....

Elevation: Ground.....3099'.....KB.....3107'.....

Designate Type of Completion  
 New Well  Re-Entry  Workover

Section Plat

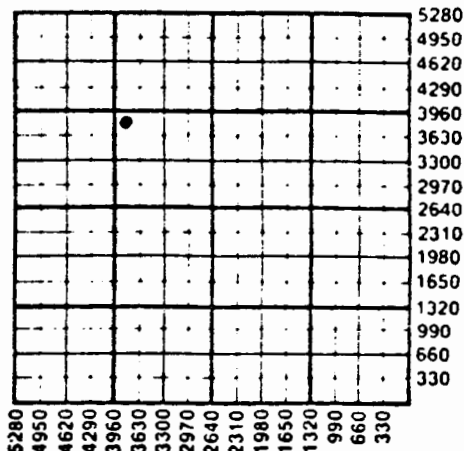

Oil  SWD  Temp Abd  
 Gas  Inj  Delayed Comp.  
 Dry  Other (Core, Water Supply etc.)

If OWN: old well info as follows:  
Operator .....,  
Well Name .....,  
Comp. Date ....., Old Total Depth.....

WATER SUPPLY INFORMATION

Disposition of Produced Water:  Disposal  
Docket # .....NA.....  Repressuring

WELL HISTORY

Drilling Method:  
 Mud Rotary  Air Rotary  Cable

2/8/87 ..... 2/12/87 ..... 3/23/87 .....  
Spud Date Date Reached TD Completion Date

3050' ..... 2965' .....  
Total Depth PBTD

Amount of Surface Pipe Set and Cemented at 630' feet  
Multiple Stage Cementing Collar Used?  Yes  No  
If yes, show depth set.....feet  
If alternate 2 completion, cement circulated  
from.....feet depth to.....w/.....SX cmt  
Cement Company Name .....,  
Invoice # .....

Questions on this portion of the ACO-1 call:  
Water Resources Board (913) 296-3717  
Source of Water:  
Division of Water Resources Permit #.....  
 Groundwater.....Ft North from Southeast Corner  
(Well) .....Ft West from Southeast Corner of  
Sec Twp Rge East West  
 Surface Water.....Ft North from Southeast Corner  
(Stream, pond etc).....Ft West from Southeast Corner  
Sec Twp Rge East West  
 Other (explain).....Latham Water Service  
(purchased from city P.W.D. #)

	Oil	Gas	Water	Gas-Oil Ratio	Gravity
Estimated Production Per 24 Hours	-- Bbls	1760 MCF	-- Bbls	-- CFPB	--

METHOD OF COMPLETION

Production Interval

Disposition of gas:  Vented

Open Hole  Perforation

2500' - 2830'

I, the undersigned, being duly sworn, depose and say that the above information is true and correct to the best of my knowledge.

**SIDE TWO**

Operator Name **MESA OPERATING LIMITED PARTNERSHIP** Lease Name **WHEATLEY** Well # **3-16**

Sec. **16** Twp. **31S** Rge. **37**  East  West County **Stevens**

**WELL LOG**

**INSTRUCTIONS: Show important tops and base of formations penetrated. Detail all cores. Report all drill stem tests giving interval tested, time tool open and closed, flowing and shut-in pressures, whether shut-in pressure reached static level, hydrostatic pressures, bottom hole temperature, fluid recovery, and flow rates if gas to surface during test. Attach extra sheet if more space is needed. Attach copy of log.**

Drill Stem Tests Taken  Yes  No  
 Samples Sent to Geological Survey  Yes  No  
 Cores Taken  Yes  No

Formation Description  
 Log  Sample

Name	Top	Bottom
Stone Corral	1704'	
Wellington	2281'	
Chase	2499'	
Council Grove	2831'	

**CASING RECORD**  New  Used

Report all strings set-conductor, surface, intermediate, production, etc.

Purpose of String	Size Hole Drilled	Size Casing Set (in O.D.)	Weight Lbs/Ft.	Setting Depth	Type of Cement	#Sacks Used	Type and Percent Additives
Surface	12 1/4"	8 5/8"	24#	630'	C	275	3% CaCl
Production	7 7/8"	5 1/2"	15.5#	3049'	C/H	460	5% Kcl

**PERFORATION RECORD**

**Acid, Fracture, Shot, Cement Squeeze Record**

Shots Per Foot	Specify Footage of Each Interval Perforated	(Amount and Kind of Material Used)	Depth
1 JS/2'	2500'-2830'	7900 gals 15% Hcl 100,000 gals x-linked gel + 250,000# 12/20 sand	2500'-2830'

TUBING RECORD	Size	Set At	Packer at	Liner Run	<input type="checkbox"/> Yes <input checked="" type="checkbox"/> No
	NA				

Date of First Production | Producing Method  
 Not Connected |  Flowing  Pumping  Gas Lift  Other (explain).....

**PLAT AND CERTIFICATION OF ACREAGE ATTRIBUTABLE TO A GAS WELL**

CG-8

State Corporation Commission, Conservation Division  
200 Colorado Derby Bldg. Wichita, Kansas 67202

OPERATOR MESA OPERATING LIMITED PARTNERSHIP LOCATION OF WELL

LEASE WHEATLEY

3935 feet from the South line  
3800 feet from the East line  
Of the NW/4 of Sec. 16 T. 31S R. 37W

WELL NUMBER #3-16

FIELD HUGOTON

COUNTY Stevens

ORDER GRANTING ALLOWABLE ENTERED IN DOCKET NO. 153,713-C (C-22,307)

NUMBER OF ACRES  
ATTRIBUTABLE TO WELL 640

DESCRIPTION OF ACREAGE:

**PLAT**

(Show location of Well and outline attributable acreage)

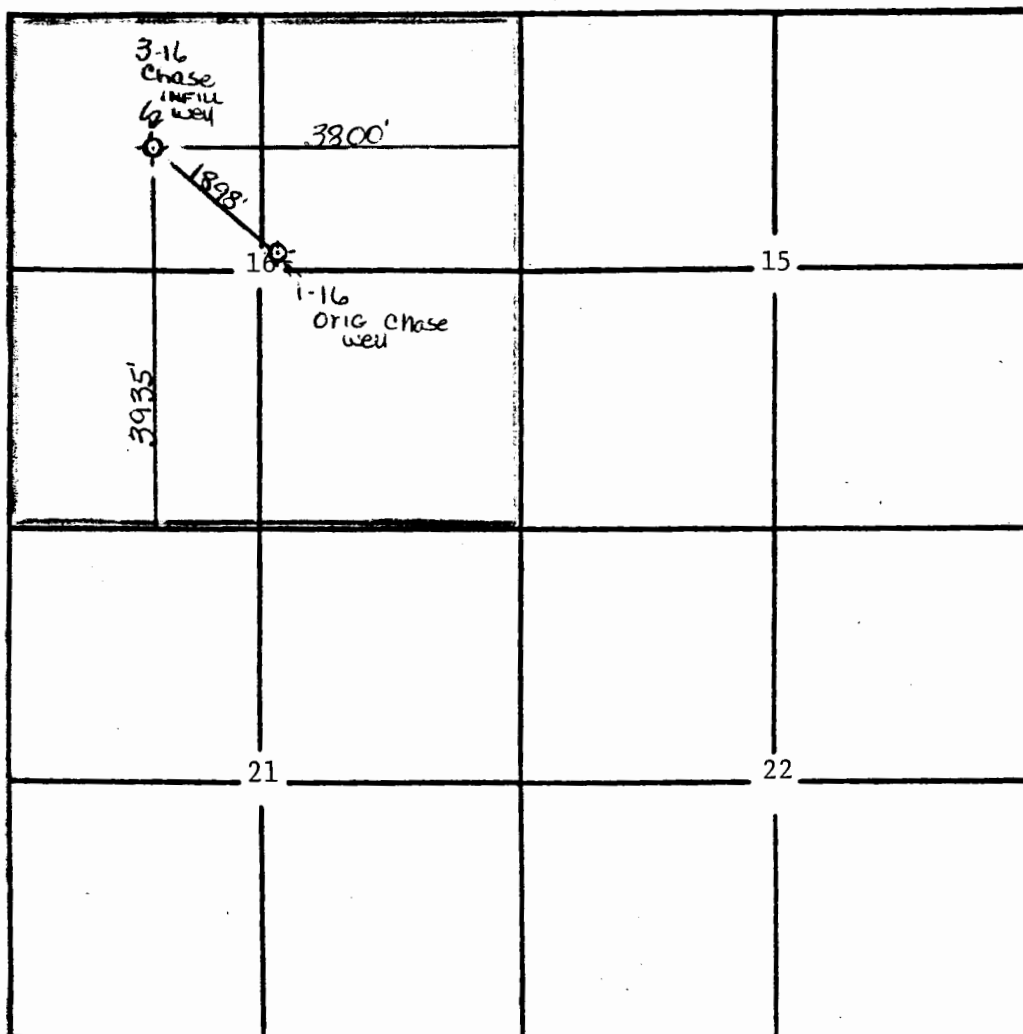

The undersigned hereby certifies that he is Regulatory Analyst  
for Mesa Operating Limited Partnership, a duly authorized agent, that all information shown hereon is true and correct to the best of his knowledge and belief, and that all acreage claimed as attributable to the well named herein is held by