

STATE CORPORATION COMMISSION OF KANSAS  
OIL & GAS CONSERVATION DIVISION

WELL COMPLETION OR RECOMPLETION FORM  
ACO-1 WELL HISTORY

DESCRIPTION OF WELL AND LEASE

Operator: License # ...8000.....  
Name ... PANCANADIAN PETROLEUM COMPANY.  
Address ... 600 Seventeenth St. Ste. 1800  
City/State/Zip ... Denver, CO 80202

Purchaser: TEXACO TRADING AND TRANSPORTATION  
P. O. Box 5709  
Enid, OK 73702

Operator Contact Person ... Jim Keisling/Glen Jameson  
Phone ... (303) 825-8371

Contractor: License # ...5840.....  
Name ... BRANDT DRILLING COMPANY, INC.

Wellsite Geologist ... Gary Penley  
Phone ... (303) 825-8371

Designate Type of Completion

- New Well     Re-Entry     Workover  
 Oil     SWD     Temp Abd  
 Gas     Inj     Delayed Comp.  
 Dry     Other (Core, Water Supply etc.)

If **OWWO**: old well info as follows:

Operator .....  
Well Name .....  
Comp. Date ..... Old Total Depth.....

WELL HISTORY

Drilling Method:

- Mud Rotary     Air Rotary     Cable

..11-25-84...    ..12-06-84....    ..03-05-85....  
Spud Date    Date Reached TD    Completion Date  
..4749'.....    ..3750'.....  
Total Depth    PBTD

Amount of Surface Pipe Set and Cemented at 278 feet  
Multiple Stage Cementing Collar Used?  Yes  No  
If yes, show depth set.....feet  
If alternate 2 completion, cement circulated  
from.....feet depth to.....w/.....SX cmt

SIDE ONE

API NO. 15-077-21-052.....  
County... Harper.....  
..... NW SE Sec. 28 Twp. 31S Rge. 5W  East  West

..1550'.... Ft North from Southeast Corner of Section  
..1550'.... Ft West from Southeast Corner of Section  
(Note: Locate well in section plat below)

Lease Name... Heibert Trust 33-28... Well #... 1.....

Field Name... Gerber.....

Producing Formation... Middle KC (SWOPE).....

Elevation: Ground... 1340'..... KB... 1347'.....

Section Plat

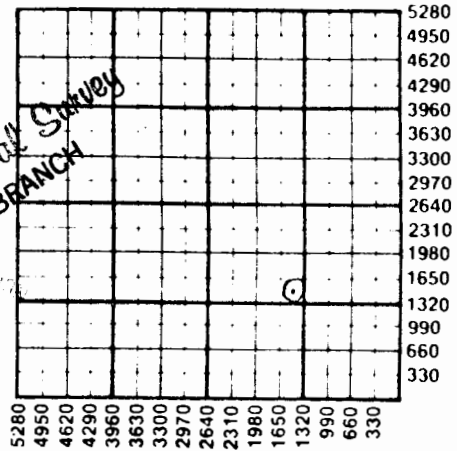

MAY 13 1985  
STATE GEOLOGICAL SURVEY  
WICHITA BRANCH

WATER SUPPLY INFORMATION

Disposition of Produced Water:  Disposal  Repressuring  
Docket # .....

Questions on this portion of the ACO-1 call:

Water Resources Board (913) 296-3717

Source of Water:  
Division of Water Resources Permit #... T85-366.....

Groundwater 1620' Ft North from Southeast Corner  
(Well) ..1620' Ft West from Southeast Corner of  
Sec Twp Rge  East  West

Surface Water.....Ft North from Southeast Corner  
(Stream, pond etc).....Ft West from Southeast Corner  
Sec Twp Rge  East  West

Other (explain).....  
(purchased from city, R.W.D. #)

INSTRUCTIONS: This form shall be completed in duplicate and filed with the Kansas Corporation Commission, 200 Colorado Derby Building, Wichita, Kansas 67202, within 90 days after completion or recompletion of any well. Rule 82-3-130 and 82-3-107 apply.

Information on side two of this form will be held confidential for a period of 12 months if requested in writing and submitted with the form. See rule 82-3-107 for confidentiality in excess of 12 months.

One copy of all wireline logs and drillers time log shall be attached with this form. Submit CP-4 form with all plugged wells. Submit CP-111 form with all temporarily abandoned wells.

SIDE TWO

Operator Name PANCANADIAN PETROLEUM COMPANY Lease Name Heibert Trust 33-28 Well # 1

Sec. 28 Twp. 31S Rge. 5W  East  West County Harper

WELL LOG

INSTRUCTIONS: Show important tops and base of formations penetrated. Detail all cores. Report all drill stem tests giving interval tested, time tool open and closed, flowing and shut-in pressures, whether shut-in pressure reached static level, hydrostatic pressures, bottom hole temperature, fluid recovery, and flow rates if gas to surface during test. Attach extra sheet if more space is needed. Attach copy of log.

Drill Stem Tests Taken  Yes  No  
 Samples Sent to Geological Survey  Yes  No  
 Cores Taken  Yes  No

Formation Description  
 Log  Sample

DST #1: 3604'-3592': 15-45-45-90  
 PF: 111 psi-174 psi. Good blow throughout.  
 ISIP: 1121 psi. FFP: 242 psi-401 psi. Good blow. NGTS. FSIP: 1011 psi. Rec 180' (1.2 bbl) HGCO & 720' (10.2 bbl) SW.

DST #2: 3720'-3734': 15-45-45-90  
 IFP: 69 psi-53 psi. Good blow throughout. GTS in 1 min @ 12 MCFPD. ISIP: 1552 psi. FFP: 116 psi-140 psi. Good blow throughout. 13 MCFPD. FSIP: 1542 psi. Rec. 270' (1.8 bbl) oil & 90' (0.6 bbl) SW.

DST #3: 3774'-3762': 15-45-45-90  
 IFP: 76 psi-80 psi. Weak blow, increased to fair; NGTS. ISIP: 1202 psi. FFP: 148 psi-190 psi. Weak blow, decreased to very weak blow. NGTS. FSIP: 1257 psi. Rec. 90' (0.6 bbl) O & GCM, 360' (2.4 bbl) SW.

Name	Top	Bottom
Heebner	2992'	2994'
Stalnaker	3310'	3413'
Kansas City	3581'	3808'
Marmaton	3885'	4053'
Mississippian	4216'	4570'
Simpson	4676'	Did not penetrate

MAY 13 1985  
 State Geological Survey  
 WICHITA BRANCH

CASING RECORD <input type="checkbox"/> New <input type="checkbox"/> Used							
Report all strings set-conductor, surface, intermediate, production, etc.							
Purpose of String	Size Hole Drilled	Size Casing Set (in O.D.)	Weight Lbs/Ft.	Setting Depth	Type of Cement	#Sacks Used	Type and Percent Additives
Surface	12 1/4"	8-5/8"	24	278	Common	175	3% CaCl 2% Gel
Production	7-7/8"	4 1/2"	9.5	3907	50/50 A-Poz	75	2% Gcl, 18% Salt, 0.75% CFR-2, 10# /sk Gilsomite
PERFORATION RECORD				Acid, Fracture, Shot, Cement Squeeze Record (Amount and Kind of Material Used)   Depth			
Shots Per Foot	Specify Footage of Each Interval Perforated						
2	3761'-3767'			1250 Gel 15% Mud Acid squeeze w/43 sx "A" PBTD=3750'			same
2	3721'-3726'			30 bbl 15% Mud Acid			same
TUBING RECORD				Liner Run <input type="checkbox"/> Yes <input checked="" type="checkbox"/> No			
Size Set At		Packer at					
2-3/8"		3748'		None			
Date of First Production		Producing Method					
March 5, 1985		<input type="checkbox"/> Flowing <input checked="" type="checkbox"/> Pumping <input type="checkbox"/> Gas Lift <input type="checkbox"/> Other (explain).....					